

Existing Ground Floor Plan
Scale: 1:50 @ A1 Scale

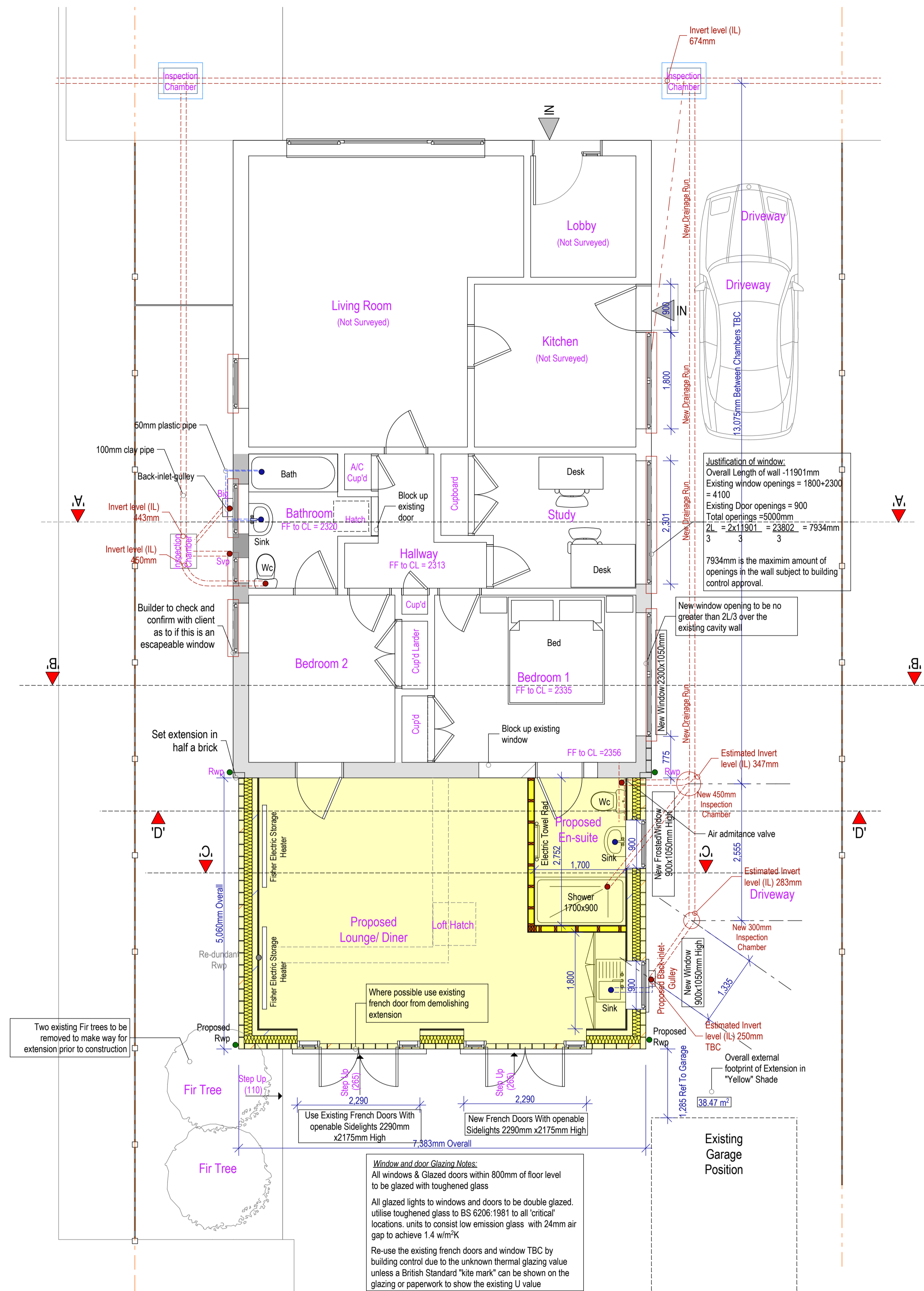

Proposed Ground Floor Plan
Scale: 1:50 @ A1 Scale

PL1 19.10.22 : Drawing update as per comments from meeting in September : mnl
PL0 04.07.22 : Issued to client for approval : mnl

MNL DESIGNS LTD
5 Heather Close Thurston Bury St. Edmunds Suffolk IP31 3PX **tele:** 01359 232507 **Mo:** 07827 683 702 **e:** lewisnm521@gmail.com

client: **Mr. Ray Goldsmith & Mrs. Julie Cole**
job: 14 Church Close Hepworth Bury St Edmunds Suffolk IP22 2QF
drawing: Existing & Proposed Floor Plans of the Property

PL3 07.11.22 : Drawing updated as per comment sheet from Ray : mnl
PL2 31.10.22 : Drawing updated : Loft Hatch Added/ Sidelight added to french doors : mnl

scale: as shown date: 07/11/22 dim.: mnl job no.: MNL412 dng. no.: 03 rev.: PL3