

Current First Floor

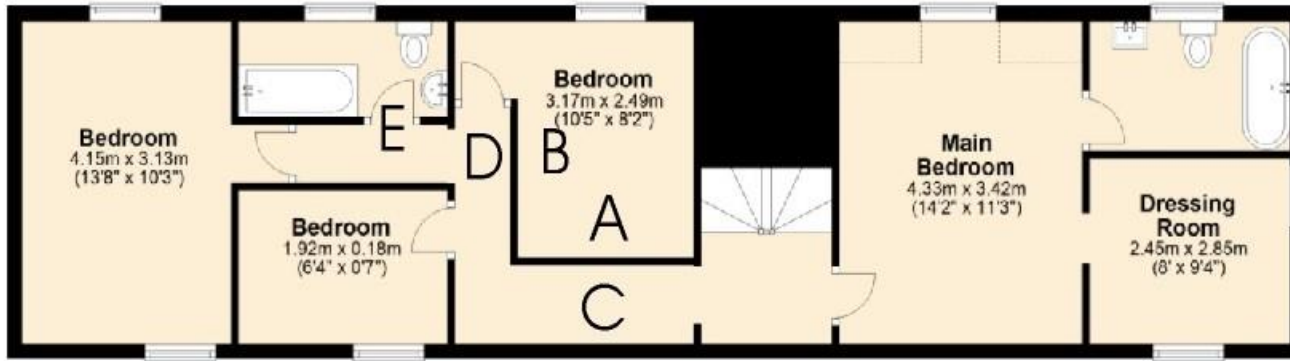

Application to remove stud partitions added to property in 1996.

Applicant ; Mark Sheppard
Address: 20-21 Snow Street
Roydon IP225SB

View of wall A and B.



View of wall C.
Plasterboard over studs
softwood trim



View of wall D.
Plasterboard over studs
softwood trim



View of wall E.
Plasterboard over studs

