

PROPOSED JUNCTION IMPROVEMENTS AND VISIBILITY SPLAY ASSESSMENT

1 : 500

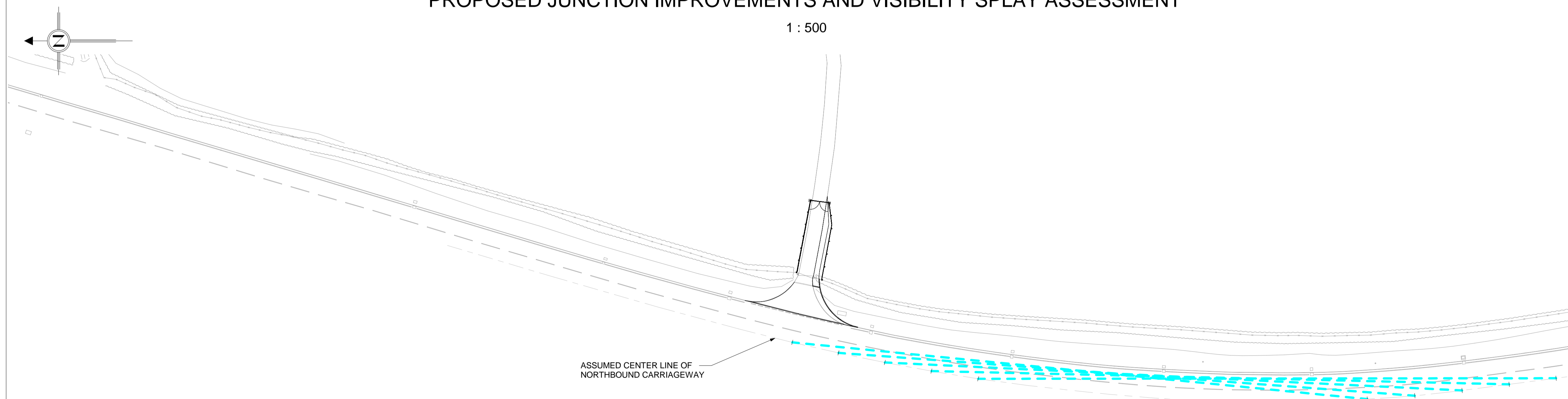

A490 NORTHBOUND CARRIAGEWAY FORWARD VISIBILITY CORD ASSESSMENT

1 : 500

DO NOT SCALE
USE WRITTEN DIMENSIONS ONLY

HEALTH & SAFETY

SITE HAZARDS

NOTES:

- UNLESS NOTED OTHERWISE, ALL DIMENSIONS ARE IN MILLIMETERS AND ALL LEVELS ARE IN METERS ABOVE ORDNANCE SURVEY DATUM (NEWLYN).
- SSD VALUES ARE BASED ON DEPARTMENT FOR TRANSPORT MANUAL FOR STREETS RECOMMENDED VALUES OF $t = 1.5s$, $d = 4.41 m/s^2$. THE A490 IS A 60 mph HIGHWAY IN THIS LOCATION, GIVING A SSD = 122 m.
- THIS DRAWING IS BASED ON THE TETRA TECH TOPOGRAPHICAL SURVEY DRAWINGS, REV B, DATED 07/11/21.

LEGEND

--- 122m VISIBILITY SIGHT LINE

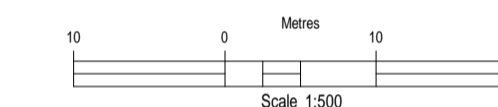

Pell Frischmann

PENINSULA PARK RYDON LANE EXETER EX2 7NT

Tel: +44(0) 1392 444345 Fax: +44(0) 1392 444880

Email: pfxeter@pellfrischmann.com

www.pellfrischmann.com



PROJECT TITLE

CHURCH STOKE STW
AMP 7 Q WFD - OUTLINE DESIGN

DRAWING TITLE

PLANNING DRAWING
JUNCTION IMPROVEMENTS & VISIBILITY
ASSESSMENTS

DRAWING NO:

H7S00101-PFC-XX-ZZ-DR-T-0008

SCALE:

1:500

SHEET SIZE

A1

QR CODE
PLACEMENT

THIS DRAWING IS CONFIDENTIAL AND THE
PROPERTY OF SEVERN TRENT AND MUST NOT BE
REPRODUCED WITHOUT WRITTEN PERMISSION