

Client Name : Mr & Mrs B Polley			
Project Title : New Cottage, Dunmow Road, Leaden Roding, Dunmow, Essex, CM6 1QA			
Drawing Name : Existing Site Plan			
Scale : 1:200 @ A3	Drawn/Checked: AS/JRF	Status : Application	Rev : -
Date : 28 October 2022	Plot Date : 07 December 2022 14:13:16	Dwg No : 22.7720/E101	

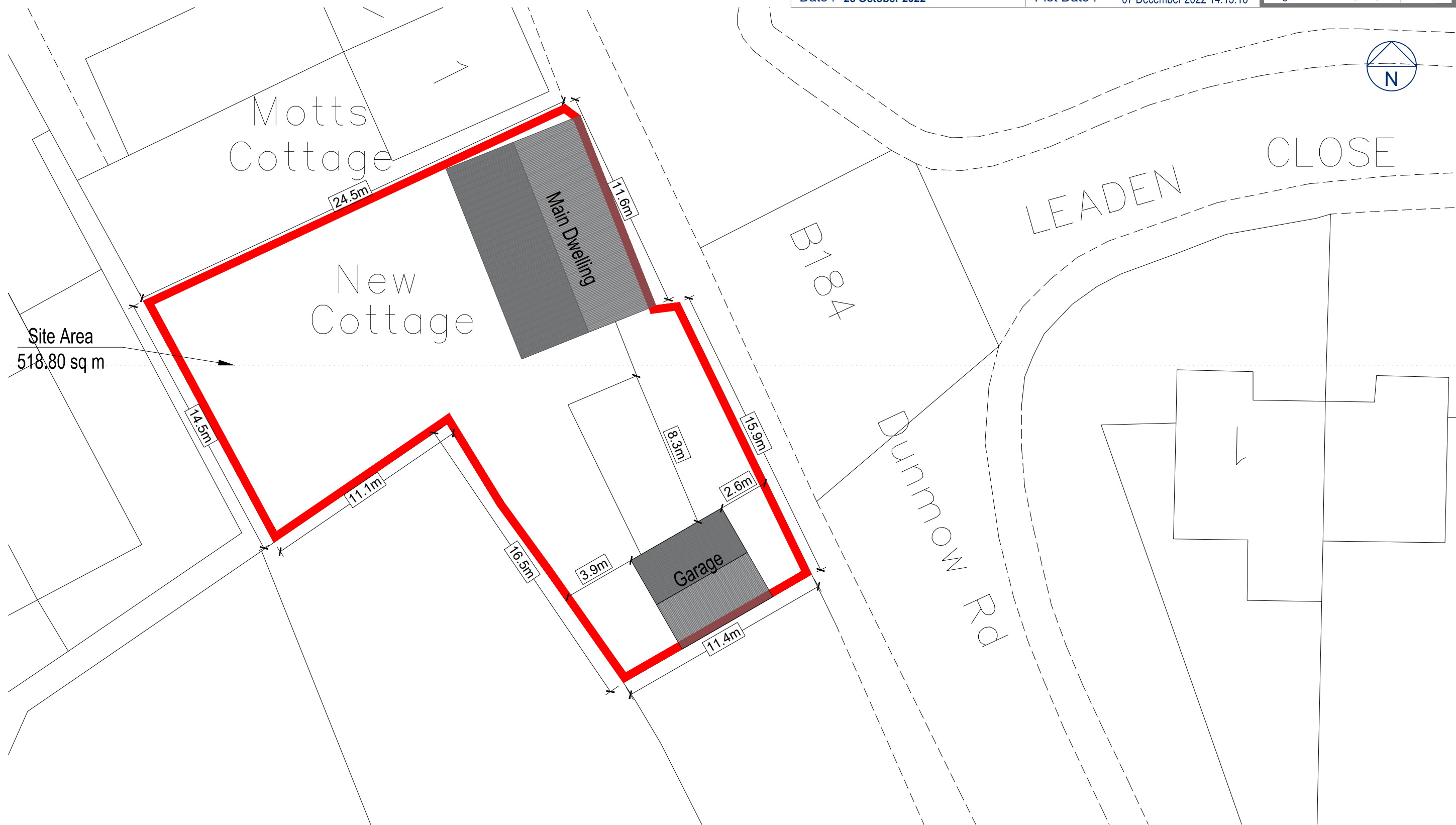

Note:
 The dimensions of the building hereby submitted are as a result of a third party survey and therefore Smart Planning Ltd accepts no responsibility for any discrepancies that may arise. All dimensions should be checked on site before the commencement of any works or ordering of materials. Any discrepancies should be reported to Smart Planning Ltd.



No.	Date	Amendment	Initials

© THIS DRAWING IS THE COPYRIGHT OF SMARTPLANNING. This document must not be reproduced in whole or in part without prior permission of Smartplanning Ltd. Registered in England No. 04369649. OS Licence Number 100042413



Head Office
 Old School House, Rettendon
 Turnpike, Battlesbridge,
 Essex, SS11 7QL

Email contact@smartplanning.co.uk
 Website www.smartplanning.co.uk
 Phone 0330 053 6811