

Existing Floor Plans

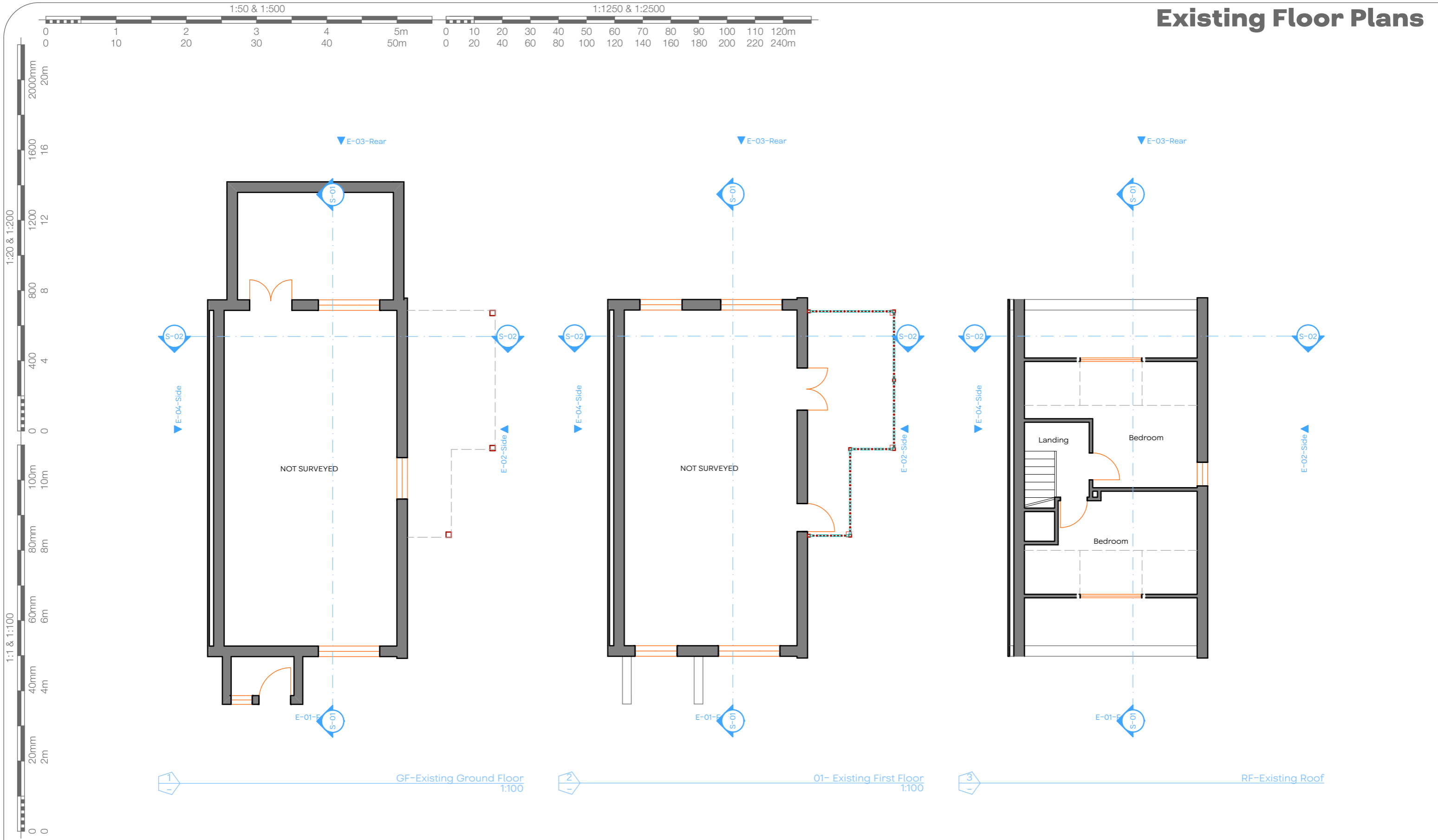

1 GF-Existing Ground Floor 1:100 2 01- Existing First Floor 1:100 3 RF-Existing Roof

JOHN CHILDS ARCHITECTURAL DESIGN

Address :- 59 Heath Road, Langley, Maidstone, Kent	Scale :- As Marked	Date :- October 2022	Drawing No. :- P.01	Revision Notes :-
Project :- Enlarge dormer to the front elevation	Paper Size :- A3	Drawn by :- JLRC	Revision No :-	