

Drawing No MH- Rose Cottage 01/12/22 Proposed Additional Access/Exit

No unbound material shall be used in the surface treatment of the vehicular access within 6.0m of the highway boundary.

The vehicular access shall be constructed at right angles to the highway, shall not be less than 3.6m wide and shall be provided with an appropriate dropped kerb crossing at the highway verge.

The vehicular access to be constructed to a suitable chamber and gradient to prevent surface water discharging onto the highway

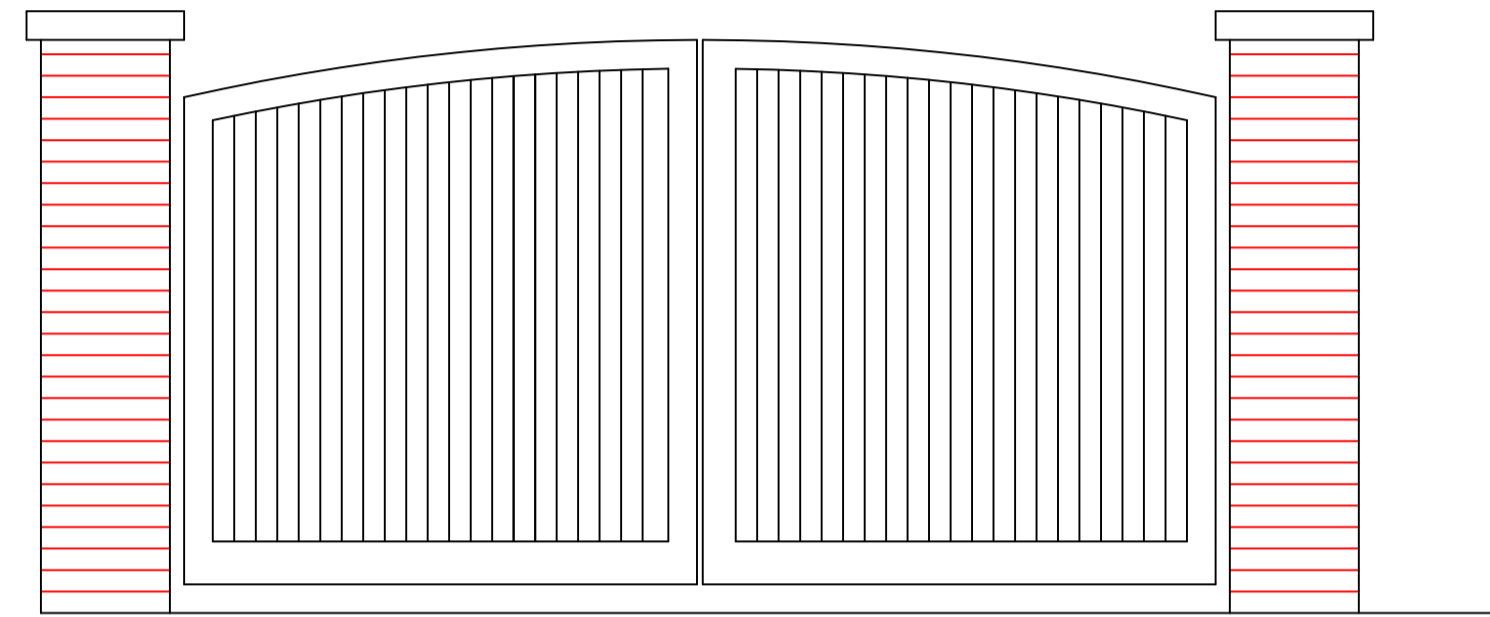

2.0M HIGH X 3.6M WIDE TIMBER VEHICLE GATES  
ELEVATION OF PROPOSED ENTRANCE GATES 1:50

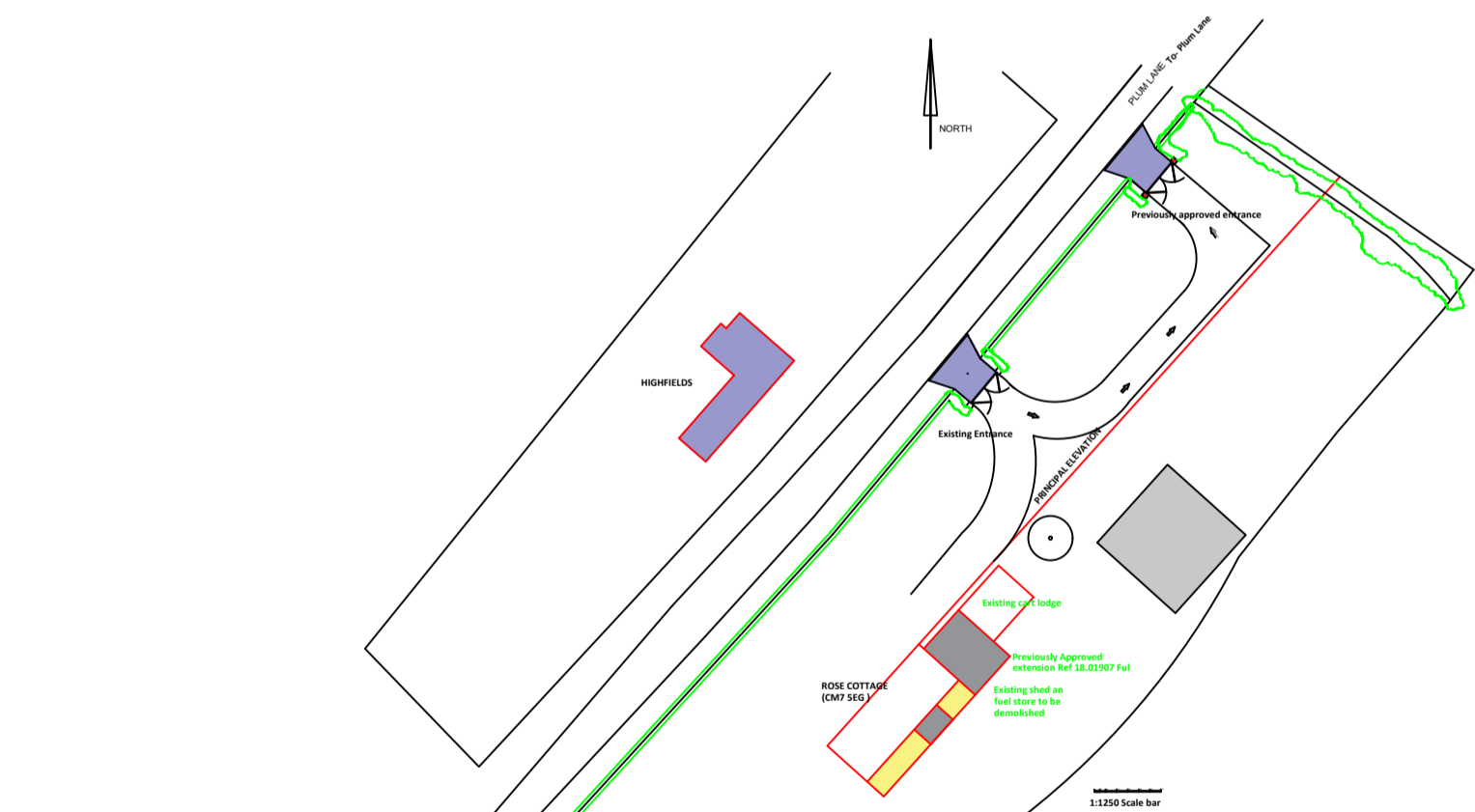

Location Plan - Rose Cottage, Plum lane  
Bardford Saling. Braintree CM7 5EG

Scale 1:1250

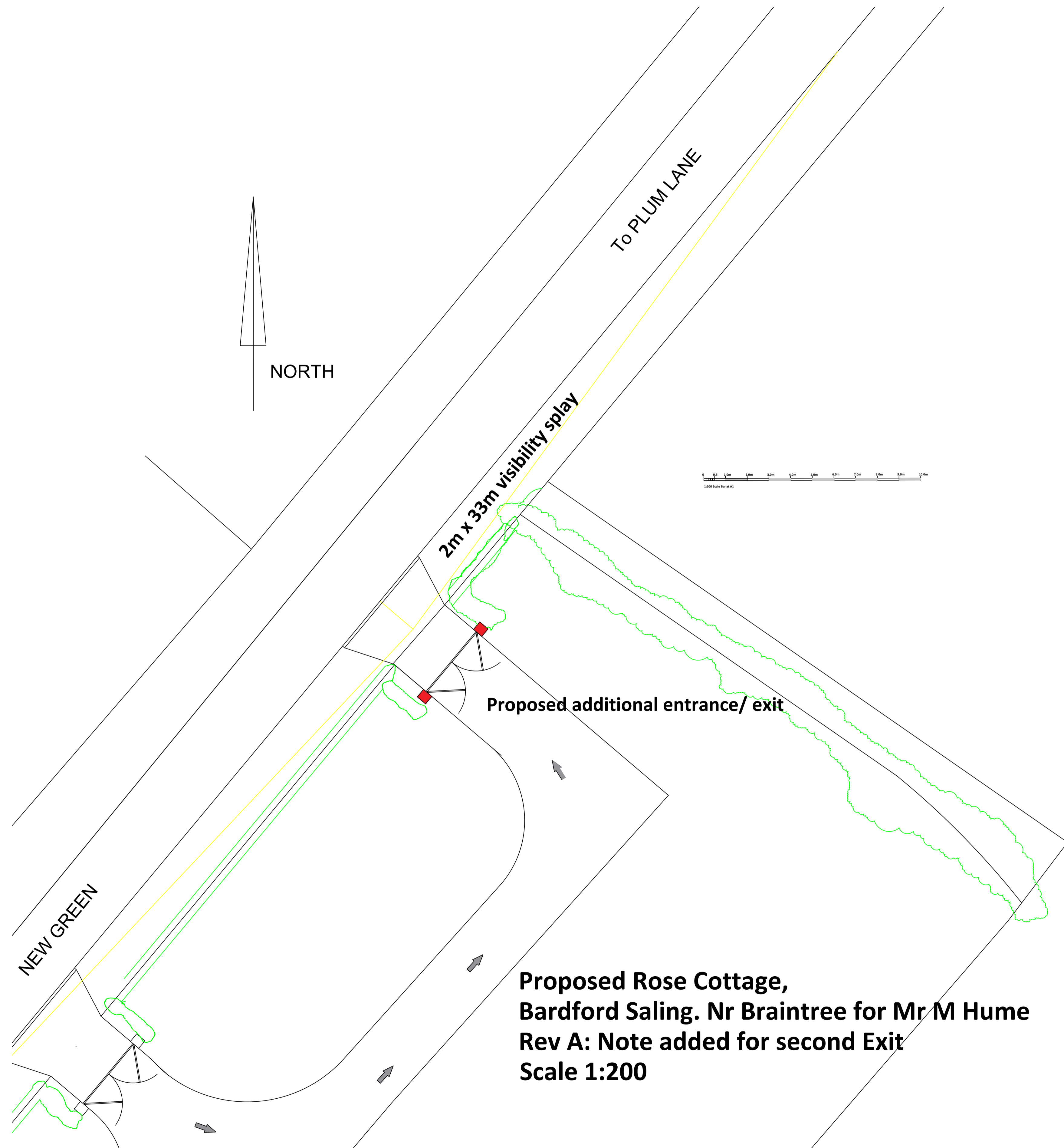

Proposed Rose Cottage,  
Bardford Saling. Nr Braintree for Mr M Hume  
Rev A: Note added for second Exit  
Scale 1:200