

All new underground drain runs to be 110mm UPVC laid min 1:40 fall and surrounded in 150mm min pea gravel, and a min 50mm concrete haunching provided over pipes less than 450mm below ground level.

EXISTING DRAIN ROUTES TO BE VERIFIED PRIOR TO COMMENCEMENT OF WORKS

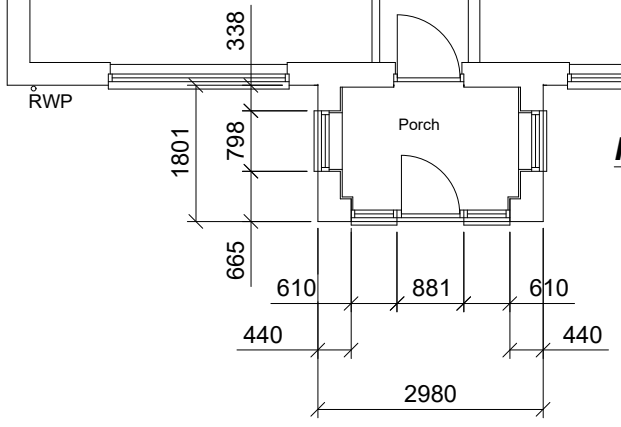

PROPOSED GROUND FLOOR PLAN

New RWP to be positioned as shown and connected to existing main SW drain. All works to be to the satisfaction of the LA Building Control Officer.

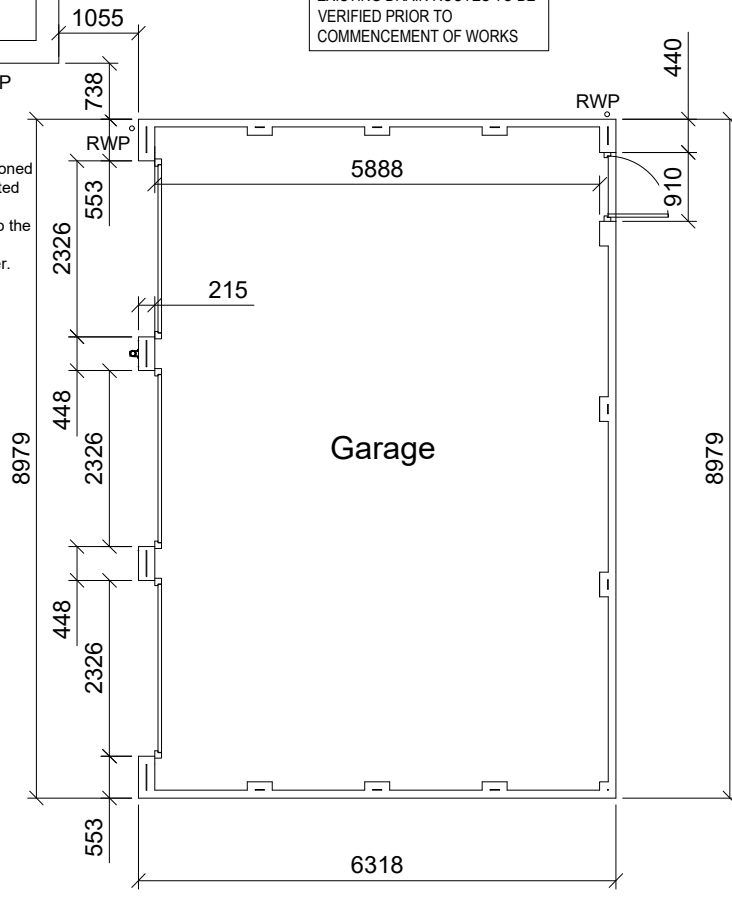

Rev.	Revision Note	Date
	Proposed alterations to West View Station Road End Stannington - NE61 6DL	Scale 1:100 Date 14.09.22
	Title Proposed Ground Floor Plan	Sheet No. 005