

Topographical Survey provide by others.

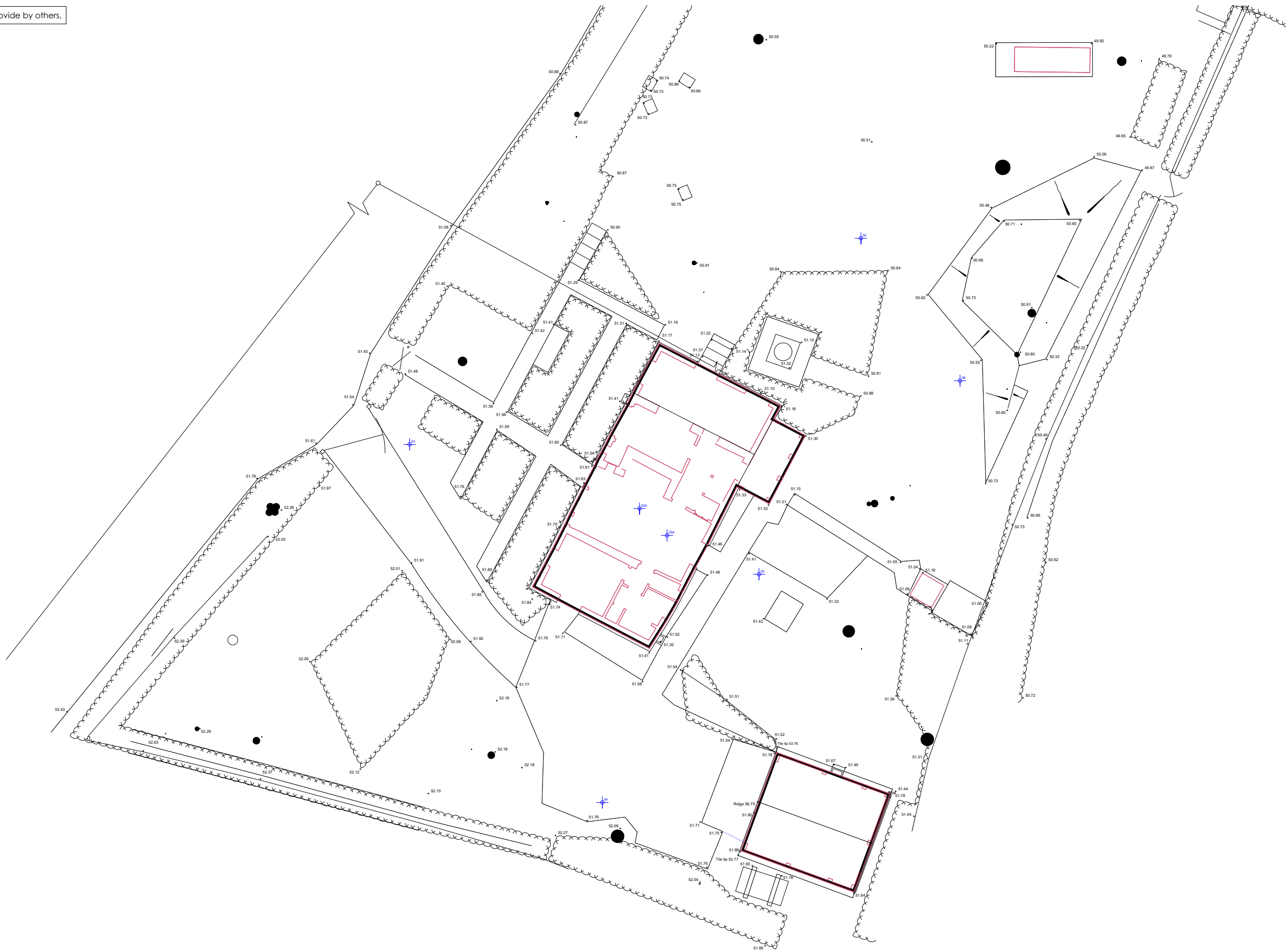

Rev.	Description	Date	Chkd.
------	-------------	------	-------

DO NOT SCALE FROM THIS DRAWING. THE CONTRACTOR SHALL CHECK AND VERIFY ALL DIMENSIONS ON SITE AND REPORT DISCREPANCIES IN WRITING TO LS ARCHITECTURE BEFORE PROCEEDING WORK. ALL DIMENSIONS IN MILLIMETERS UNLESS OTHERWISE STATED. DRAWING STATUS AS INDICATED BELOW.

© COPYRIGHT. THE COPYRIGHT IN THIS DRAWING IS VESTED IN LS ARCHITECTURE. AND NO LICENSE OR ASSIGNMENT OF ANY KIND HAS BEEN, OR IS, GRANTED TO ANY THIRD PARTY WHETHER BY PROVISION OF COPIES OR ORIGINALS OR OTHERWISE UNLESS AGREED IN WRITING.

**Client:**  
Mr & Mrs Ray

**Project:**  
Proposed single storey side & two storey rear extensions following demolition of existing rear extension.

**Address:**  
Crooked Cottage  
Bethel Row, Throwley  
Faversham  
ME13 0JR

**Drawing Title:**  
Existing Site Topographical Survey

Drawn By :  
Date : December 2022      Scale: 1:200@A3

**Luke Strange Ltd**  
Architectural Design  
Email: lukestrange@yahoo.co.uk  
Tel: 07849 770525

**Drawing No:** 546\_02      **Rev:**



**Existing Site Topographical Survey**  
Scale: 1:200@A3

