

HERITAGE STATEMENT

for

The Proposed Works

to

**OLD CHAPEL, HEMINGBY,
HORNCastle, LINCOLNSHIRE**

Job Ref. No: 2348

Date of Report: December 2022

SCORER HAWKINS ARCHITECTS

Lodge Farm Barns, Skendleby, Spilsby, Lincolnshire, PE23 4QF
01754 890089 | projects@scorerhawkins.co.uk

CONTENTS

1.0 PRELIMINARY INFORMATION

2.0 PHOTOGRAPHIC RECORD

REFERENCES

1.0 PRELIMINARY INFORMATION



Figure 1: Present day view of Old Chapel, Hemingby

1.1 OVERVIEW

History: Old Chapel, Hemingby was originally built as a chapel in 1857 and served as such until it closed in 1977. It has since been converted to a private residence.

Proposal: This application seeks approval to install a new air-source heat-pump, discretely located to the rear yard of the property.

1.2 LOCATION

Address: Old Chapel
Hemingby
Lincolnshire
LN9 5QG

District: East Lindsey District Council

Grid Reference: TF 23827 74619

1.3 SIGNIFICANCE

Period: Victorian

Protected Status: Grade II Listed Building.

List Entry Number: 1360002

Date First Listed: 25.03.1987

Listing Description: *Wesleyan Methodist chapel. 1859. Red brick, some painted ashlar. Overhanging slate roof. Single storey, 4 bay south front with doorway in gabled brick porch to right. Pointed doorway with ashlar quoins, moulded brick porch to right. Pointed doorway with ashlar quoins, moulded brick hood mould and label stops and double plank door. Plaque above inscribed "Wesleyan Methodist Chapel 1859". 2 windows to the left, single window to the right, all with pointed heads with intersecting tracery and glazing bar sashes. West front with single pointed window with glazing bars and intersecting tracery. East front with 2 pointed windows with glazing bars and intersecting tracery. All the windows with painted ashlar quoins and moulded brick hood moulds with label stops.*

LHE Description: *A Wesleyan Methodist chapel built in 1859 from red brick and some painted ashlar. It has an overhanging slate roof. The chapel was built in 1859, to replace an earlier chapel, and closed in 1977.*

Pevsner Entry: *Built in 1859, but still Gothick.*

Heritage at Risk: The building is not listed on the Heritage at Risk Register.

Setting: There are a total of six Listed Buildings in Hemingby, all of which are Grade II. These include:

- The Rookery (List Entry: 1307116)
- Almshouses (List Entry: 1062997)
- The Coach House at the Old Rectory (List Entry: 1252288)
- The Old Rectory (List Entry: 1262362)
- Church of St. Margaret (List Entry: 1307152)

2.0 PHOTOGRAPHIC RECORD

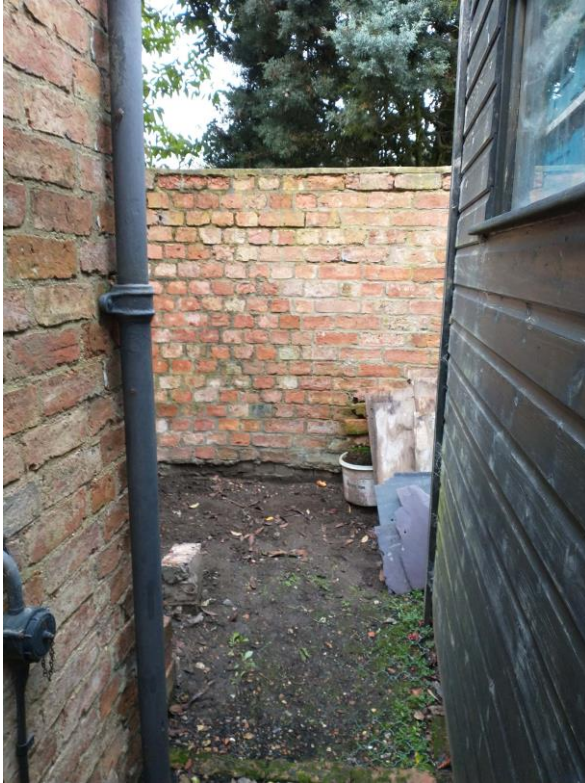

Figure 2: Approach to yard.



Figure 3: Proposed location of heat-pump.

REFERENCES

The following sources were consulted in the preparation of this report:

- Heritage at Risk Register
www.historicengland.org.uk/advice/heritage-at-risk/search-register
- Lincolnshire Heritage Explorer
<https://heritage-explorer.lincolnshire.gov.uk>
- National Heritage List for England
www.historicengland.org.uk/listing/the-list
- Nikolaus Pevsner & John Harris, 1989, *Buildings of England: Lincolnshire (Second Edition)*
- Society of Lincolnshire History & Archaeology