

Detail 3 - Landing / Hallway Elevation

Scale 1:10

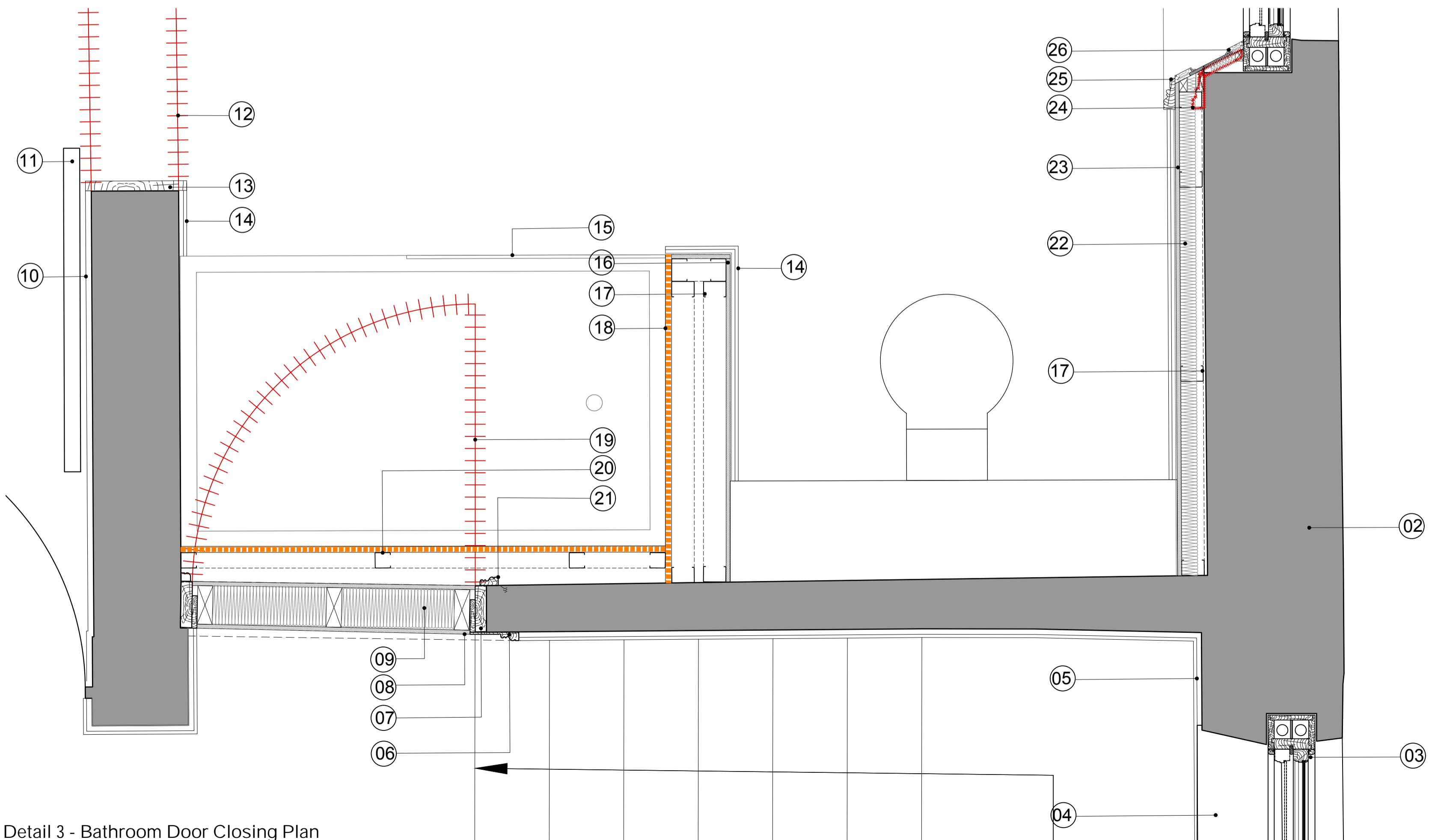

Detail 3 - Bathroom Door Closing Plan

Scale 1:10

- 01 Existing box sash window to be retained.
- 02 Existing rendered masonry wall.
- 03 Timber single glazed westmoreland window, to be replaced due to poor condition.
- 04 Existing painted window board to be retained / carefully removed as part of window replacement works.
- 05 Existing stair stringer and skirting boards to be retained.
- 06 Existing bathroom door architrave to be retained.
- 07 Existing door reveal and rebates to be retained.
- 08 12.5mm Gyproc plasterboard or similar approved lining with 4mm Solo Lime Plaster.
- 09 100x47mm softwood timber studs between existing door opening, provide 100mm full fill mineral wool insulation between studs.
- 10 Existing bedroom to skirting to be retained.
- 11 New timber 6 panel door to match existing on wall mounted roller track.
- 12 Existing wall to be partially demolished to form new opening, new beam over to be provided above, refer to S.E details for further information.
- 13 35 x 315mm painted timber opening reveal panel to newly formed opening. Existing bathroom skirting to be retained. Where new opening is formed, portion of skirting that was present is to be carefully removed and cut back to allow for return end to
- 14
- 15 timber reveal. New shower tray and screen, type and specification to be confirmed with client.
- 16 15mm moisture resistant plasterboard with 4mm Solo Lime Plaster to finish.
- 17 Gypframe 70mm 'C' stud framing fixed to existing floor & ceiling.
- 18 19mm Schluter Kerdi board for tile backing, with Schluter KERDI-SHOWER-SK Waterproofing Kits KSS5/KSS10. Boarding to be installed in strict accordance with manufacturers details prior to receiving tiling / stone.
- 19 Existing 6 panel door to be removed.
- 20 Gypframe 48mm 'C' stud framing fixed to existing floor & ceiling.
- 21 Existing bathroom side, cut architrave to be retained and hidden behind new shower walling to enable the potential for reinstatement of door opening.
- 22 50mm Thermaflex sheep wool insulation to be breathable / hygroscopic placed between studs.
- 23 Existing window surround architrave and paneling to be recorded, and carefully removed.
- 24 Painted replacement architrave, moulding profile to match existing.
- 25 Painted replacement splayed timber paneling, with scotia beading to recess to match existing.
- 26 Existing chamfered edge window board to be removed and replaced to extend to new insulated stud wall.
- 27 Existing timber sash window to be retained.

Detail 03

Scale 1:10 @ A1

*Proposed Bathroom Door Opening Closing up and New Ensuite
Joinery profiles indicative only, final are to be taken from site and recorded, where profiles are to be removed.*

This drawing is ONLY intended to be used for the purpose stated and forms part of a series that is to be read in conjunction with details and specifications and where necessary other consultants information.

Deviating from these drawings without consultation and/or agreement with the employer is unacceptable. This drawing is indicative and exact dimensions should be checked and confirmed on site by the nominated contractor or competent persons prior to commencement of building works, ordering of materials or setting out. Any discrepancies should be reported in advance and in writing to SDA Architecture Ltd. Where in doubt ask, and do not proceed with the works in the event of a drawing discrepancy.

Do not scale from this drawing unless trained to use a scale ruler - only work from written and checked dimensions.

For all structural aspects please refer to Structural Engineers project information and cross reference all drawings, details and calculations with the architectural drawing prior to commencement of building works.

This drawing is the property of SDA Architecture Ltd and copyright reserved by them. This drawing is not to be used, copied or disclosed by or to any unauthorised persons without prior written authorisation consent from SDA Architecture Ltd.

SDA Architecture Ltd is a trading name of Style Design and Architecture Ltd and holds no responsibility or liability for any works carried out on site.

Status:

FOR PLANNING

Project Information:

Client: Warren Kozera & Laura Yardley

Project Title: Proposed Extension & Refurbishment to:

Project Address: Fisher House, Rivington Lane, Bolton, BL6 7SL

Project Stage: 4 - Technical Design

Date of Drawing: 08/12/2022

Drawing Information:

Original Author: SH

Checked by: Drawing Sheet Size: A1 (594 x 841mm)

Drawing Scale: 1:10

Site Area Hectare: -

Extension Area CL (m2): -

Drawing Title:

Detail 03: Proposed Door Blocking Up

Project Number:	Drawing Number:	Revision:
0370	6-02-BR	-

Drawing Registry

Rev.	Date	Description	Author	Checked

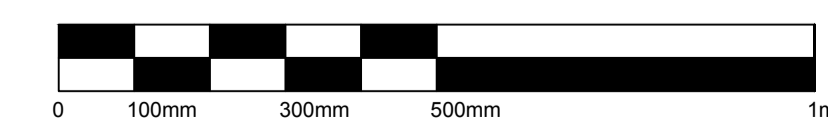

SCALE BAR 1:10



Head Office: Audley House, 39 Queens Road, Chelmsford, Essex, CM1 1JL
Tel: 0201 441512 Web: www.studiopods.co.uk Email: contact@studiopods.co.uk
Company Registration: 03118115 VAT Registration: 967446152
Copyright © 2023 Style Design & Architecture Ltd. All Rights Reserved