

PROPOSED FIRST FLOOR PLAN 1:50

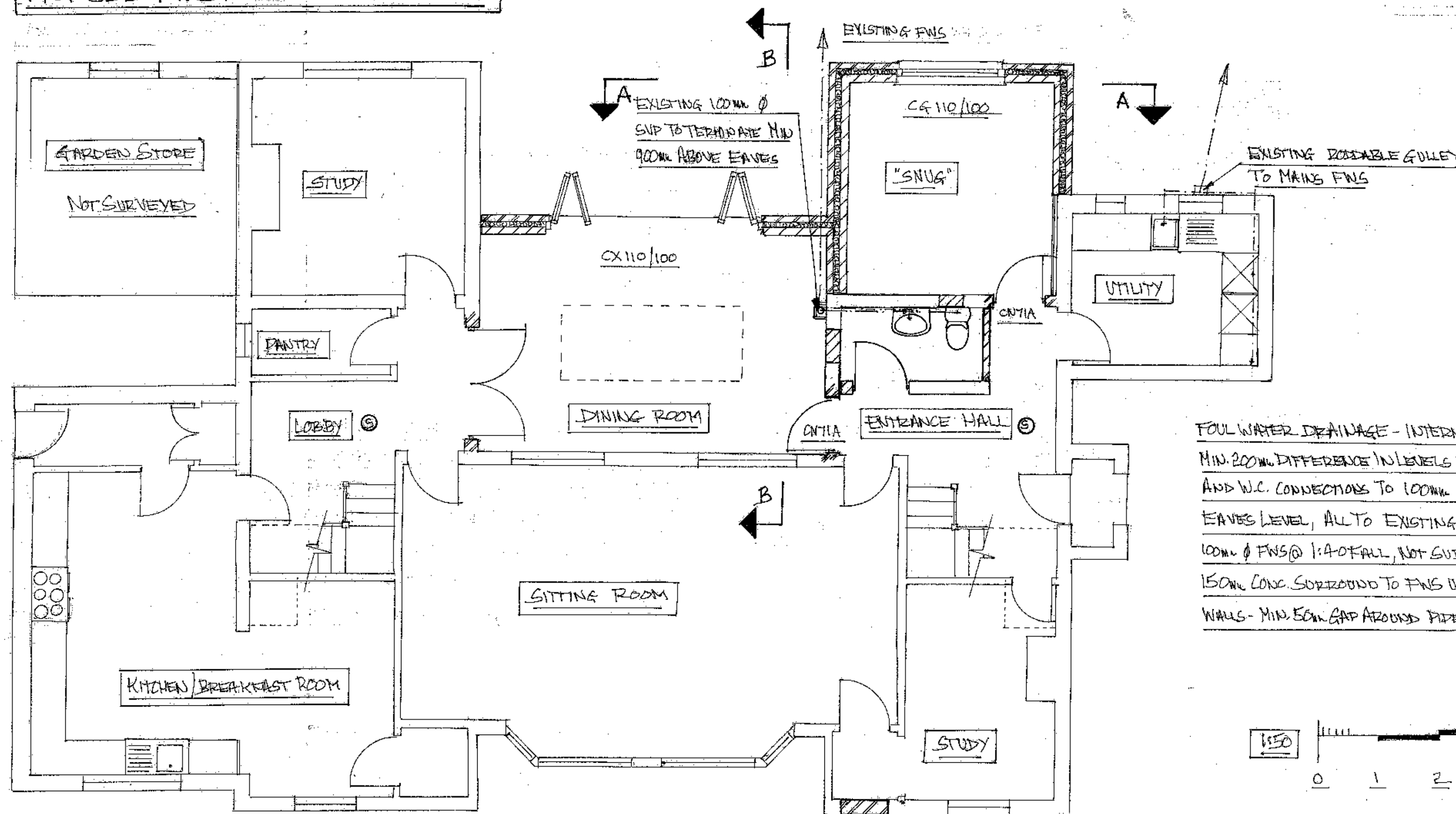

PROPOSED GROUND FLOOR PLAN 1:50

MECHANICAL EXTRACT VENTILATION, TO OUTSIDE ATMOSPHERE, CAPABLE OF 30LITRES/sec TO "UTILITY", AND 15LITRES/sec TO FIRST FLOOR BATHROOM AND GROUND FLOOR W.C., BOTH LINKED TO LIGHT SWITCHES WITH 15min. OVER-RUN - 10mm AIR GAP UNDER DOORS; EXTRACT FANS TO BE LOCATED MAX. 400mm BELOW CEILING LEVELS; MAX. 40dB NOISE OUTPUT

ENERGY EFFICIENT LIGHTING TO ALL "NEW BUILD" - e.g. LEDS, COMPACT FLUORESCENT LAMPS; ANY RECESSED LIGHTING TO BE INTUNESCENT TYPE

⑤ MAINS OPERATED, WITH BATTERY BACKUP, INTERCONNECTED SMOKE DETECTORS

ALL ELECTRICAL WORK TO BE DESIGNED, INSTALLED, INSPECTED AND TESTED BY SUITABLY COMPETENT PERSON WHO SHALL ISSUE TO BCO AND APPLICANT, AN ACCEPTABLE INSTALLATION CERTIFICATE COMPLIANT WITH PART P / BS7671

ADDITIONAL SPACE HEATING VIA THERMOSTATICALLY CONTROLLED RADIATORS CONNECTED TO EXISTING OIL FIRED CENTRAL HEATING SYSTEM

FOUL WATER DRAINAGE - INTERNAL - 50mm Ø WASTES; 75mm DEEP CEILING TRAYS; MIN. 200mm DIFFERENCE IN LEVELS BETWEEN 50mm Ø WASTE CONNECTIONS AND W.C. CONNECTIONS TO 100mm Ø S/WP TERMINATING MIN. 900mm ABOVE EAVES LEVEL, ALL TO EXISTING F/W/S SYSTEM TO MAINS F/W/S VIA 100mm Ø F/W/S @ 1:40 FALL, NOT SUBJECTED TO VEHICLE LOADING; 150mm CONC SURROUND TO F/W/S UNDER FLOOR; LIPSEL OVER THROUGH WALLS - MIN 50mm GAP AROUND PIPE THROUGH WALLS O/U VERMIN PROOF BARRIER

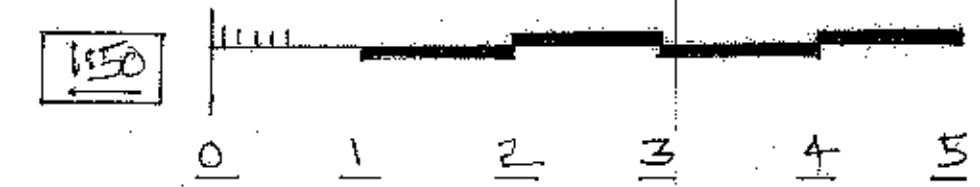

NOTES:-

THIS DRAWING HAS BEEN PRODUCED SOLELY FOR THE PURPOSE OF SUBMISSION OF PLANNING AND BUILDING REGULATIONS APPLICATIONS. IT SHOULD NOT BE CONSTRUED AS BEING A CONSTRUCTION DRAWING.

PROPOSED EXTENSIONS AND ALTERATIONS TO "CHURCH VIEW", CHURCH ROAD, HILGAY, NORFOLK PE38 0TL

DRN:- JOHN STEPHENSON 01366 383715

REVISIONS:-

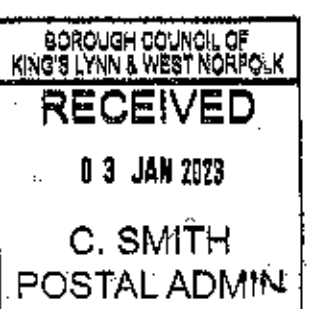

SCALE:- 1:50

DATE:- NOV. 2022

DRG. NO.:- 1717.2