



Front Elevation



Right Elevation



Rear Elevation



Left Elevation

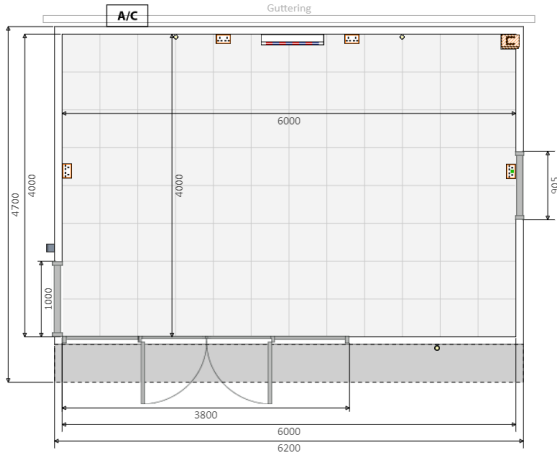

Floor plan

GENERAL CONSTRUCTION

Roof:  
60mm - 80mm of high density polyurethane insulation surrounded by 1mm steel plates

Floor:  
80mm Interlocking steel coated structurally insulated floor panels sit on top of foundation system.

Walls:  
Timber frame (Tanalised) with 50mm of Rockwool insulated cavity incorporating breathable foiled photon wrap.  
Internal plaster board and plaster skim.

Cladding:  
Tanalised shiplap vertical redwood timber cladding to right elevation.  
Tanalised shiplap vertical redwood timber cladding to rear elevation.  
Natural cedar cladding to front elevation.  
Natural cedar cladding to left elevation.

Doors:  
French door/window (3800mm x 2070mm) with Planitherm glass

Windows:  
Large full height window (non-opening) with Planitherm glass  
Lozenge window (905mm x 440mm, Opening: top-hung) with Planitherm glass

Air Conditioning:  
LG Artcool Smart Inverter Air-Conditioning

Drawing Title: Peter O'grady	Number: 1	Scale: 1:100 All measurements in mm, setup for A3 printing
Designed by: Ella Mitchell	Date: 05/01/2023	
Installation Address: 3 Green Lane Croxley Green Rickmansworth WD3 3HR	Design: TGO 1	
	Reference: 220400608TGOundefined1	