

* NB: ALL PROPOSED SITE AND FLOOR LEVELS TO MATCH EXISTING LEVEL HEIGHTS. ALL LEVELS ABOVE GROUND LEVEL WILL MATCH EXISTING.

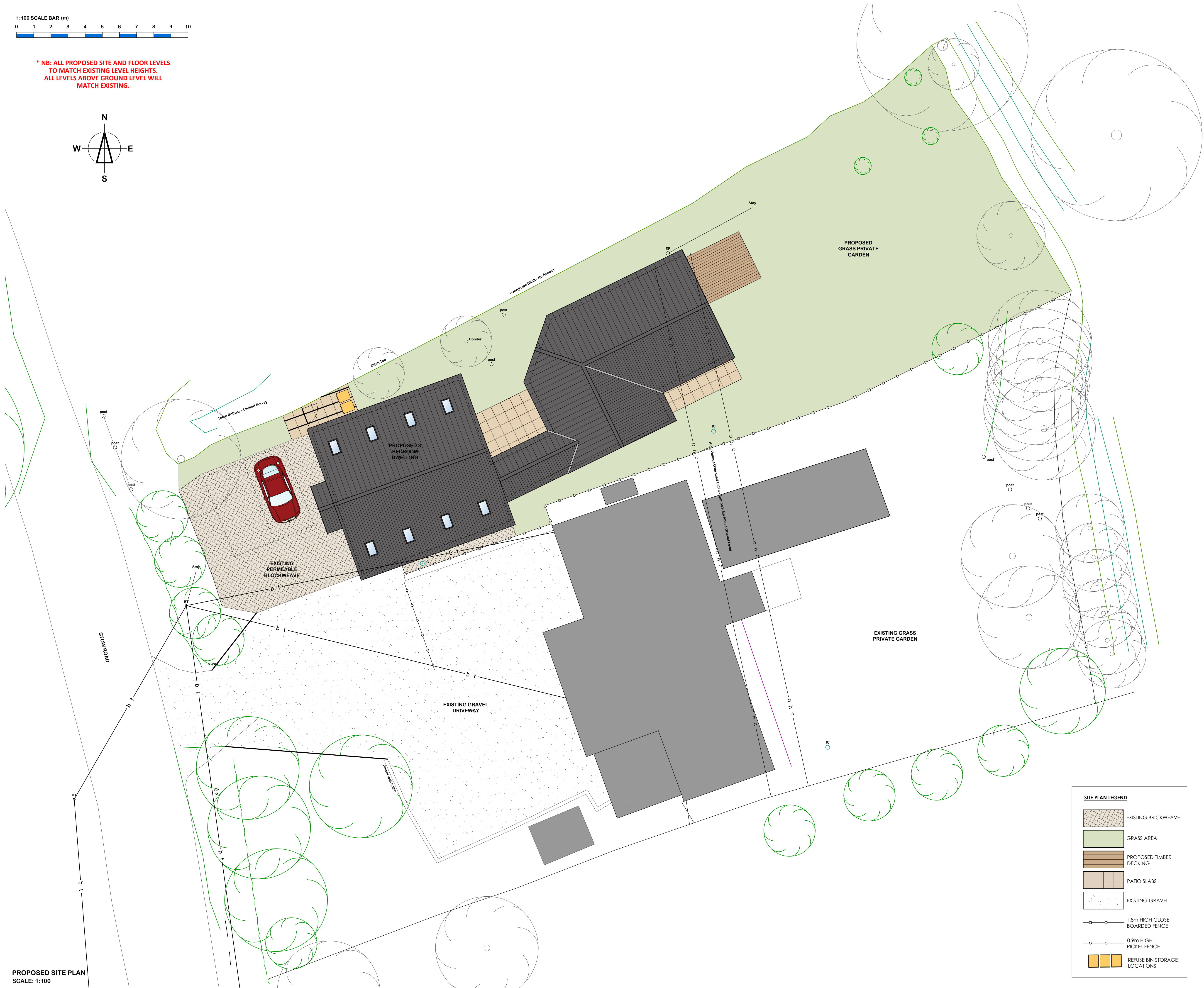
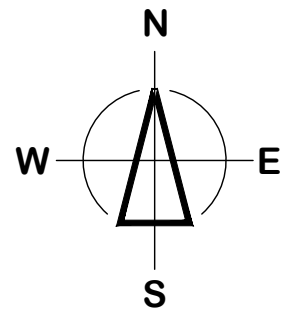

PROPOSED SITE PLAN SCALE: 1:100

SITE PLAN LEGEND	
	EXISTING BRICKWEAVE
	GRASS AREA
	PROPOSED TIMBER DECKING
	PATIO SLABS
	EXISTING GRAVEL
	1.8m HIGH CLOSE BOARDED FENCE
	0.9m HIGH PICKET FENCE
	REFUSE BIN STORAGE LOCATIONS

Notes:

This document is the property of David Trundley Design Services Ltd and may not be reissued, loaned or copied in part or in whole without written permission © 2022

All dimensions are in millimetres unless stated otherwise.

It is recommended that information is not scaled off this drawing.

This drawing should be read in conjunction with all other relevant information, specifications & schedules.

If this drawing is received electronically it is the recipients responsibility to print the document at the correct scale.

All dimensions to be checked on site prior to commencing work and any discrepancies to be advised immediately.

CONSTRUCTION (Design & Management) REGULATIONS 2015: David Trundley Design Services Ltd are employed as 'Designer' and will provide information to those responsible for the 'Principal Designer' and to the client.

David Trundley Design Services Ltd are responsible for the 'Architectural' design of the elements included on this drawing only.

Architectural design has been carried out with due consideration for the safety during construction, occupation and maintenance of the finished structure.

The works contain no extraordinary hazards or risks that are not present during routine construction operations that would not readily be apparent to a competent contractor.

This information should be included as part or commencement of the Health and safety file for the project.

no	date	amendment description
B	07.12.2022	PROPOSED SITE PLAN UPDATED TO SUIT CLIENTS COMMENTS
A	29.11.2022	PROPOSED SITE PLAN UPDATED TO SUIT CLIENTS COMMENTS

Revisions

Drawing Status: **PLANNING**

Salgate Barn
Islington Road
Tilney All Saints
King's Lynn
Norfolk
PE34 4RY
Tel: 01553 617700
Fax: 01553 617874
Email: enquiries@trundley.com

www.trundley.com

Project Title:
**JANE PARTRIDGE
STOW ROAD,
STOWBRIDGE,
KING'S LYNN,
PE34 3PF**

CONVERT EXISTING ANIMAL HYDROTHERAPY CENTRE INTO RESIDENTIAL DWELLING

Drawing Title:
PROPOSED SITE PLAN

Scale: AS STATED @ A1 Date: DECEMBER 2022 Drawn: TN

Drawing Number: **22-P28-PL003**

Checked by: Date:

If this drawing is unsigned in the check box then the drawing is an unauthorised issue and should not be used for any purposes