

This scheme is subject to Town Planning and all other necessary consents. Dimensions, areas and levels where given are only approximate and subject to site survey. All dimensions are to be checked on site, do not scale. This drawing is to be read in conjunction with all relevant consultants' and/or specialists' drawings / documents and any discrepancies or variations are to be notified to the designer before the affected work commences. All queries relating to design of foundations, floor slabs and any structural elements are to be referred to the structural engineering consultant for resolution. All feasibility studies are subject to full site survey. The workmanship of all relevant trades and building operations shall comply with the recommendations of British Standard (BS) 8000:1989 parts 1-15 inclusive. All design and construction is to be in accordance with the Construction, Design and Management Regulations 2007. All Existing buildings remain unsurveyed

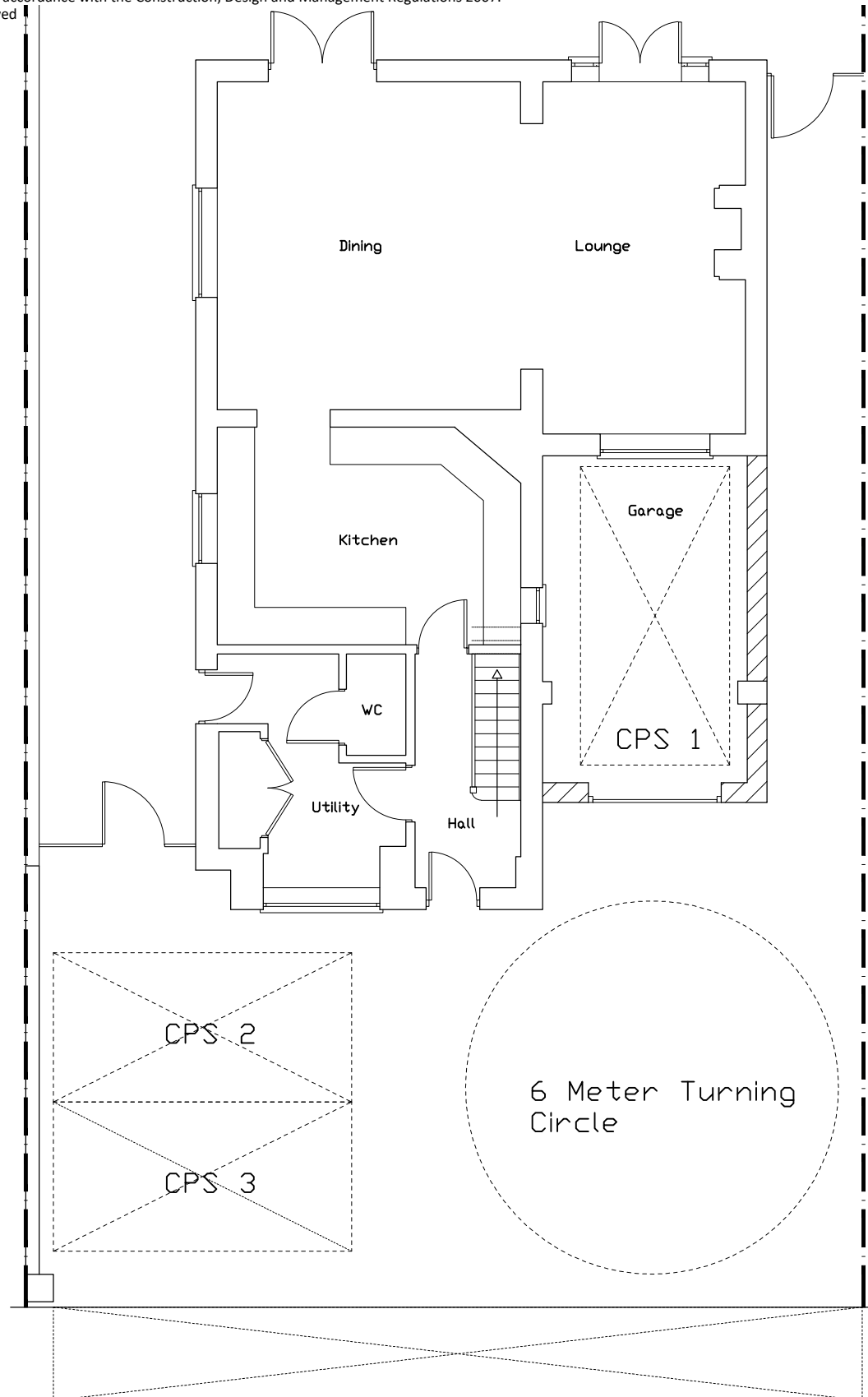

New Pedestrian Crossover with extended dropped curb installed to highways standards

1:100 Proposed Ground Floor Plan

SCALE 1:100 (METRES)

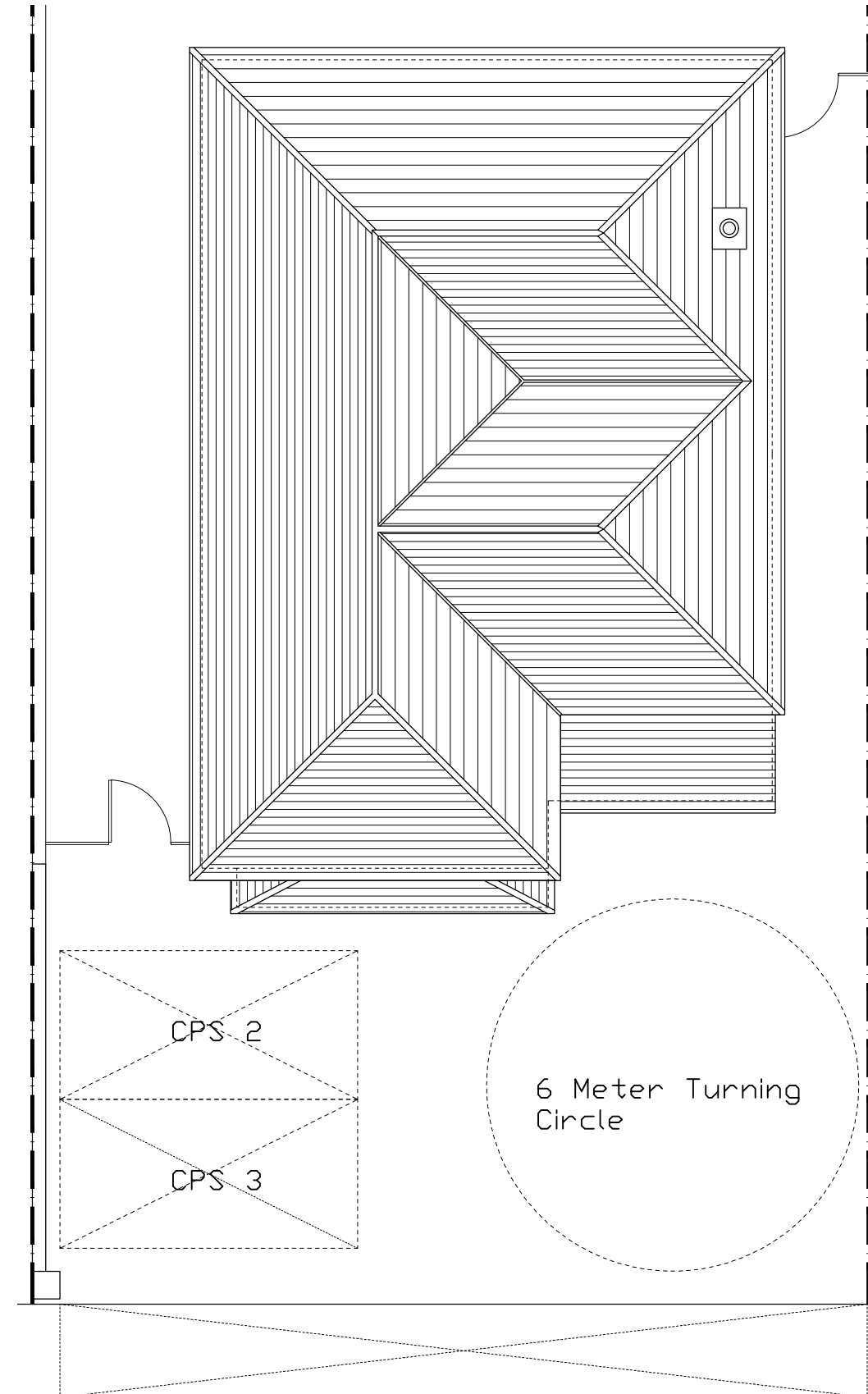

1:100 Proposed Roof Plan

Rev	Description	Date
Client : Mr & Mrs Cooper		
Job title : Anvil, Main Road, Wisbech, PE14 9JR		
Drg : Proposed Plans		
scale 1:100 date: Oct 2022 drg. no. A400-07		