

PLANT AREA 'B'- SCALE 1:30

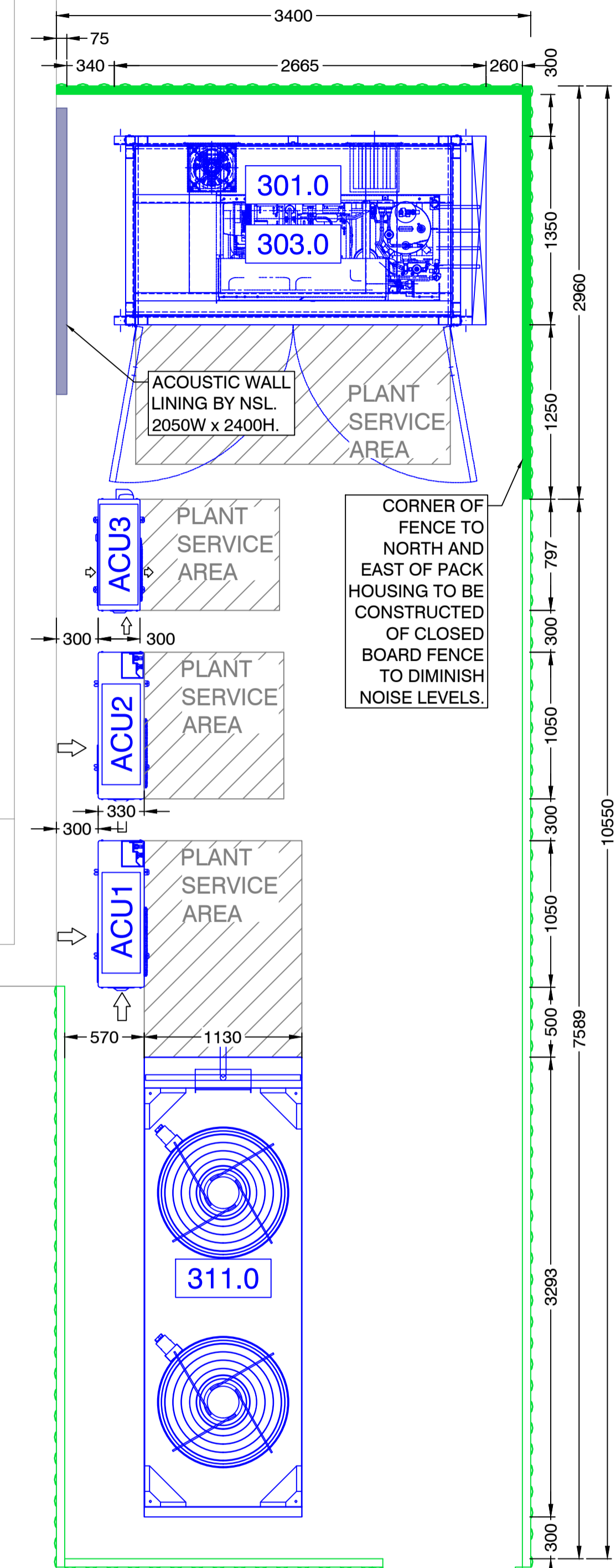

GROUND FLOOR PLAN OVERVIEW - SCALE NTS

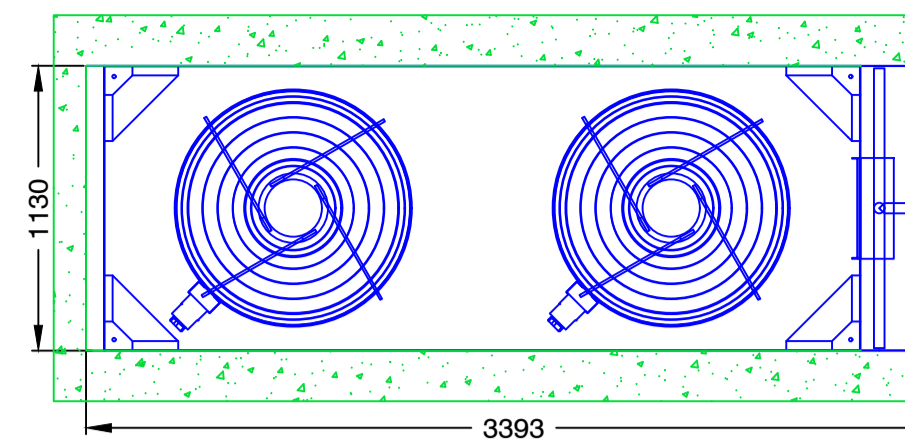
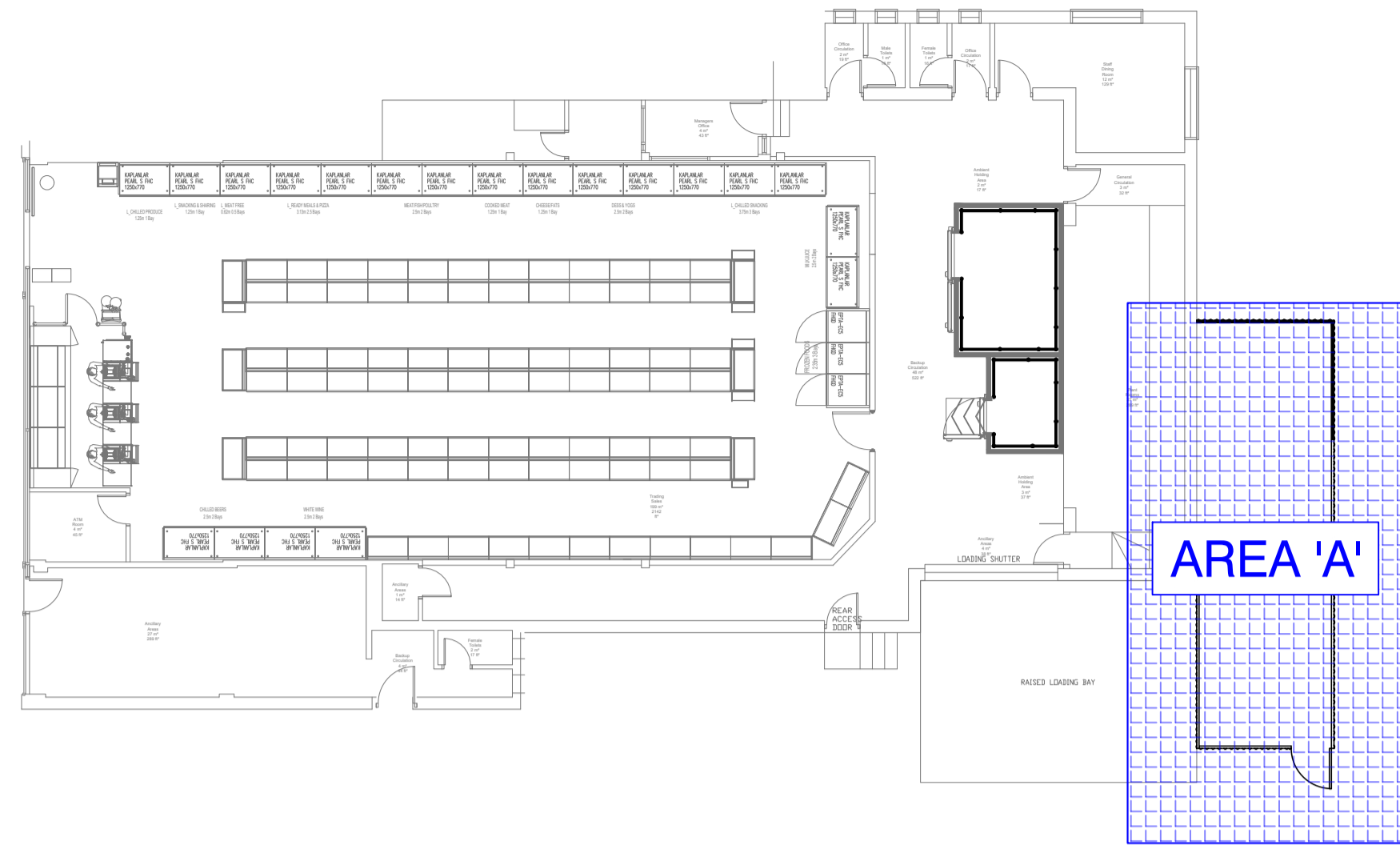

KELVION GAS COOLER - GF-MB102G4H-091R-AMHE-10FPI
SCALE - 1:30

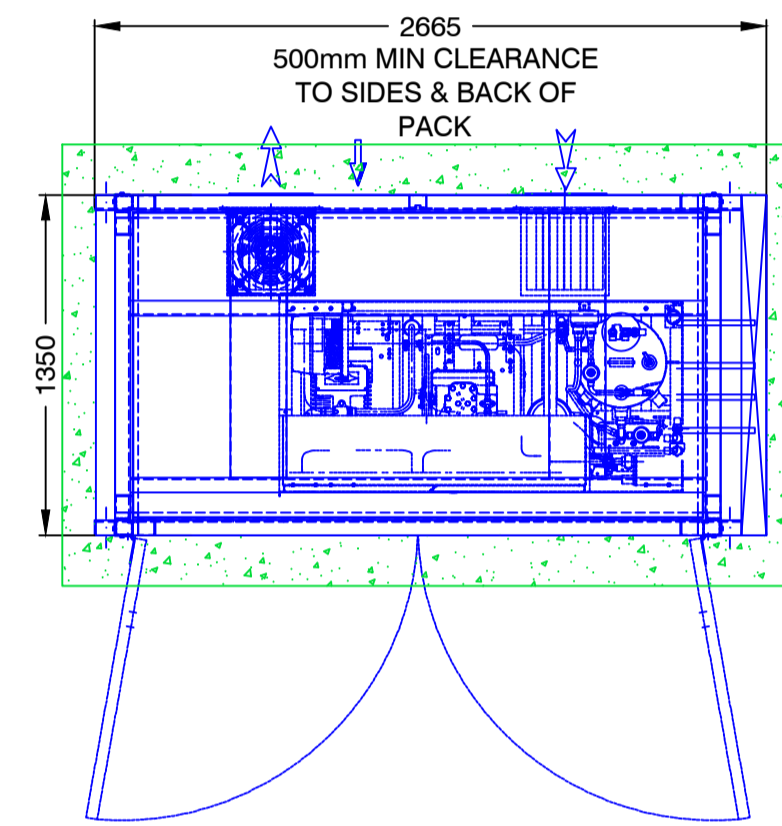
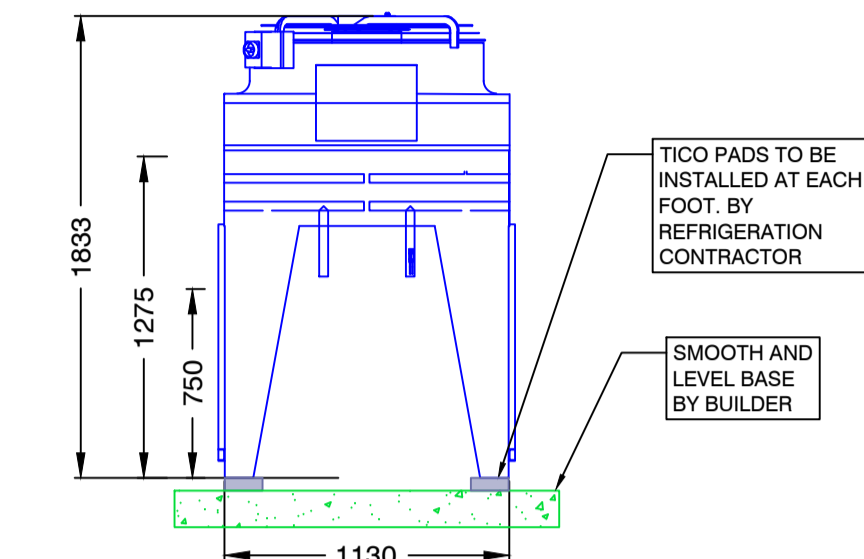
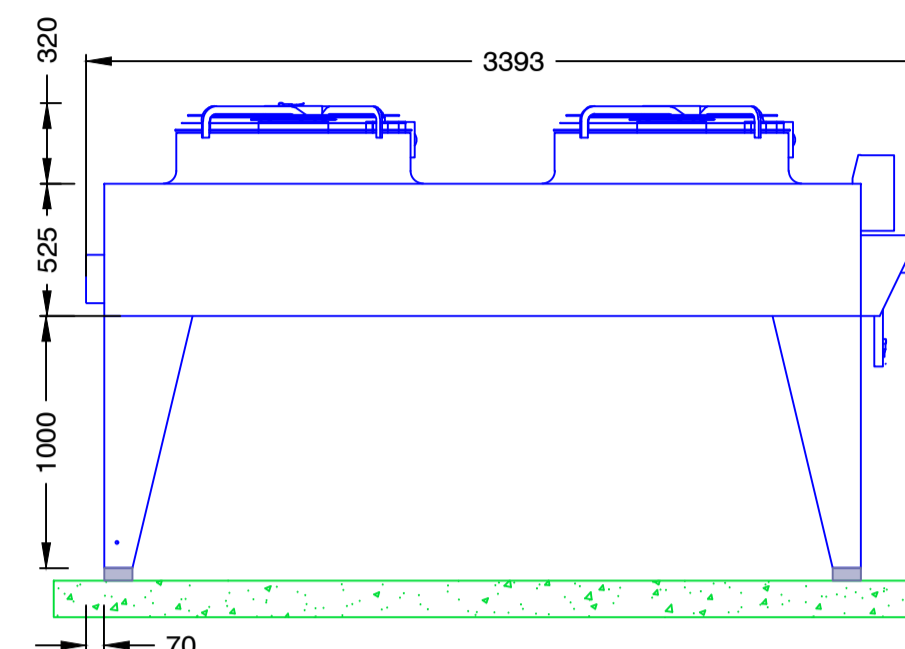

SCM-FRIGO DT CO2 LOW NOISE PACK
SCALE 1:30

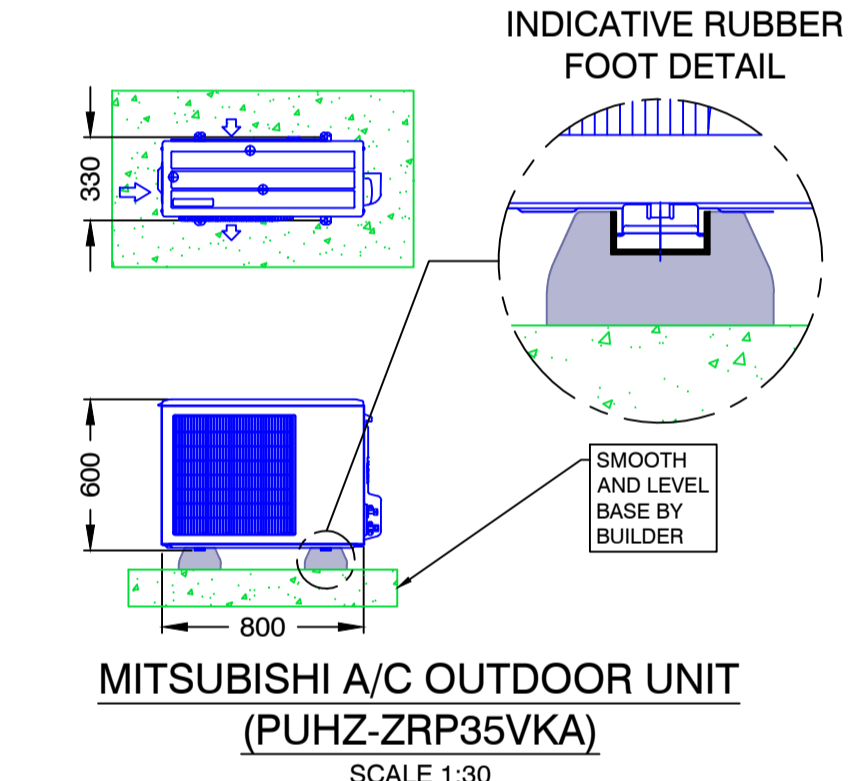
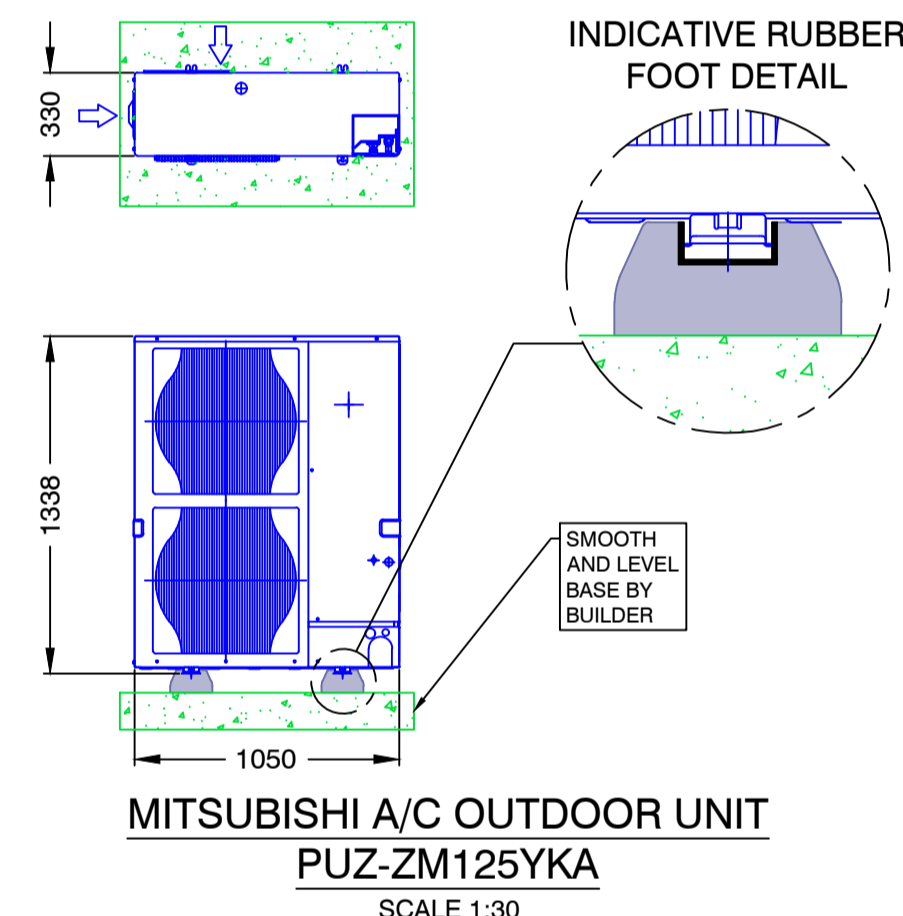
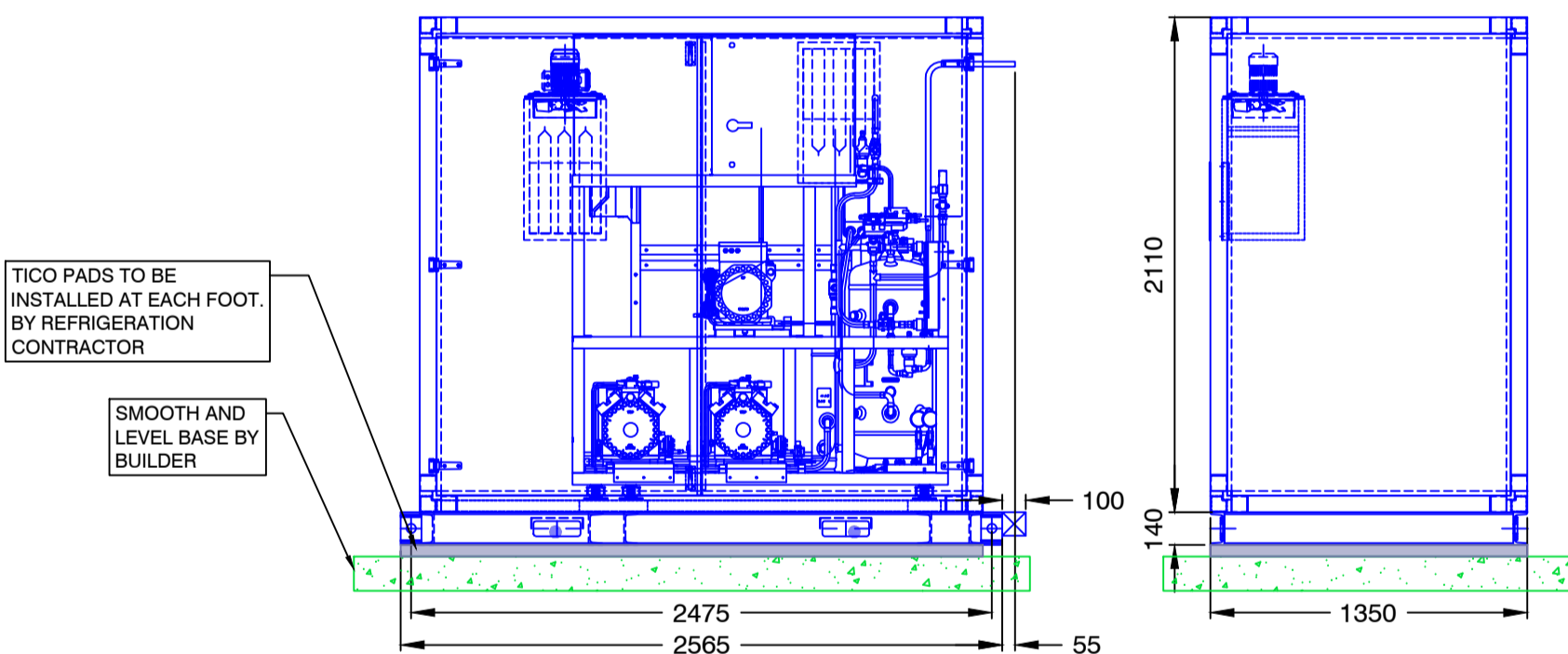

FIXTURE NUMBER	ASSET TAG NUMBER (SSL12345678) NO SPACES OR DASHES	ASSET TYPE	ASSET LOCATION	NEW / EXISTING / OFF SITE REFRUBISHED / SITE REFRUBISHED	DATE INSTALLED DD/MM/YYYY	MANUFACTURER	MODEL	REFRIGERANT TYPE	REFRIGERANT CHARGE WEIGHT (KGS)	COOLING DUTY (KW)	HEATING DUTY (KW)	MCB RATING (AMPS)	ELECTRICAL CONNECTIONS	STARTING CURRENT (AMPS)	FLA	MAINS CABLE CORES	UNIT WEIGHT (KG)	TAIL SIZES	PIPE/FIN MATERIAL	DIMENSIONS L X W X H	AIRFLOW (m3/min)	SOUND PRESSURE LEVEL dBA @ 1m
ACU1		OUTDOOR UNIT	PLANT AREA	NEW		MITSUBISHI	PUZ-ZM125YKA	R32	4	-	-	16	400V / 3Ph / 50Hz	8	5.32 (10)	-	125	-	CU/AV	1050x330x1338	-	52
ACU2		OUTDOOR UNIT	PLANT AREA	NEW		MITSUBISHI	PUZ-ZM125YKA	R32	4	-	-	16	400V / 3Ph / 50Hz	8	5.32 (10)	-	125	-	CU/AV	1050x330x1338	-	52
ACU3		OUTDOOR UNIT	PLANT AREA	NEW		MITSUBISHI	PUZ-ZM35VKA	R32	3.5	-	-	16	220-240V / 1Ph / 50Hz	5	4.97 / 4.31 (13.4)	-	46	-	CU/AV	809x300x630	-	46

SYSTEM REF.	PACK ID (30'-)	ASSET TAG NUMBER (SSL12345678) NO SPACES OR DASHES	ORIGINAL ASSET NUMBER IF APPLICABLE	ASSET TYPE	ASSET LOCATION	NEW / EXISTING	DATE INSTALLED DD/MM/YYYY	MANUFACTURER	MODEL	PACK CONTROLLER	REFRIGERANT	NUMBER OF COMPRESSORS	COMPRESSOR MODEL	Start Current Per Comp (Amps) [Pardr/Jul]	Maximum Full Load Current Per Comp (Amps)	ELECTRICAL SUPPLY	HOUSED OR UNHOUSED	OPERATIONAL WEIGHT (kg)	RECEIVER VOLUME (kg)	TOTAL SYSTEM CHARGE (kg)	PED CAT.	LENGTH OF UNIT (mm)	WIDTH OF UNIT (mm)	HEIGHT OF UNIT (mm)	NOISE RATING dBA @ 10m DAY	NOISE RATING dBA @ 10m NIGHT
IT1/LT1	301.0 / 303.0			REFRIGERATION PACK	PLANT AREA	NEW		SCM FRIGO	1x MWS 2x096 MTDX+ UMCE 007 HB7/S	CAREL	R744	1	4KTE-10K 40S	18.63	22.4	400/3/50/60	HOUSED	TBC	TBC	TBC	IV	2610	1350	2250	32	32

PACK ID (31'-)	SYSTEM REF (IT / LT / DT)	ASSET TAG NUMBER (SSL12345678) NO SPACES OR DASHES	ASSET TYPE	ASSET LOCATION	NEW / EXISTING	DATE INSTALLED DD/MM/YYYY	MANUFACTURER	MANUFACTURER MODEL REFERENCE	REFRIGERANT	FAN TYPE	Number of Fan Motors	Start Current Per Fan Motor (A)	Run Current Per Fan Motor (A)	SUPPLY VOLTAGE	DUTY (KW)	AIR VOLUME REQUIRED (m3/s)	GAS COOLER INLET TEMP C	GAS COOLER OUTLET TEMP C	TD (K)	OPERATIONAL WEIGHT (KG)	FIN MATERIAL	LENGTH (mm)	WIDTH (mm)	HEIGHT (mm)	Noise Rating dBA @ 10m Night Time	Noise Rating dBA @ 10m Night Time
311.0	IT1/LT1		GAS COOLER	PLANT AREA	NEW		KELVION	GF-MB102G4H-091-AMHE-10FPI	R744	EC	2	5.70	4.10	400V / 3Ph / 50-60Hz	68.00	4.13	110	35	3.00	505	CU/ALMG	3393	1130	1833	23	23



AB Group - Head Office
Bank Chambers, 2 Church Street, Reigate, Surrey, RH2 0AN.
Tel: 0333 9000 180 Web: abgroup.com

DRAWING SCALE 1:30
600mm 0 600mm 1200mm 1800mm

LEGEND

- 301.0 FIXTURE ID
- SERVICE AREA
- KEY CLAMP**
- HIT & MISS FENCING**
- PALISADE FENCE**
- CHAIN FENCE**
- EXISTING PLANT EQUIPMENT

REFERENCE NOTES

- A SMOOTH AND LEVEL BASE CONCRETE PLINTH REQUIRED FOR REFRIGERATION PLANT AND AC OUTDOOR UNITS - TO BE PROVIDED BY THE BUILDER.
- B AC UNIT - REQUIRED TO BE MOUNTED ON SUITABLE ANTI-VIBRATION PAD.
- C COMPRESSOR PACK - TO BE MOUNTED ON SUITABLE ANTI-VIBRATION PAD.
- D GAS COOLER - TO BE MOUNTED ON SUITABLE ANTI-VIBRATION PAD.
- E MINIMUM PLANT AREA FENCE TO BE 2.4M HIGH.
- F GAS COOLERS ARE TO BE SUPPLIED WITH ISOLATOR & CONTROL PANEL ON THE PIPE END, UNLESS OTHERWISE STATED.

GENERAL NOTES

****BUILDERS WORKS IN CONNECTION - TO BE CARRIED OUT BY MAIN CONTRACTOR**

ALL WORK TO COMPLY WITH THE LATEST SAINSBURY'S REFRIGERATION SPECIFICATION

DRAWING REVISIONS

REV	DATE	DETAILS	DRAWN
00	18.11.22	Preliminary issue.	CW

PRELIMINARY

SITE ADDRESS:
SAINSBURY'S - DURHAM ROAD LOCAL

SITE ADDRESS:
REFRIGERATION PLANT AREA LAYOUT

PROJECT MANAGER / CONSULTANT: KEVIN WALL	DESIGN ENGINEER: CONOR UNJUST	
DATE: 18.11.2022	DRAWN BY: CW	REVIEWED BY: MO
CONTRACT NUMBER: QR 115083	SCALE: 1:30 @A1	DERIVED FILE: CDG3_REV1
PROJECT: 1215_2234	ORIG: ABG	DIVISION: ZZZ
LEVEL: GF	TYPE: DR	ROLE: N
NUMBER: 555	REV: 00	