

TCB TCB

LB

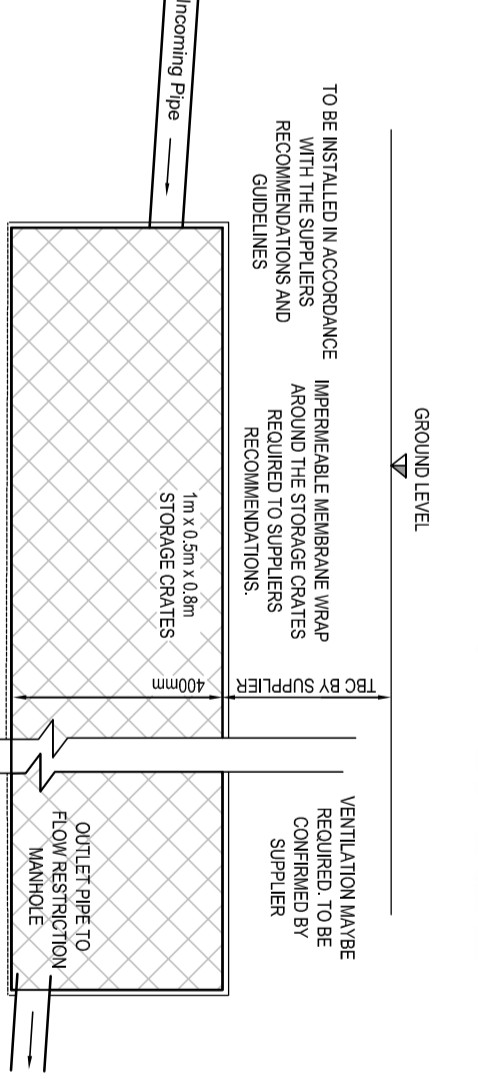
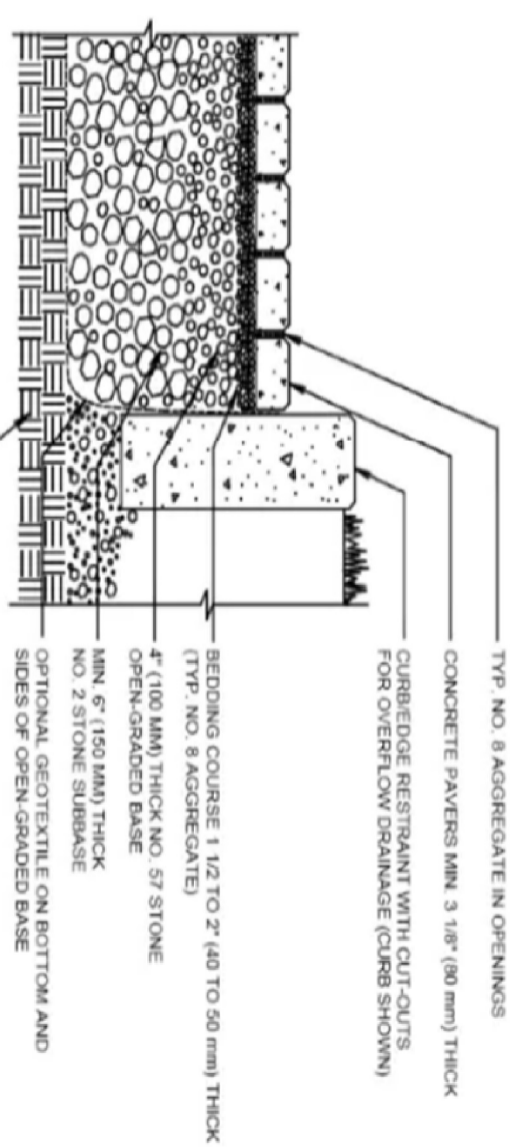
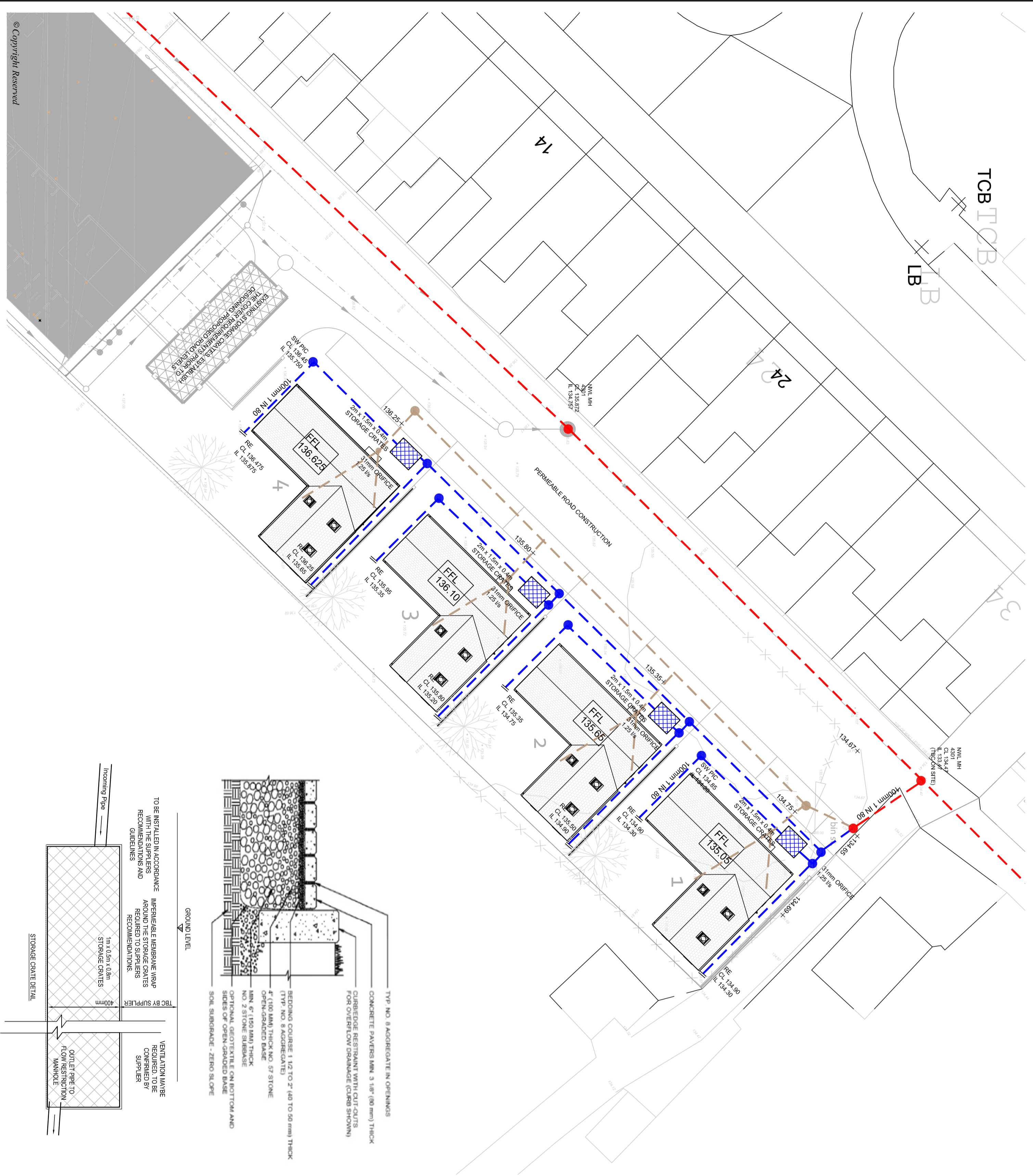

DRAINAGE

NWL HAVE CONFIRMED THAT A 5 L/S DISCHARGE RATE IS REQUIRED FOR THE SURFACE WATER DRAINAGE SYSTEM.

EACH PLOT WILL HAVE ITS OWN STORAGE SYSTEM RESTRICTED TO 1.25l/s GIVING AN OVER ALL DISCHARGE RATE OF 5 l/s.

THE ACCESS ROAD WILL BE CONSTRUCTED FROM PERMEABLE MATERIALS

THE ARCHITECT IS TO CONFIRM THE LOCATION OF THE FOUL OUTLETS FROM THE DWELLINGS.

FOUNDATIONS

FOUNDATION WIDTHS HAVE BEEN CONFIRMED AS 600mm FOR ALL WALLS.

SITE INVESTIGATION HAS STATED THAT AT SHALLOW LEVEL THE GROUND IS SOFT AND THAT THE FOUNDATIONS ARE TO BE TAKEN THROUGH THESE LAYERS AND TO THE SOLID CLAY BELOW.

IT HAS ESTIMATED PLOTS 1 AND 2 WILL NEED TO BE TAKEN TO APPROXIMATELY 2m BELOW GROUND LEVEL AND PLOTS 3 AND 4 TO 1.5m BELOW GROUND LEVEL.

THIS IS TO BE CONFIRMED ON SITE AND AGREED WITH THE BUILDING INSPECTOR.

IF THERE ARE ANY TREES IN THE PROXIMITY OF THE FOUNDATIONS THESE ALSO NEED TO BE TAKEN INTO ACCOUNT WHEN ESTABLISHING THE DEPTHS AND NEED FOR HEAVE PRECAUTIONS

A ROAD DETAIL ADDED 08.02.23 CN

JOHN SEYMORE

DALE ROAD, SHILDON

EXTERNAL WORKS SKETCH

Drawing Number:	MD01664/0100	Scale:	1:200 @ A2
Drawn by:	CN	Checked by:	MJH
Date:	NOVEMBER 2022		



civil, structural & environmental solutions for the construction industry

M DESIGN UK LTD
 50A WATERSIDE PARK,
 HERMAN, SOUTH PARK,
 NORTHUMBERLAND,
 NE6 1BS
 Tel: 01661 854444
 Fax: 01661 854455
 info@mdesign.uk.com