

Detail 1 scale 1:5
Flush casement window vertical section

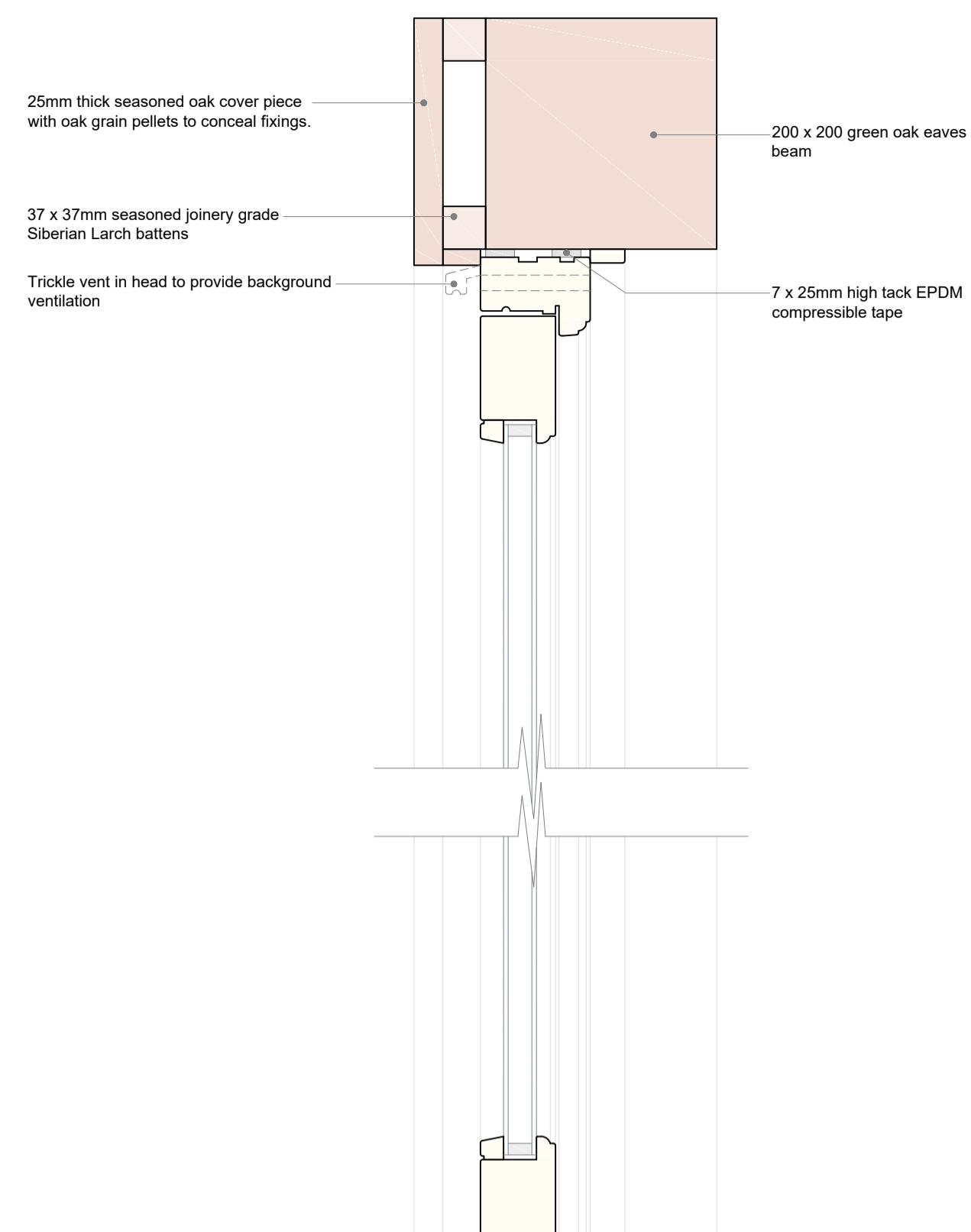

Detail 2 scale 1:5
Flush casement window section on plan

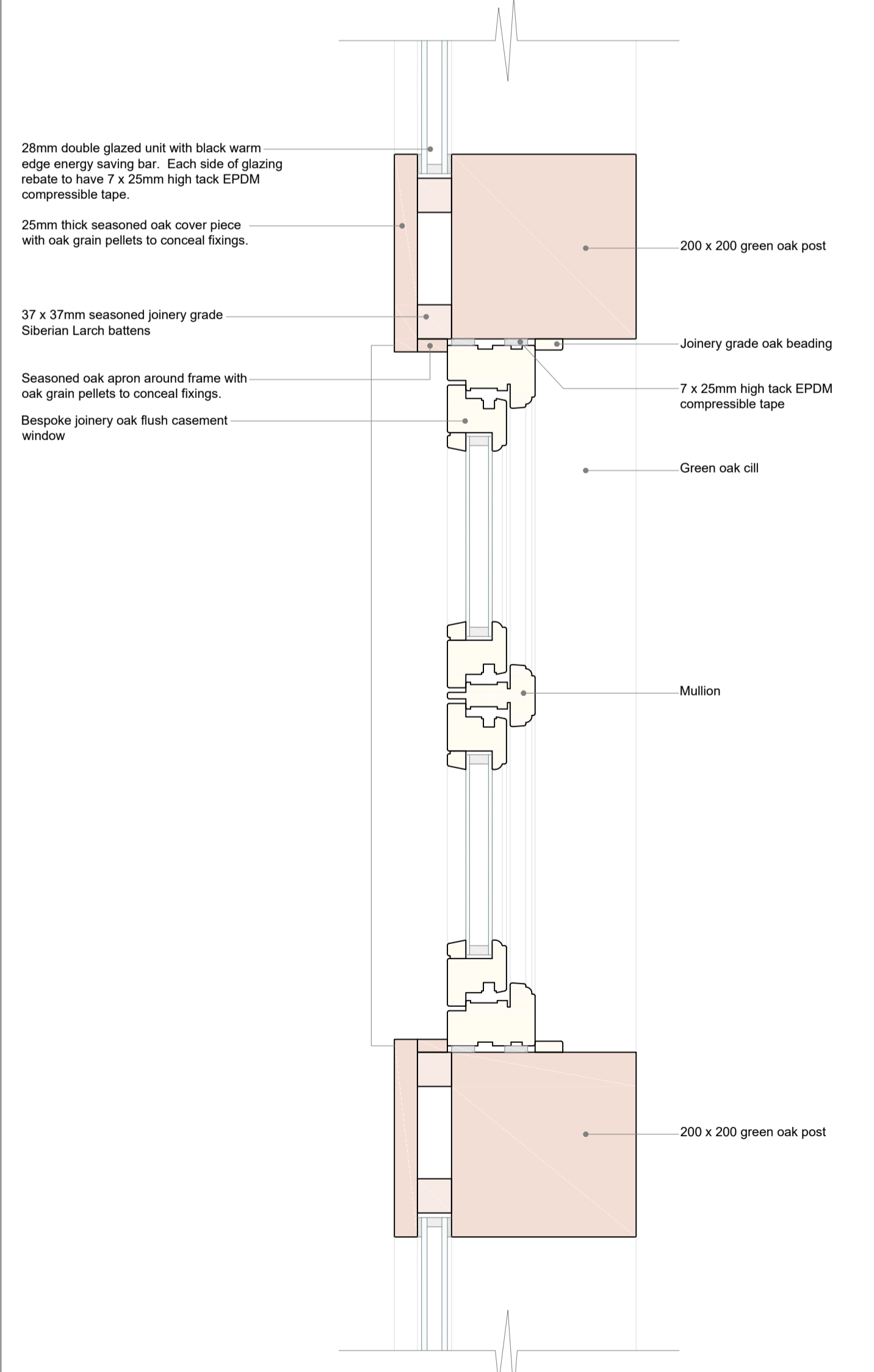

Detail 3 scale 1:5
Doors vertical section

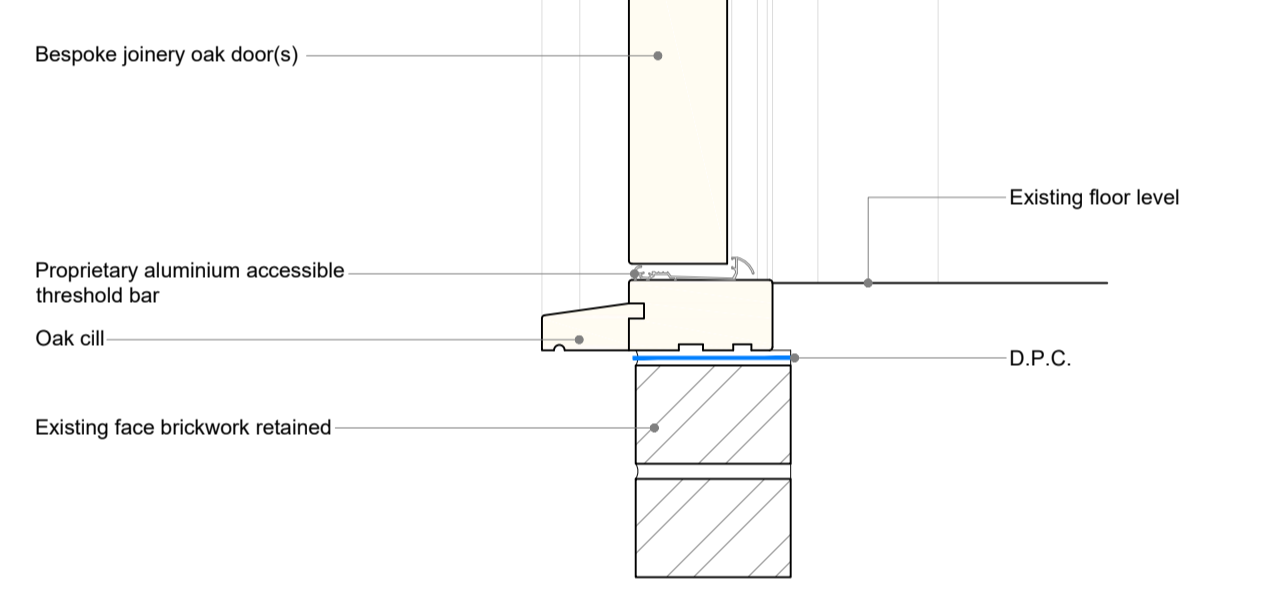

Detail 4 scale 1:5
French doors section on plan

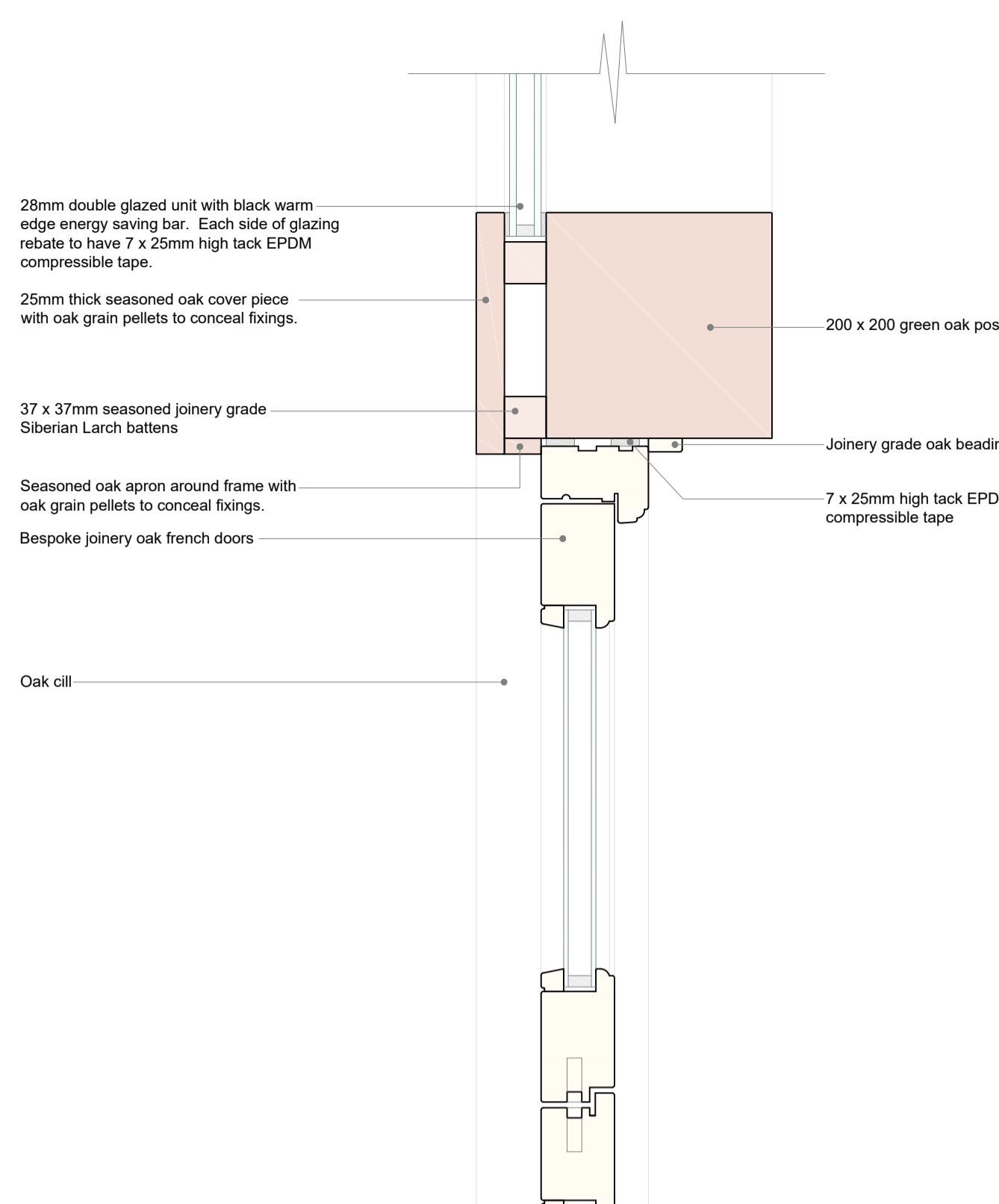

Detail 5 scale 1:5
Oak frame direct glazing vertical section

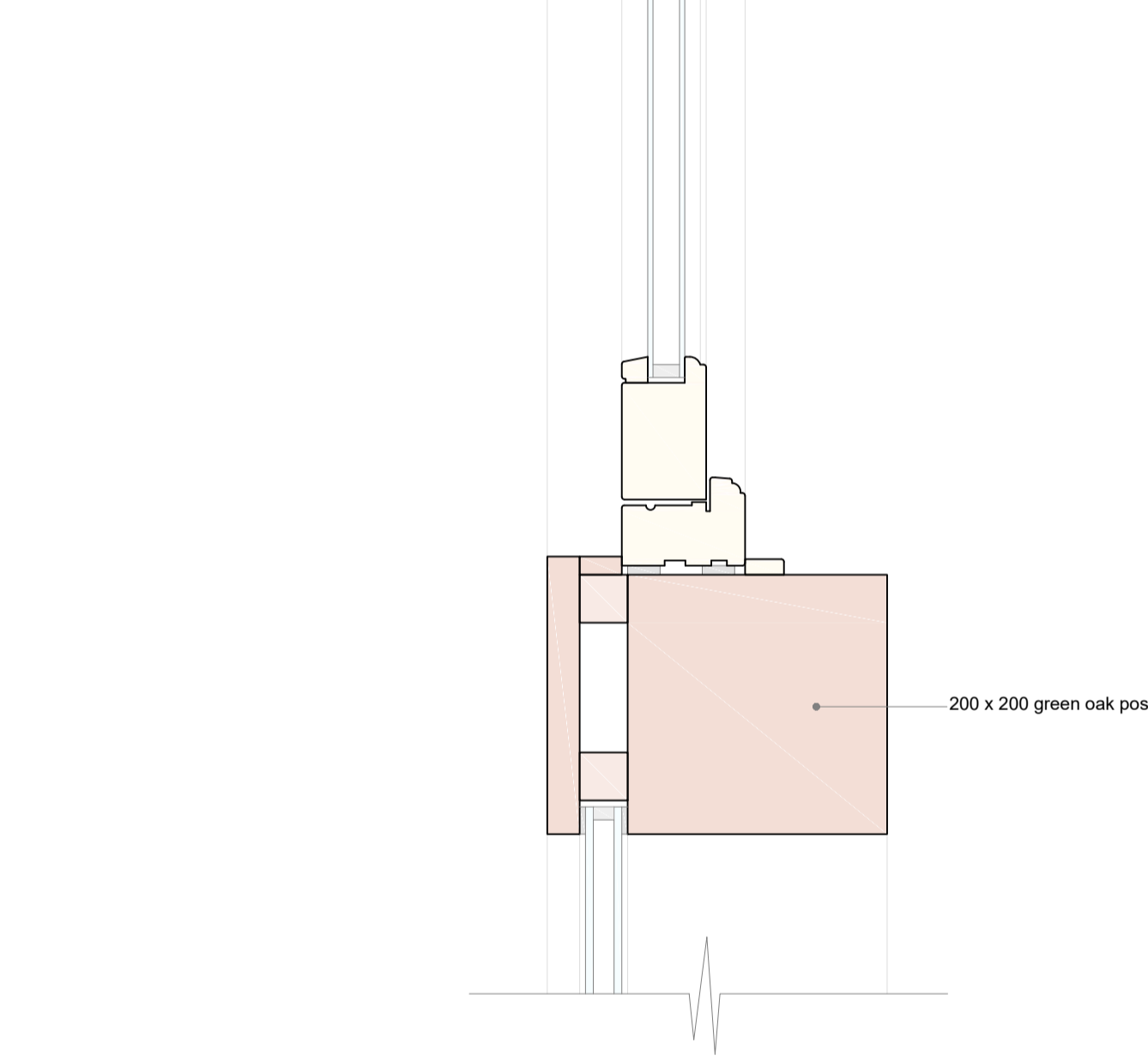

Detail 6 scale 1:5
Replacement oak framed 'Link' to house abutment, plan section

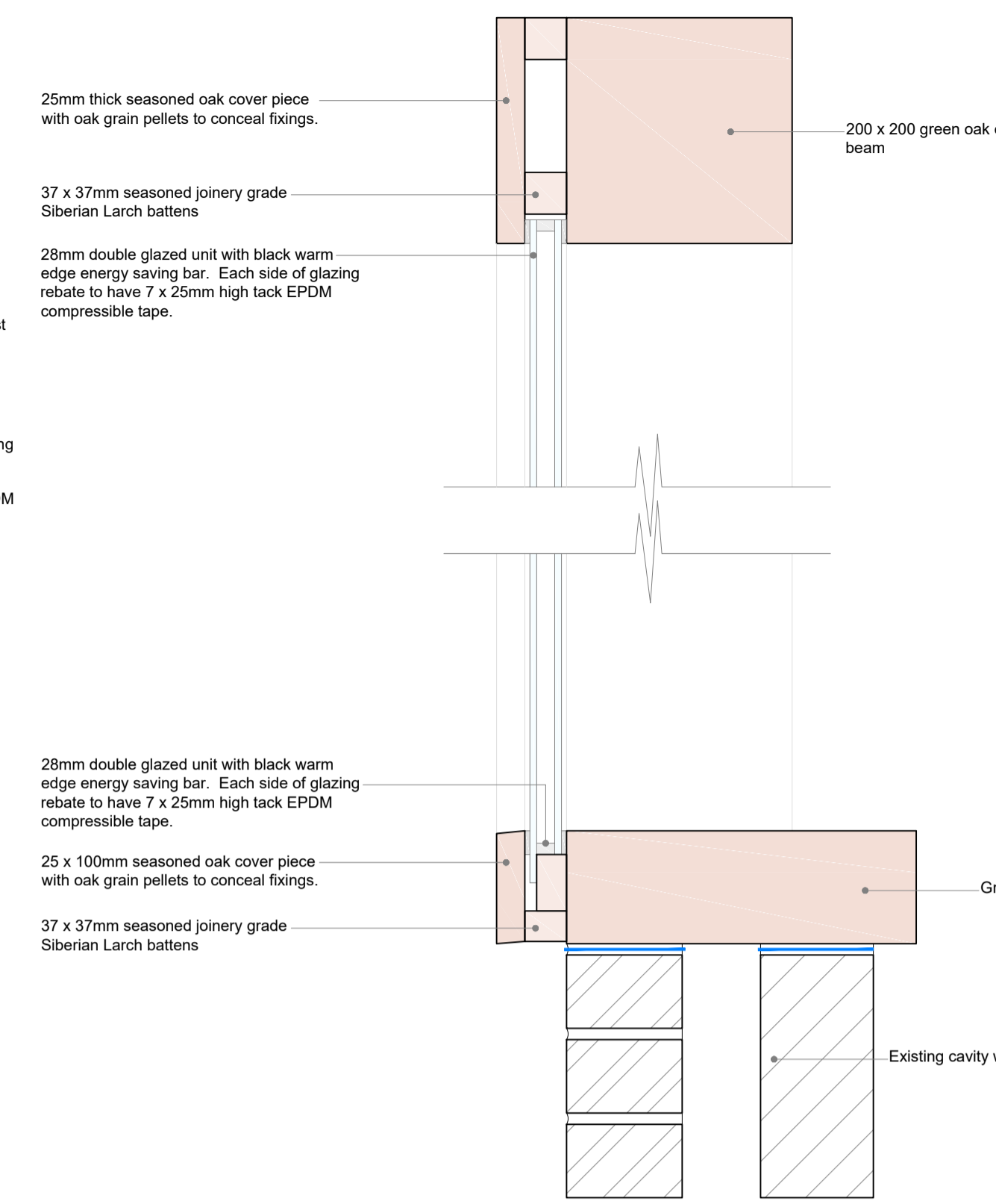

Detail 7 scale 1:5
Replacement oak framed 'Link' to house roof abutment, section.

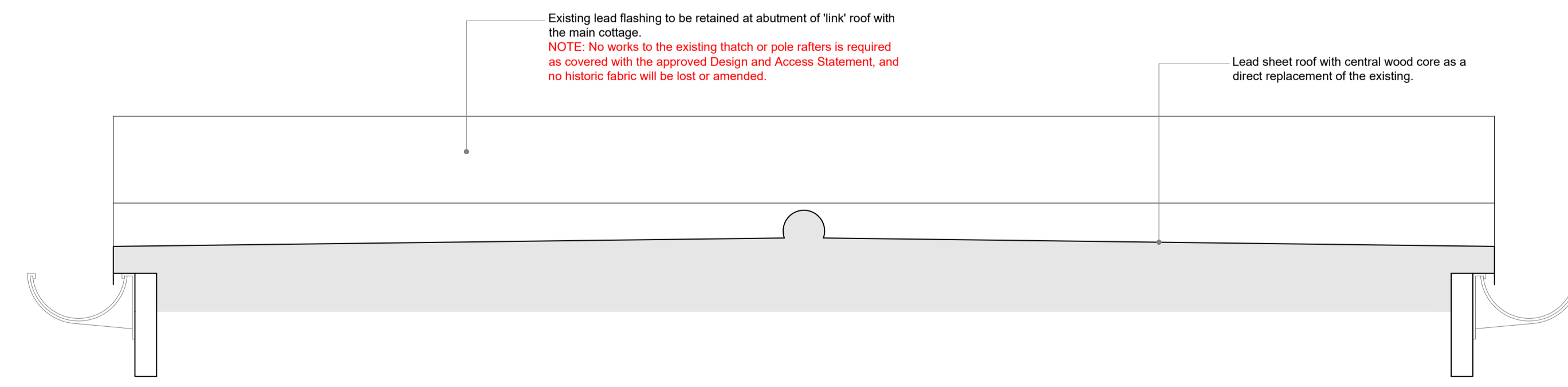

Detail 8 scale 1:5
Replacement oak framed 'Link' to house roof abutment, section.

General Notes:
This drawing is the copyright of N & J Design Limited and may not be copied in whole or in part without prior permission.
It is the clients/developers responsibility to ensure all relevant approvals are in place and conditions satisfied prior to commencement of works, including, but not limited to:
The Party Wall etc Act 1996
Local Authority Planning Consent
Highways (Road opening permit)
Local Water Authority Building Regulations (Local Authority, NHBC etc)
Environment Agency
Due to the nature of oak, final component sizes and locations may vary slightly from those stated on this drawing.

LISTED BUILDING NOTES:
1. All works should be undertaken in strict accordance with the Planning and Listed Building consents and approved documents:
Planning Ref: 22/01614/HOU
Listed Ref: 22/01615/LIS
2. The works do not require the alteration to, or removal of, any historic fabric.
3. No element of the new works, specifically the replacement 'link', shall be mechanically fixed to the main dwelling.



Rev: Date: Description:
Status: **Planning**
Title: **Details**

Project:
137 Ladwell Hursley Winchester SO21 2LE



N & J Design Ltd
7 Hedley Gardens
Hedge End
Southampton
SO30 2WT
t: 07840 404620 www.nandjdesign.co.uk

Drawn: N. Keatley Date: 02.03.23

Scale: 1:5
Drawing no: **2022.02.02/07** Revision:

