

# LEVEL MONITORING

## for Subsidence Management Services

### **Hawthorn House, Main Street, Nocton, LN4 2BH**

Client:	Subsidence Management Services
Client Contact:	Ian Domigan
Claim Number:	500397005
Client Reference:	IFS-LBG-SUB-22-0103204
Policy Holder:	Dr Nicolas and Mrs Bennett
Report Date:	19 January 2023
Our Ref:	M19612

## Level Monitoring Readings

The following table shows the reading levels of the various Level Monitoring Station points.

Date	1	2	3	4	5	6	7	8	9	10
04/11/2022	10.0000	10.0050	10.0940	9.9877	9.9905	9.9852	10.0065	10.0574	9.9952	10.0806
16/01/2023	10.0000	10.0047	10.0936	9.9878	9.9920	9.9864	10.0173	10.0643	9.9965	10.0822

## Level Monitoring Difference Graphs

The following graphs display the progressive movement that each Level Monitoring Station recorded at each separate site visit date to give an overall look at how much the property is moving.



## Level Monitoring Displacement Map

The following image shows an isometric representation of the movement of the property, based on the Level Monitoring Stations that were installed.

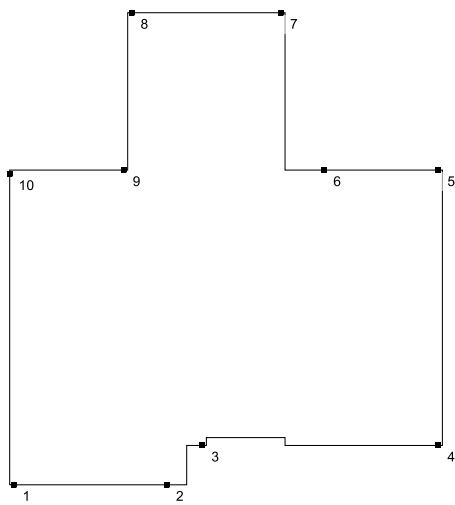
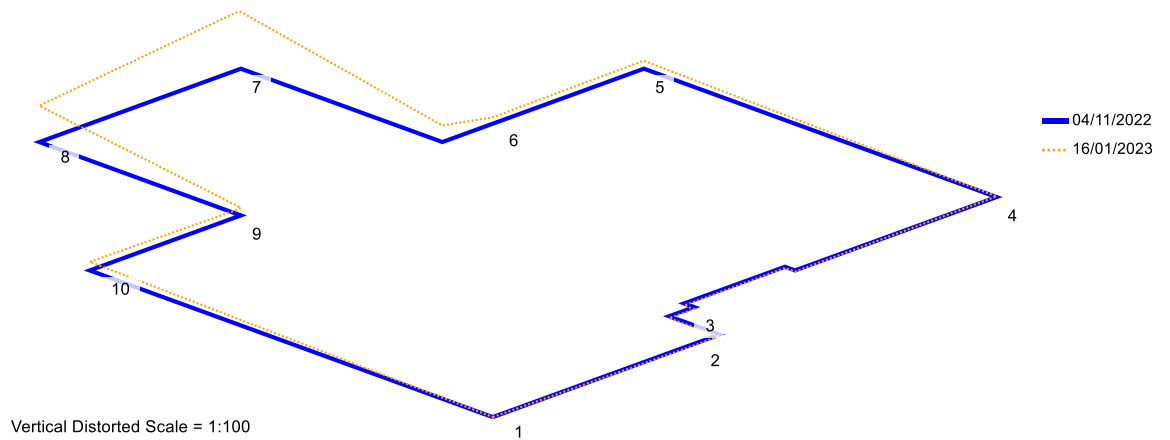

FRONT

## Site Visit Notes

Datum is level station 1, it has an assumed value of 10,000m. No suitable secondary datum available. If this is not suitable please advise if a deep datum is required. Relative survey.