

NOTES:

1. EXISTING GARAGE TO BE DEMOLISHED
2. NEW PROPRIETARY TIMBER GARAGE TO BE ERECTED ON EXISTING CONCRETE SLAB (INT AREA 14.6M²)
3. WALL CONSTRUCTION TO BE 45mm T&G SPRUCE
4. ROOF CONSTRUCTION TO BE 19mm T&G COVERED WITH A MEMBRANE AND FINISHED WITH BLACK HEX SHINGLES
5. SIDE DOOR TO BE TIMBER AND PART GLAZED
6. LEDGE & BRACE BARN DOORS TO BE T & G SPRUCE

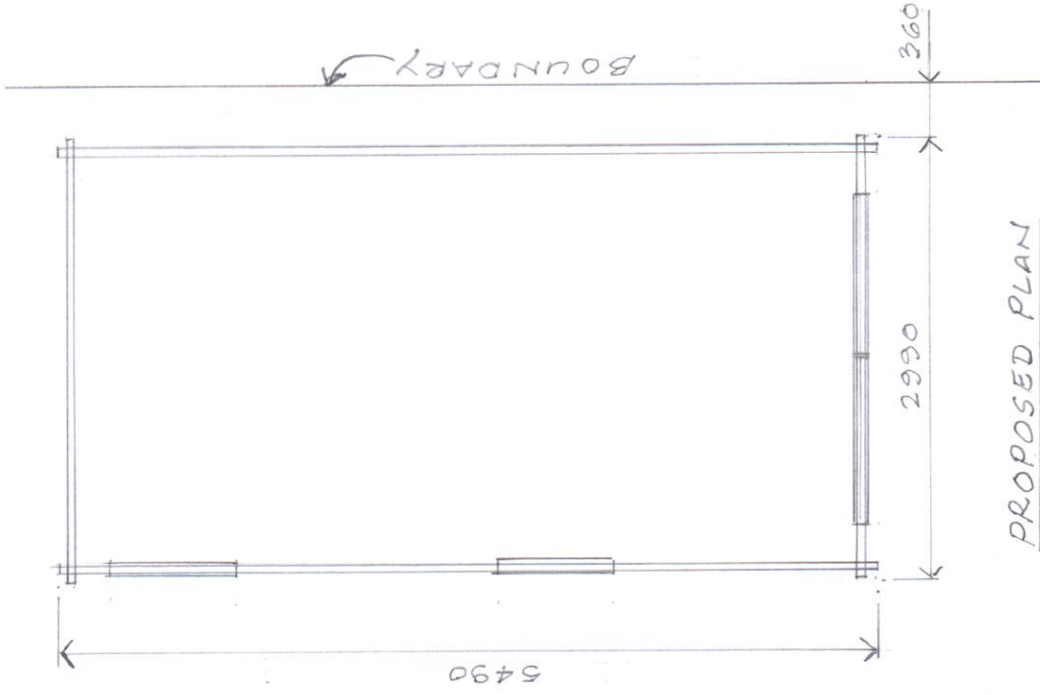

PROPOSED PLAN

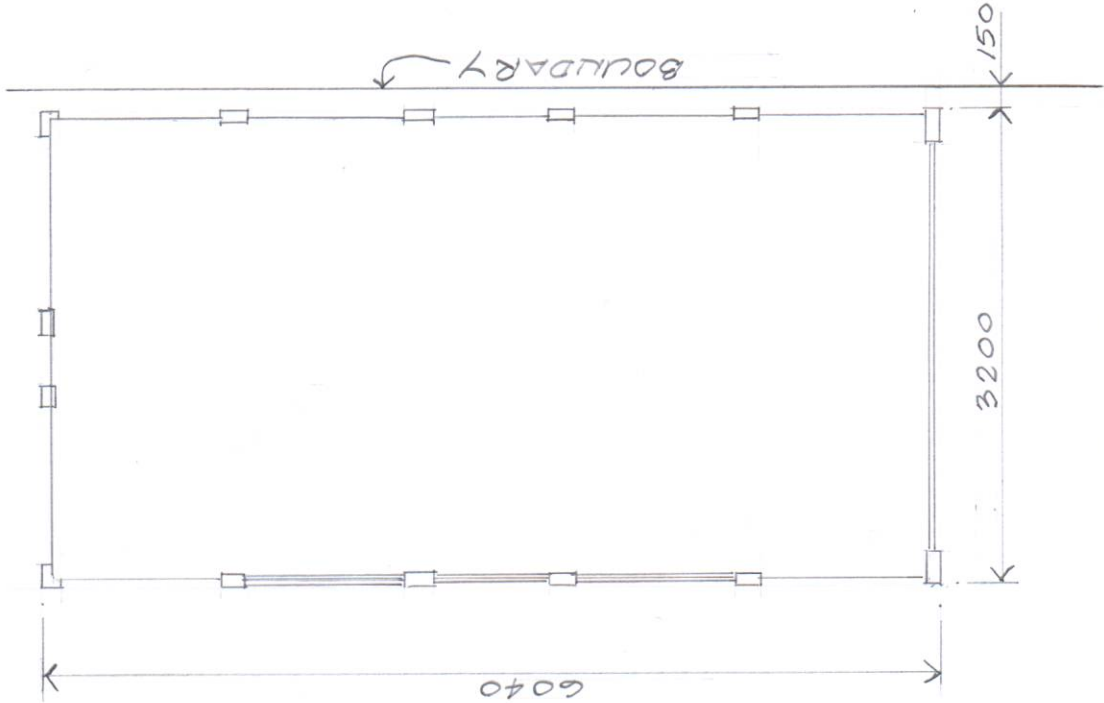

EXISTING PLAN



SCALE BAR 1:50

PROPOSED NEW GARAGE
FOR MR & MRS PATTEN
16 SOLENT DRIVE
HYTHE SO46 5FN

SCALE: 1:50
DRG: A4
DATE: MARCH 2023