

NOTES:

- 1. The contents of this drawing are copyright.
- 2. Scaled drawing for Planning purposes only.

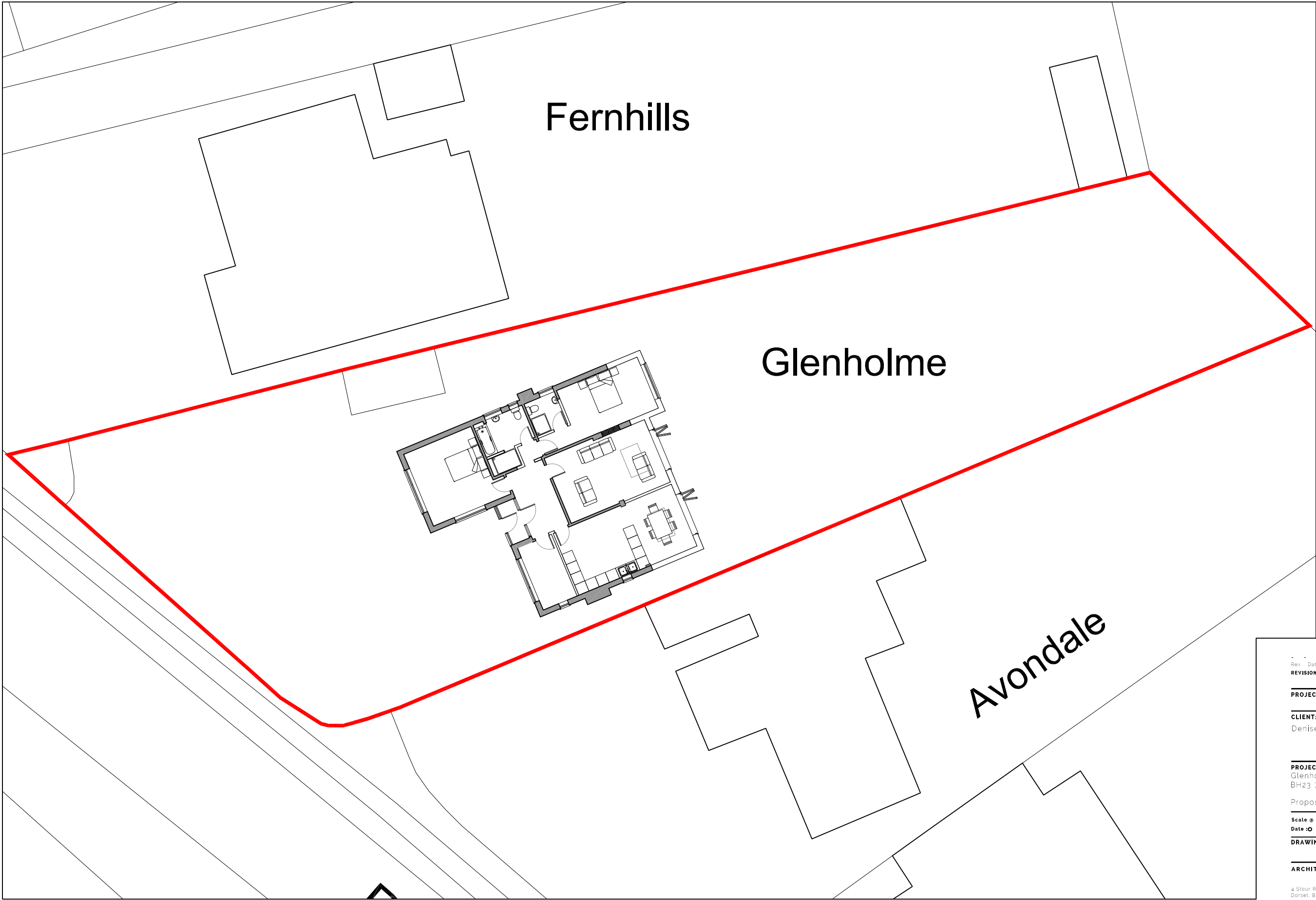

Fernhills

Glenholme

Avondale

Rev	Date	Description	By	PM
REVISIONS:				

PROJECT STAGE: COL

CLIENT:
Denise McDonnell

PROJECT & DRAWING TITLE:
Glenholme, Ringwood Road, Sopley, Christchurch, BH23 7BE

Proposed Site Plan

Scale @ A3: 1:200 **Drawn by:** RPA

Date: 08/03/23



DRAWING No: ASP.23.007.002

REVISION:

ARCHITECTURE - PLANNING - PROJECT MANAGEMENT - CDM

4 Stour Road, Christchurch, Dorset, BH23 1PS
01202 473222

www.aspirearchitects.co.uk
info@aspirearchitects.co.uk

© Aspire Architects Ltd



Aspire Architects

Proposed Site Plan 1:200

