

Section 278, Scale 1:200

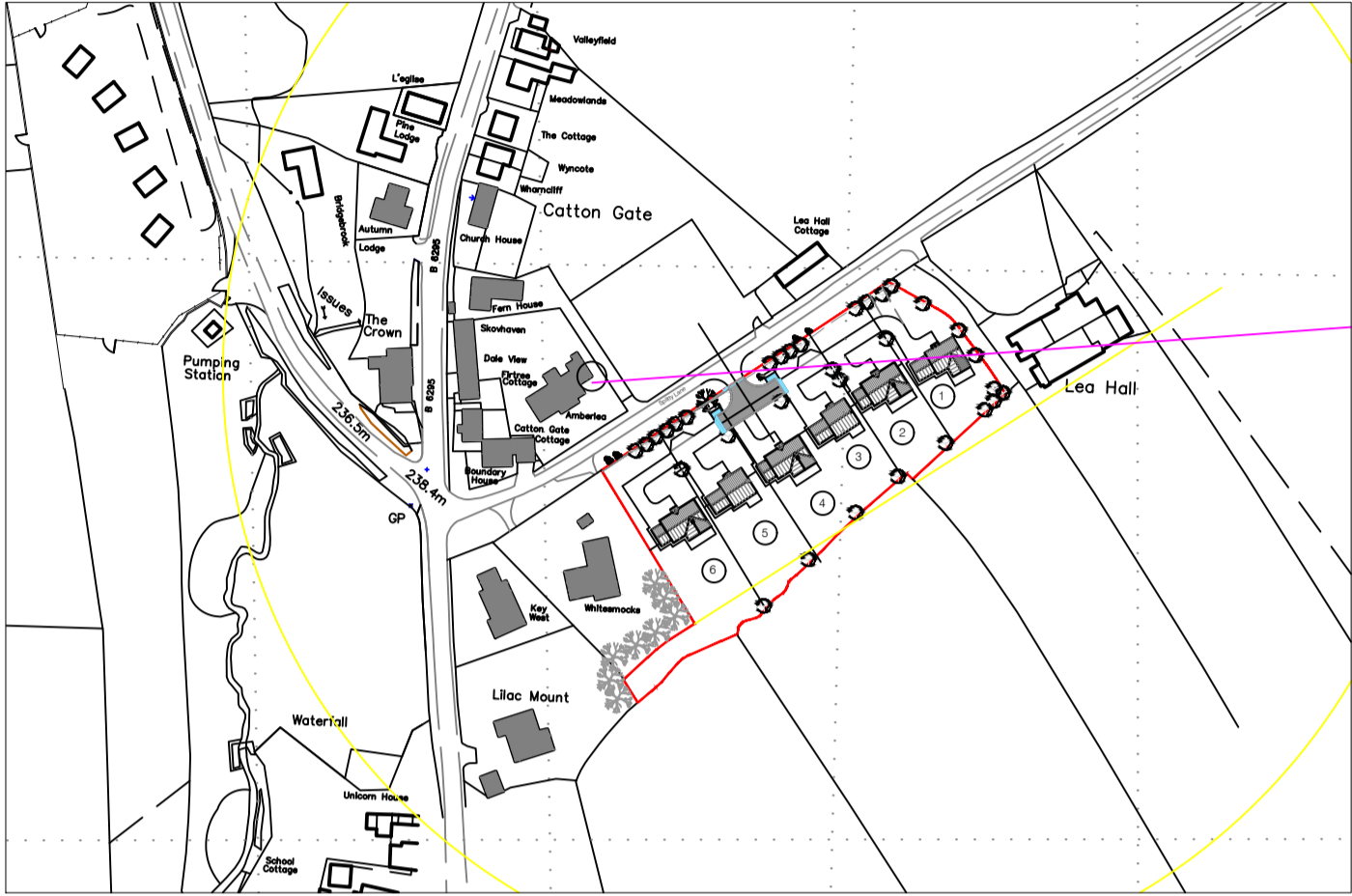

Location Plan, Scale 1:2500



Notes
 All work in the public highway to be carried out in accordance with the Northumberland County Council Specification for Highways Work to to the satisfaction of the highway authority. The Contractor shall be responsible for temporary traffic control, to be agreed with the highway authority.

- Existing highway boundary.
- NCC Type B vehicle crossing, keyed into existing carriageway in accordance with detail.
- Culverted ditch, 450mm diam. minimum crushing strength 54KN/m to enable access to properties and prospectively adoptable highway. The culvert shall be installed at an even grade equal to the average gradient of the ditch and shall extend a minimum of 0.5m beyond the vehicle crossing.

Rev.	Date	Revisions	Drawn
A	19 Nov 22	Footways removed and kerbing altered to suit.	CWT



+44 (0) 7411 751 693
 www.dynamictransportplanning.co.uk
 enquiries@dynamictransportplanning.co.uk

Client
 Stonedale Developments Limited

Project
 Proposed Residential Development,
 Splitty Lane, Allendale, Northumberland,
 NE47 9DP

Drawing Title
 S278 Drawing

Date 19 Nov 22	Scale @ A1
Drawn CWT	Approved GS

Drawing Number DTP/3704922/SK001	Rev. A
--	------------------