

KEY:

- Plot DC5 Site Boundary
- Reinforced Concrete - Located in Service yards
(See Engineer Specifications for full details)
- Tarmac - Located on Roads / Car Park
(See Engineer Specifications for full details)
- Permeable Block Paving
Located Car Parking Bays
Product Name: Hydropave 240
Supplier: Tobermore
Colour: Bracken or similar approved.
Laying Pattern: Staggered Pattern
Set 90 degrees to parking bay edge
Size: 240 x 120 x 80mm)
- Tarmac
Colour: Black
PC Kerb edged
Located on Footpaths

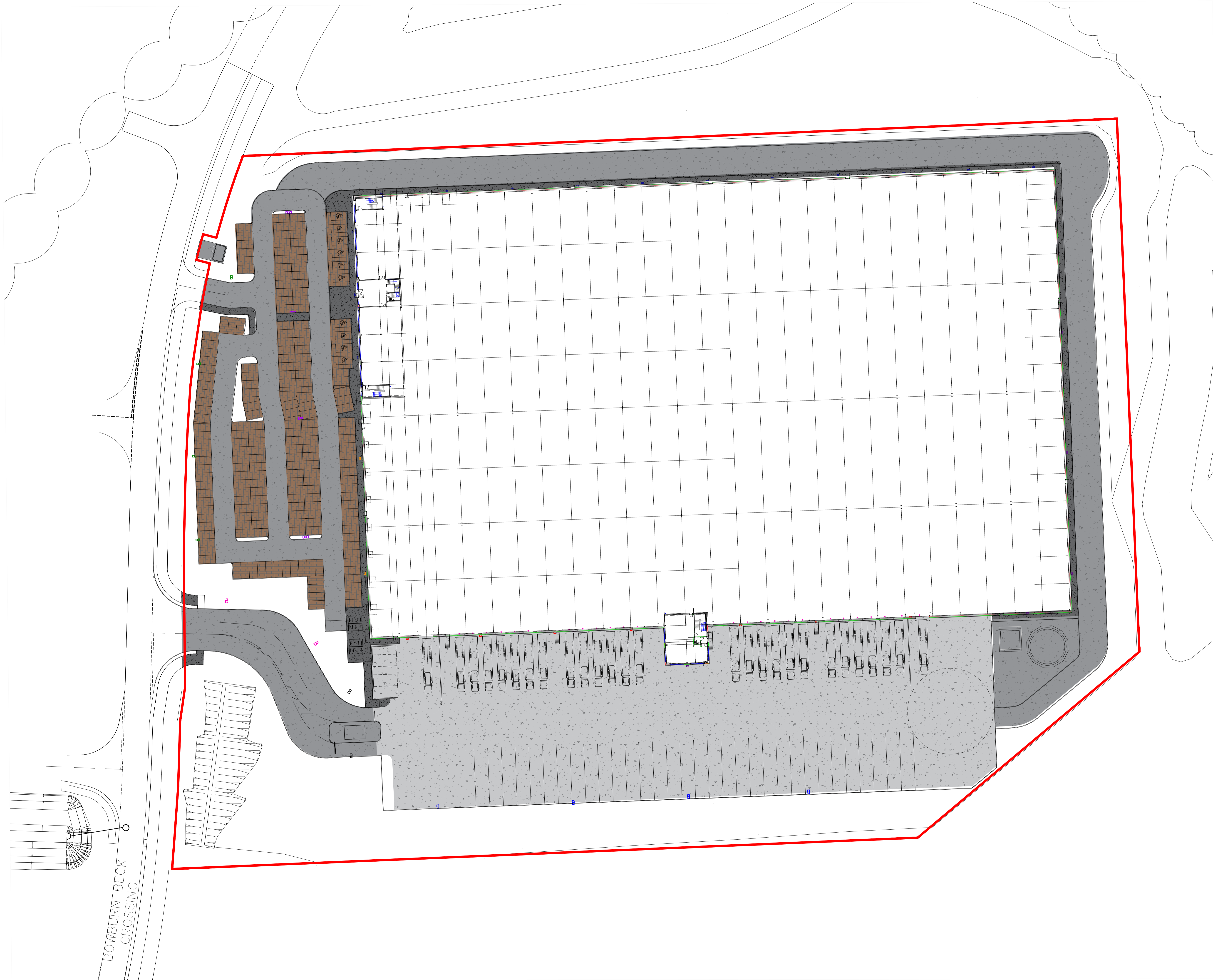

HARD LANDSCAPE NOTES
 All detailed hard surface information is to be built up to required depths set out by the project engineer and reviewed to ensure sufficient construction requirements are achieved. For specific build up and kerb requirements to specified products please see supplier technical information and relevant BS requirements. All Kerbs and Edging to be used when necessary where there is a change in surface. Any additional safety attenuation fencing should be confirmed by the drainage and CDM coordinator to ensure sufficient safety measures are in place and included within the drainage design information.

A	REV	DATE	NOTE	JB	CW
		07.03.23	Updated to revised Redline boundary		
				JB	CW
				Drawn	Chkd

CONSTRUCTION ISSUE



TITLE
**Integra 61, Bowburn - Parcel DC5
 Hard Surface Plan**

CLIENT
Integra 61(Durham) Ltd

SCALE	DATE	DRAWN	CHK'D
1:500@A1	APR 2022	CW	CW
DRAWING NUMBER	REVISION		
5725.DC5_HSP.2.0	A		