

**ROAD MARKING SPECIFICATION**

**Road Markings**  
Road markings will generally be made of thermoplastic material, unless otherwise agreed with the highway authority.  
Road markings should be reflectorised with solid glass beads, conforming to BS EN 1423 and Appendix 12.3.  
In addition to SHW, road markings shall also comply with the performance requirements of BS EN 1871 and BS EN 1436 when requested by the highway authority, materials shall undergo a road trial in accordance with BS EN 1824 and have attained a roller class P1.

In general white and yellow road markings should have the following minimum performance standards as defined in BS EN 1436:

Property	BS Ref.	Class	Value
Luminance	Table 5	B2	$\rho_{\geq} 0.30$
Skid Resistance	Table 7	S2	SRT $\geq 50$
Retro-Reflectivity	Table 2	Dry R2	$R_L \geq 100$
Retro-Reflectivity	Table 2	Wet RW1	$R_L \geq 25$
Retro-Reflectivity	Table 2	Rain RR1	$R_L \geq 25$

Property	BS Ref.	Class	Value
Luminance	Table 5	B1	$\rho_{\geq} 0.20$
Skid Resistance	Table 7	S1	SRT $\geq 45$
Retro-Reflectivity	Table 2	Dry R1	$R_L \geq 80$

**YELLOW ROAD MARKING**

**WHITE ROAD MARKING**

**Road Marking Removal**  
Existing road markings that require removal, shall be removed mechanically. All arising should be removed during the process. Removal using hot compressed air should not be used.

**ROAD MARKINGS SCHEDULE**

Diag No	Line Length	Gap Length	Width	Colour	Description
1003.1	1.0m	1.0m	0.2m	White	Give away line at roundabout
1003.4	Various			White	Miniroundabout
1004	4m	2m	0.1m	White	Centre of carriageway
1025.1	2 No.	n/a	Varies	Yellow	Bus cage markings
1040	4m	2m	0.1m	White	Edge of carriageway at a road junction
1040.2	4m	2m	0.1m	White	Edge of carriageway at a road junction
1049	Continuous		0.15m	White	Boundary of cycle lane
1057	Various			White	Cycle lane

**TRAFFIC SIGNS SCHEDULE**

Sign Ref	Diagram No.	Sign Width (mm)	Sign Height (mm)	X' Height (mm)	Reflector Class	Illuminated	Minimum Horizontal Clearance (mm)	Minimum Vertical Clearance (mm)	Post Size and Section (mm)	Foundation Size
RS1	671	600Ø	-	-	Class 1	Yes	500	2100	76.1 x 3.2 CHS	600x600x600
RS2	670	600Ø	-	-	Class 1	Yes	500	2100	76.1 x 3.2 CHS	600x600x600
RS3	671	600Ø	-	-	Class 1	Yes	500	2100	76.1 x 3.2 CHS	600x600x600
RS4	670	600Ø	-	-	Class 1	Yes	500	2100	76.1 x 3.2 CHS	600x600x600
RS5	674	600	780	-	Class 1	Yes	500	2100	76.1 x 3.2 CHS	600x600x600
RS6	675	600	780	40/50	Class 1	Yes	500	2100	76.1 x 3.2 CHS	600x600x600
RS7	674	600	780	-	Class 1	Yes	500	2100	76.1 x 3.2 CHS	600x600x600
RS8	675	600	780	40/50	Class 1	Yes	500	2100	76.1 x 3.2 CHS	600x600x600
RS9	7014	850	390	75	Class 1	No	500	2100	2no. 76.1 x 3.2 CHS	600x600x600
RS10	7014	850	390	75	Class 1	No	500	2100	2no. 76.1 x 3.2 CHS	600x600x600
RS10a	7014	850	390	75	Class 1	No	500	2100	2no. 76.1 x 3.2 CHS	600x600x600
RS11	611.1	600Ø	-	-	Class 1	Yes	500	2100	76.1 x 3.2 CHS	600x600x600
RS12	611.1	600Ø	-	-	Class 1	Yes	500	2100	76.1 x 3.2 CHS	600x600x600
RS13	611.1	600Ø	-	-	Class 1	Yes	500	MOUNTED ABOVE RS8	76.1 x 3.2 CHS	600x600x600
RS14	670	600Ø	-	-	Class 1	No	500	2100	MOUNTED TO LAMP POST	-
RS15	670	300Ø	-	-	Class 1	No	500	2100	76.1 x 3.2 CHS	600x600x600
RS16	670	300Ø	-	-	Class 1	No	500	2100	76.1 x 3.2 CHS	600x600x600
RS17	618	480	480	-	Class 1	No	500	2100	MOUNTED TO LAMP POST	600x600x600

**NOTE:** ALL HIGHWAY SIGNS SHALL BE MICRO-PRISMATIC (DIAMOND GRADE) WITH A CLEAR DISTANCE OF 450 mm FROM THE EDGE

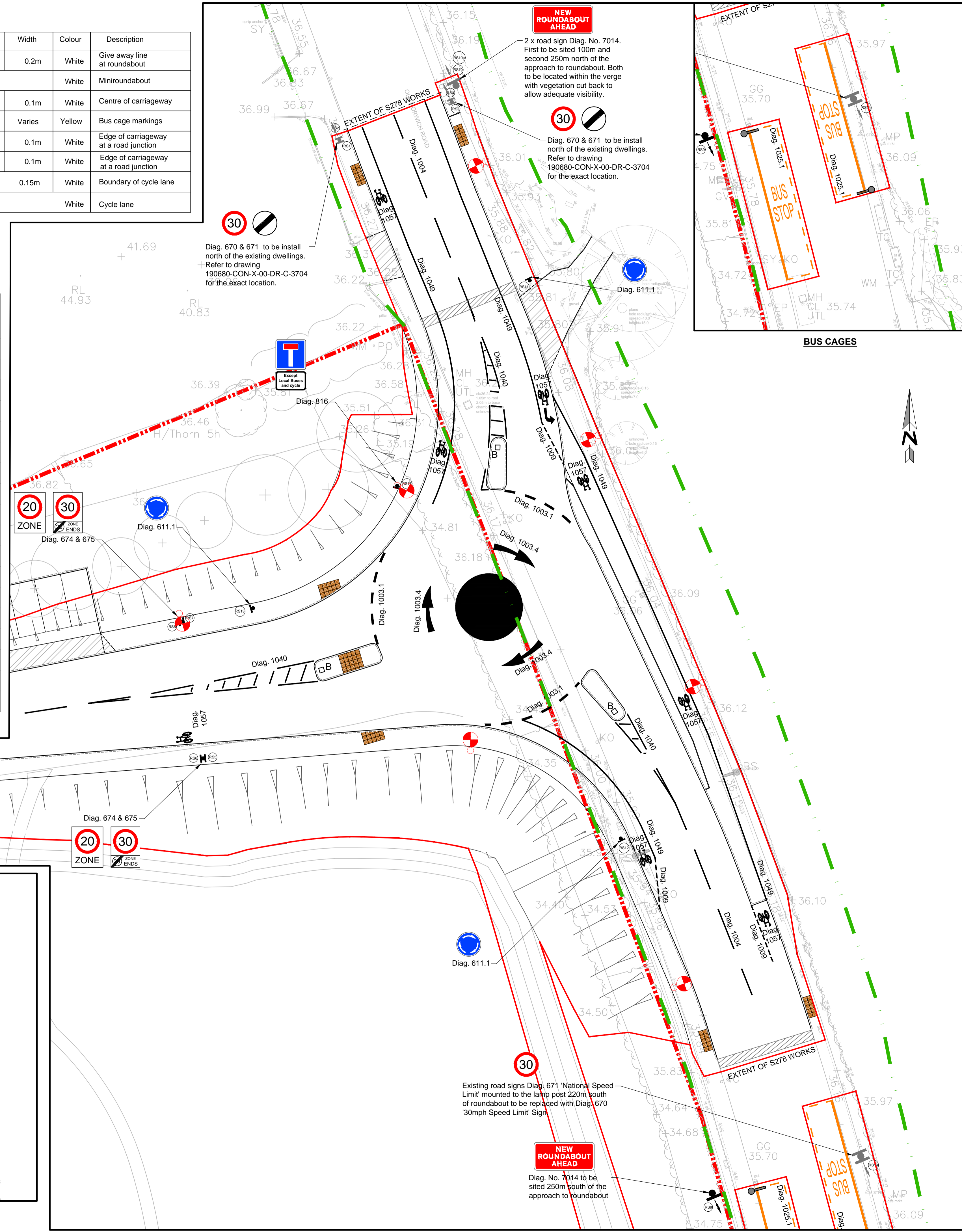

**GENERAL NOTES**

- THIS DRAWING IS TO BE READ IN CONJUNCTION WITH ALL RELEVANT ARCHITECTS, ENGINEERS AND SPECIALIST DRAWINGS AND SPECIFICATIONS
- DO NOT SCALE FROM THIS DRAWING IN EITHER PAPER OR DIGITAL FORM. USE WRITTEN DIMENSIONS ONLY.
- FOR TOPOGRAPHICAL SURVEY REFER TO SURVATEC LIMITED DRAWING NUMBER DW2020-469 DATED 24.02.2020.
- ALL ROAD SIGNS AND ROAD MARKINGS TO BE IN COMPLIANCE WITH THE 'TRAFFIC SIGNS REGULATIONS AND GENERAL DIRECTIONS 2016'.
- REFER TO DRAWING 190680-CON-X-00-DR-C-3704 FOR FULL SCALE ROAD SIGN LAYOUT

**LEGEND**

	Site boundary
	Highway boundary
	Extent of S278 Works

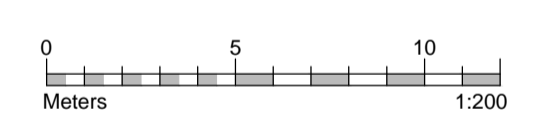
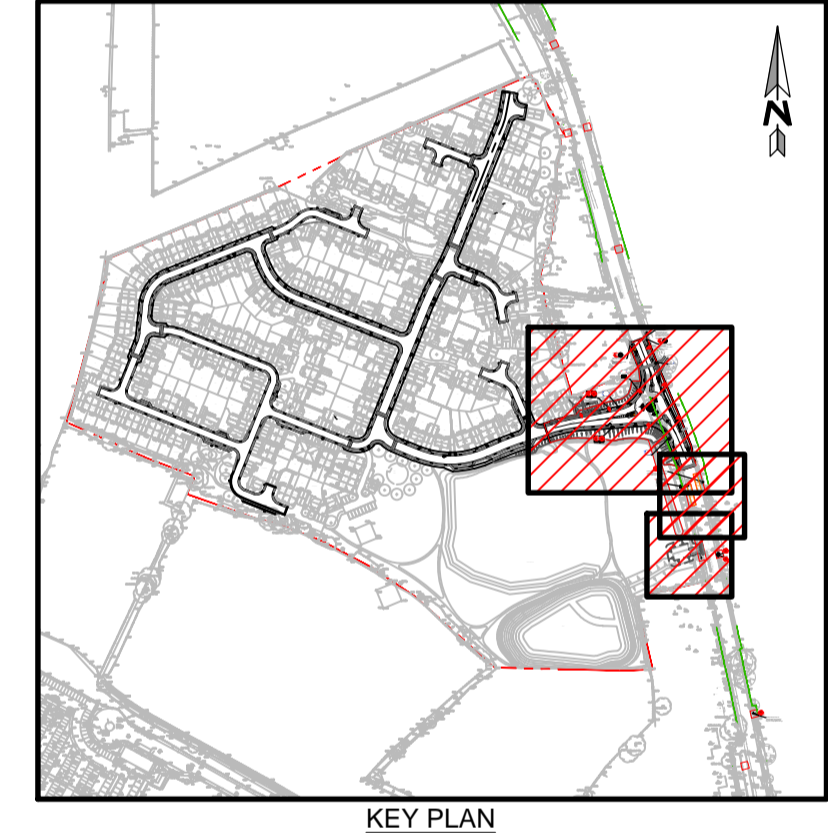

C3	16.03.21	ROAD SIGNS LOCATIONS REVISED	MS	JW
C2	25.02.21	ROUNDABOUT REALIGNMENT	MS	JW
C1	01.02.21	CONSTRUCTION HANDOVER	MS	JW

**conisbee** Consulting Structural Engineers  
Consulting Civil Engineers  
London • Cambridge • Norwich  
1-5 Offord St London N1 1DH  
Telephone 020 7700 6666  
www.conisbee.co.uk

<b>Drawing Status</b>	
<b>CONSTRUCTION</b>	
Project	Date NOW 2020
OLD NORWICH ROAD WHITTON, IPSWICH	Scale 1:200@A1
Drawn MS	Engineer JW
Title	Project No
S278 WORKS SIGNAGE AND ROAD MARKINGS	190680
Drawing No	Revision
190680-CON-X-00-DR-C-3703	C3