

REVISION 'A' 08/02/23  
 UPDATED TO MATCH REDESIGN  
 AND STRUCTURAL ENGINEER  
 CALCULATIONS

REVISION 'B' 12/01/23  
 - UPDATED TO MATCH REDESIGN

REVISION 'B' 17/01/23  
 - SHOPFRONT RAISED

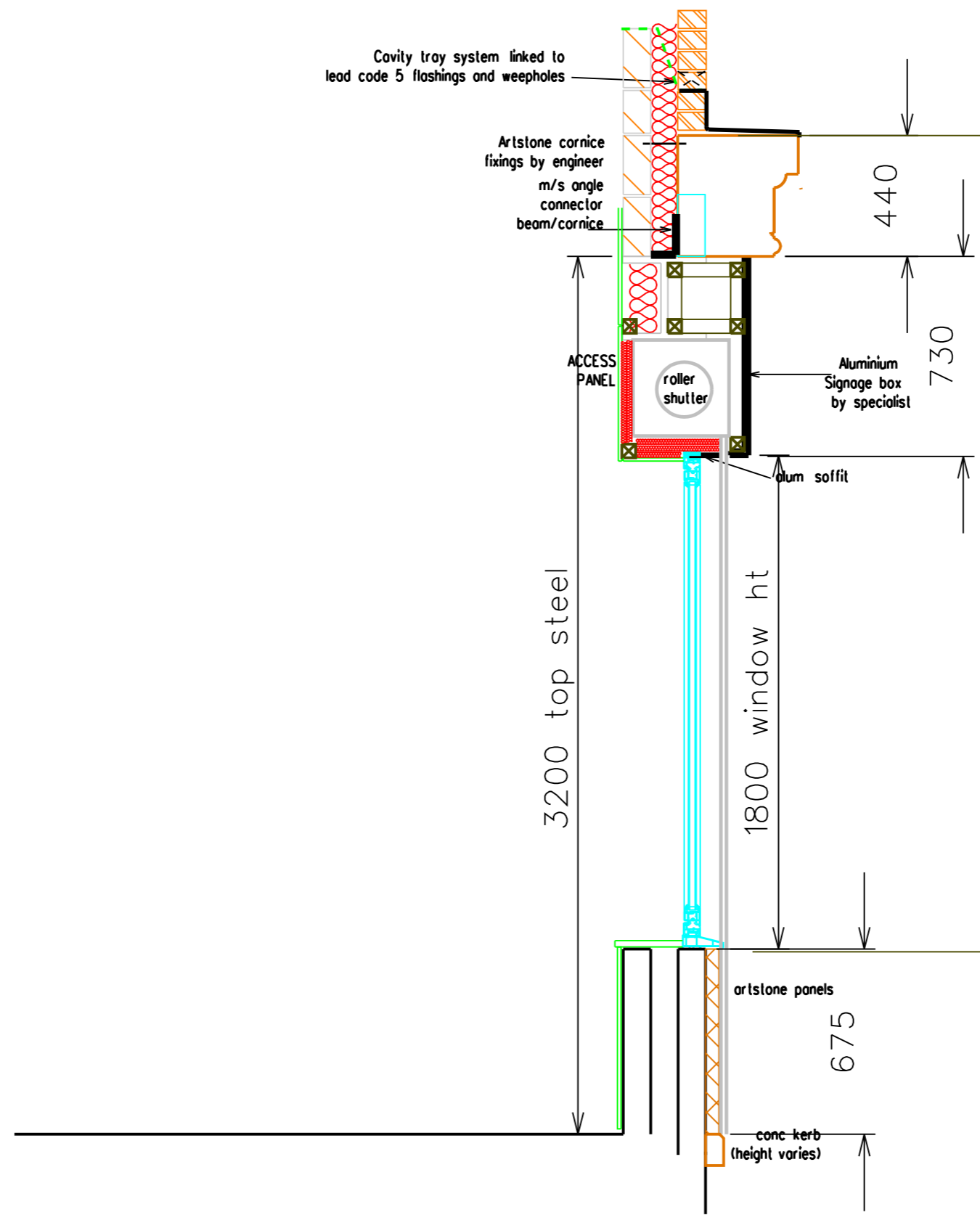

REVISION	NOTH
C	

STAGE: TENDER

PROJECT  
 EXTENSIONS TO YOBEN'S  
 FISHERIES  
 SUNDERLAND ROAD,  
 HORDEN, PETERLEE.  
 SRB 4PF

DRAWING  
 PROPOSED SHOPFRONT SECTION

PROJECT NO.	DRAWING NO.	REVISION
3394	F-13	C
DATE	SCALE	DRAWN BY
SEP '21	1:100A1 1:200A3	BAS

MARIO MINCHELLA ARCHITECTS

MARIO MINCHELLA ARCHITECTS  
 UNIT 4, WITNEY WAY,  
 HI-TECH VILLAGE,  
 HOLLOW BUSINESS PARK,  
 TINE AND NEAR  
 HEDDIE  
 T: 0191 3882227  
 M: 07538 814141  
 E: INFO@M-M-A.NET

THIS DRAWING IS  
 COPYRIGHT OF  
 MMA

NOT TO BE SCALE  
 ALL DIMENSIONS TO  
 BE CHECKED ON SITE