

This arable field has planning approval for a residential development of 37 dwellings (including 11 affordable housing units adjacent to this property)

BURY ROAD

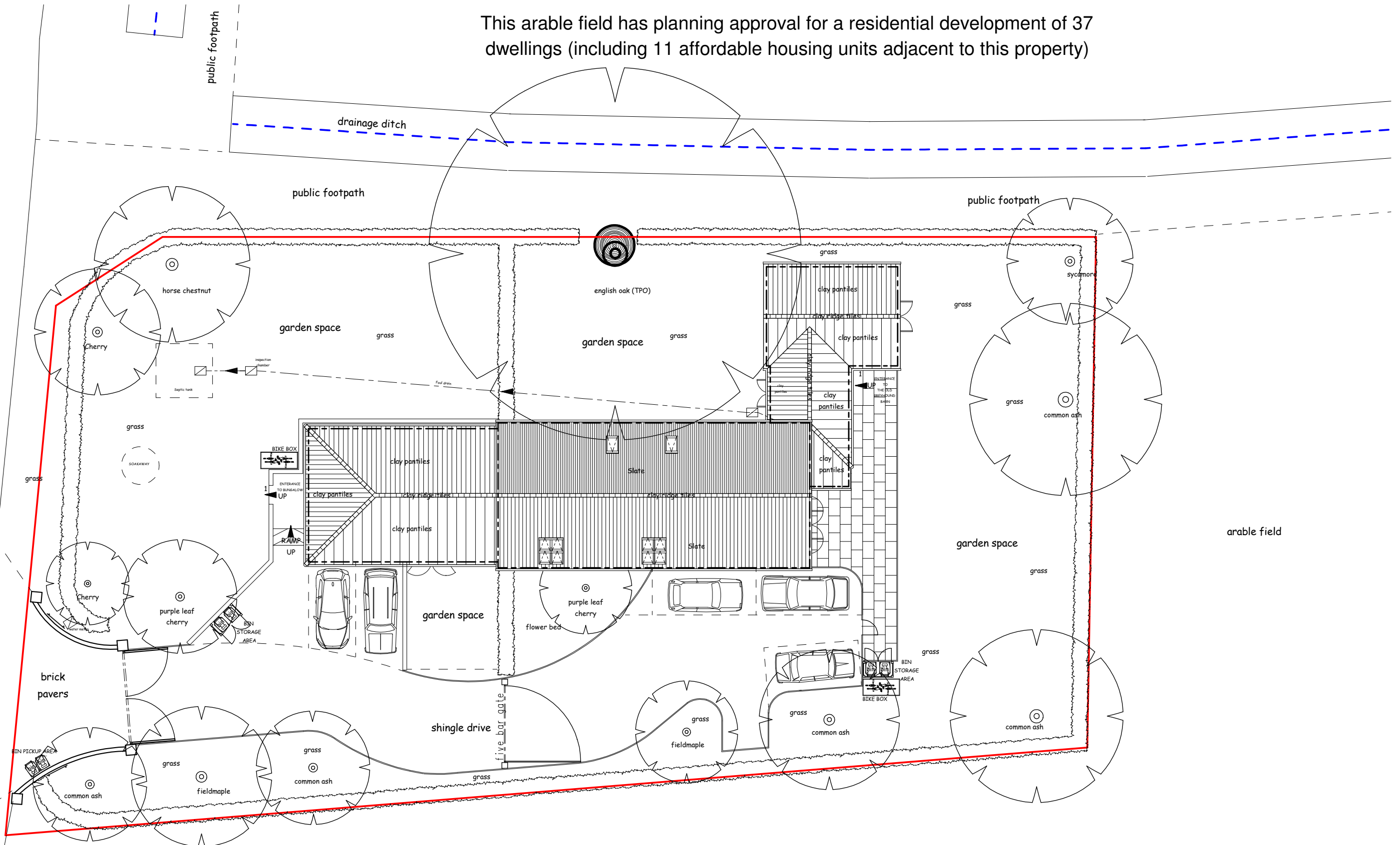

PROPOSED BLOCK PLAN

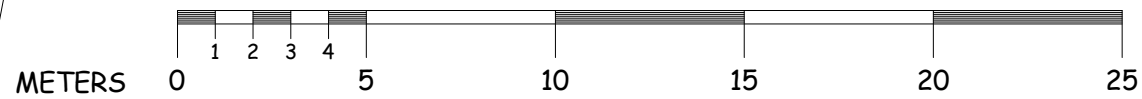

Revell Architecture & Engineering
 'The Old Greyhound Barn', Bury Road, Hopton, Suffolk, IP22 2NU
 Tel: 01953 666760 Fax: 01953 688139
 enquiries@revell-arch-eng.co.uk
 www.revell-arch-eng.co.uk

Client: Mr Paul Hounslow
 Project: Convert Office and Storage Barn into a Two-Bedroom Single storey Dwellings and a Three Bedroom Two Storey Dwelling in the original Barn at: - 'The Old Greyhound Barn', Bury Road, Hopton, DISS, Suffolk, IP22 2NU
 Drawing: PROPOSED BLOCK PLAN

Drg No: 2812-F-05 Rev: - Scale: 1:200@ A3 Date: February 2023

© Copyright of drawing rests with Revell Architecture & Engineering. Any discrepancy must be reported to Revell Architecture Engineering immediately. All dimensions to be checked on-site by Contractor(s). DO NOT scale from drawing.