

DISCLAIMER:
Intervention Architecture Ltd retain the copyright to this drawing. It may not be reproduced or copied without prior consent.

SAFETY, HEALTH & ENVIRONMENTAL INFORMATION
In addition to the hazards/risks normally associated with the types of work detailed on this drawing, note the following risks and information.

- CONSTRUCTION:**
- Working from height
 - Maintenance
 - Heavy lifting
 - Falling material
 - Protecting boundaries/glass below
- DEMOLITION:**
- Asbestos removal
 - Heavy lifting
 - Falling material

Risks listed here are not exhaustive. It is assumed that all works will be carried out by a competent contractor working, where appropriate, to an approved method statement.

SCALE:

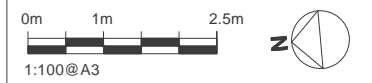

KEY:

Boundary outline - - - - -

KEY PLAN:

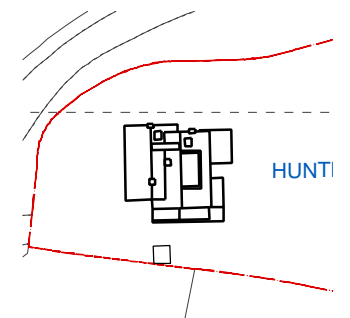

REVISIONS:

REV:	DATE:	DESCRIPTION
-	26.12.2022	PLANNING ISSUE
A	28.03.2023	REVISED PLANNING



**Intervention
Architecture**

hello@interventionarchitecture.com
www.interventionarchitecture.com
Unit 12 Arthaus, 80-82 Floodgate St, Birmingham, B5 5SR

Intervention Architecture Ltd. Company Registration No. 9364941 Registered Office: Jaguar House, Cecil Street, Birmingham, B193ST.
Copyright © Intervention Architecture Ltd 2021

DRAWING TITLE:

PROPOSED FIRST FLOOR PLAN

DRAWING NO: 1232_101_A

DATE: 06.12.2022 **SCALE: 1:100@A3**

ADDRESS: HUNTERS MEAD, THROCKING ROAD, SG9 9RB

CLIENT: [REDACTED]

PLANNING ISSUE ONLY - NOT FOR CONSTRUCTION