

NO DIMENSIONS TO BE SCALED FROM THIS DRAWING

This document references the following file:-

Reference Name	Status	Revision
PC-XX-XX-M3-Designer-0001_5915		P01.1

Revisions	Date	Drawn /	Chk'd
P01	28/02/23	AO /	LG
P02	29/03/23	AO /	LG
		submission	

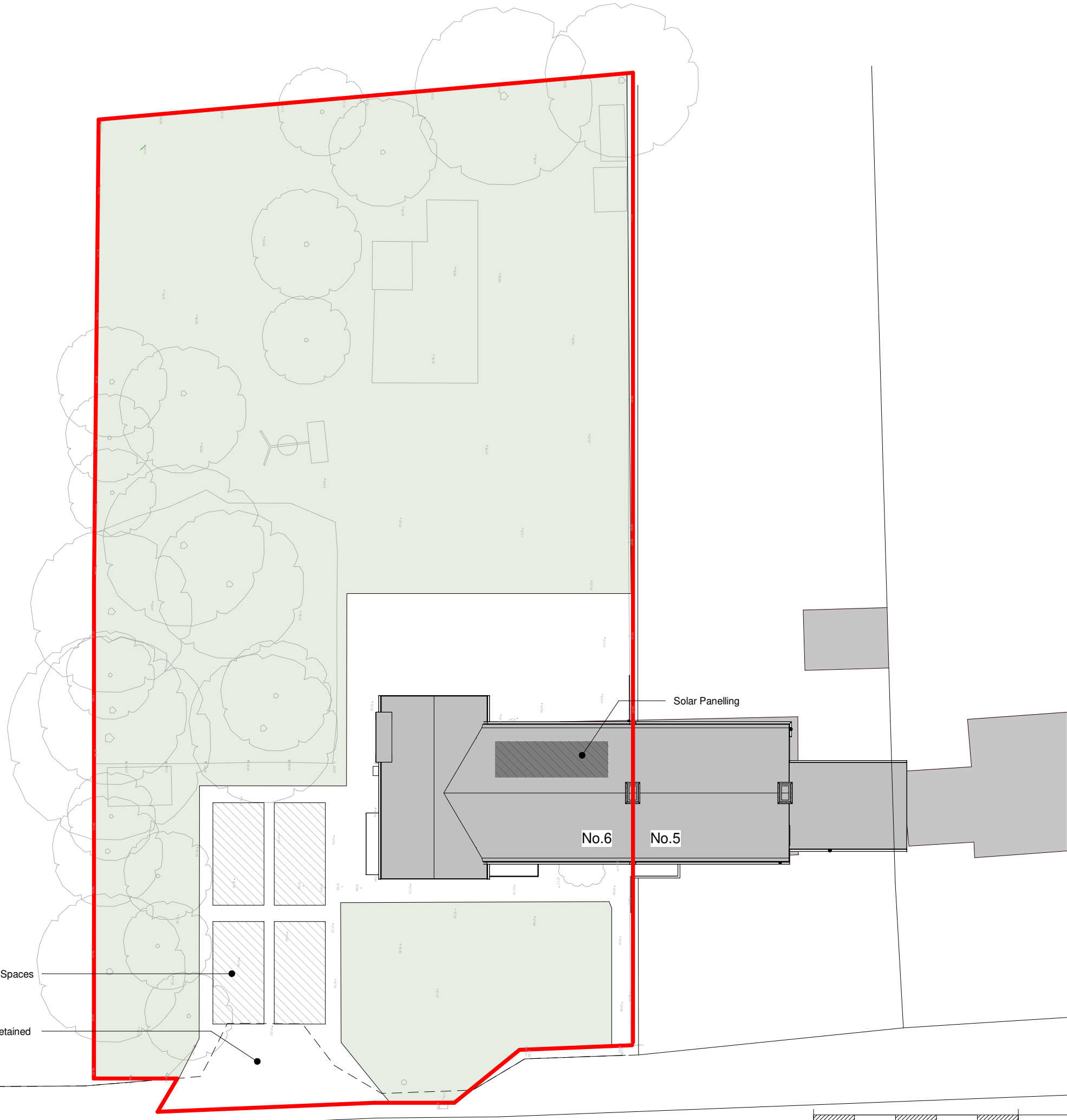

Client

Kat and Fiona Parsons

Project

Extension and internal alterations to 6 White Gate Cottages, Helmingham Road, Gosbeck IP69RZ

Title

Block Plan as Proposed

Project N^o Drawing N^o Revision

5915 - 0102 P02

Scale - unless otherwise stated Issued For

1 : 200 @ A3 PRELIMINARY

BS 1192 Ref. Status

PC-Designer-0102



KLH
The Old Steelyard
Poplar Lane
Sproughton
Ipswich
IP8 3HL
t: 01473 689 532
www.klharchitects.com

Block Plan as Proposed
1 : 200

Helmingham Road

0 10 20
Metres
1 : 200