

TOWN FOOT

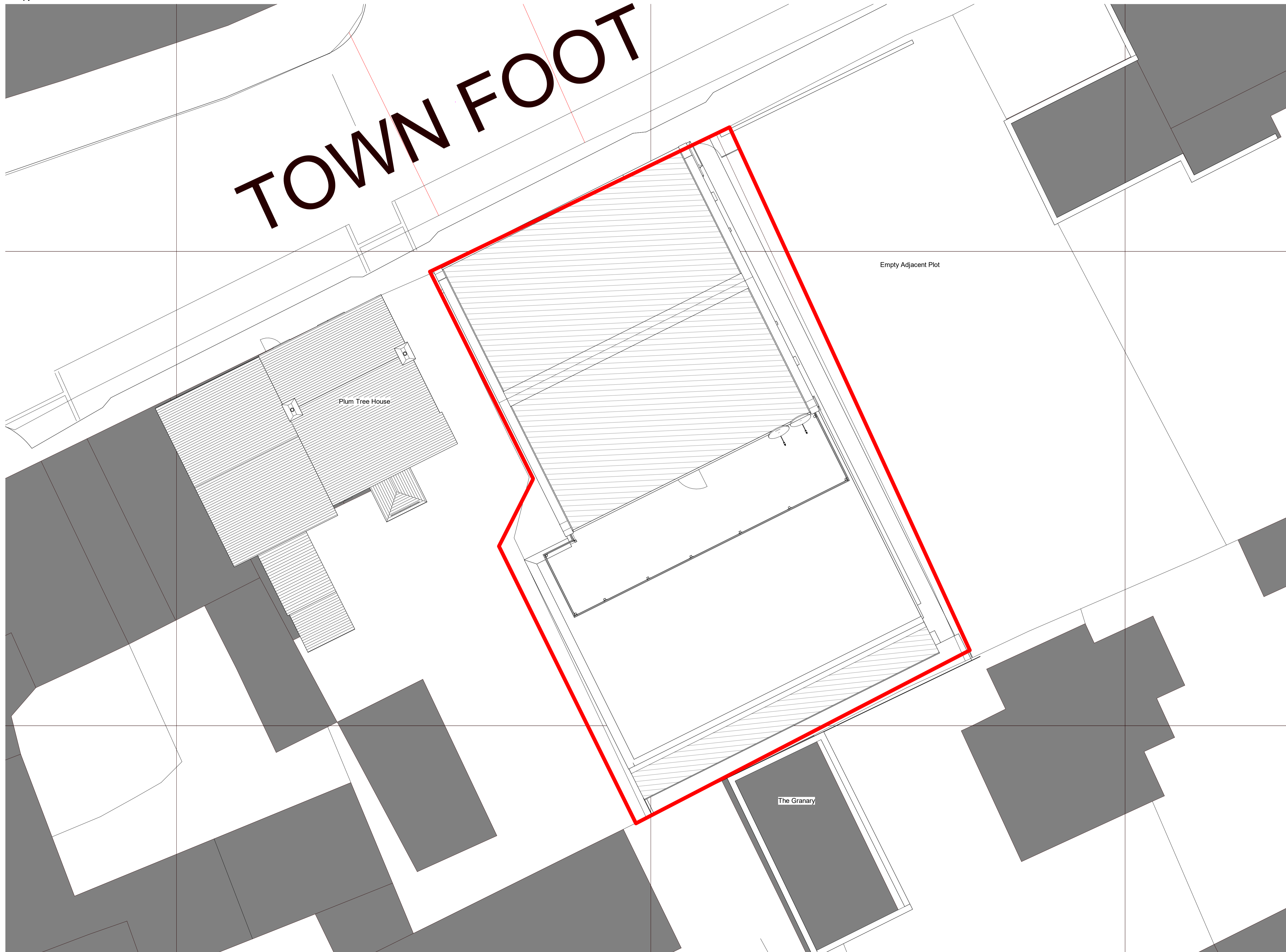

GENERAL NOTES

1. This drawing is copyright and must not be reproduced without the consent of GDL Architecture
2. All Dimensions are in millimeters unless otherwise note.
3. Do not scale from this drawing - If in doubt ask
4. All dimensions to be checked on site prior to commencement of work or preparation of shop/fabrication drawings.
5. The contractor will report any discrepancies in information in writing to the design team at the earliest opportunity.
6. This drawing is to be read in conjunction with the following relevant information:
 - i. All architects, structural and services engineer's drawings and specifications.
 - ii. All CDM information including designers risk assessments.

NOTES

KEY

— Site Boundary

Please refer to Highways Works Plan ref. 21016-GDL-A1-00-DR-A-2106 for proposed off site highways works

REVISIONS

C02	Drawing updated following highways comments	21/03/2023
C01	Construction Issue	04/11/2022
P08	Dimensions to east boundary shown.	28/10/2022
P07	Drawings updated following DTM.	12/08/2022
P06	Site boundary updated to reflect deeds	06/05/2022
P05	Issued in building regulations application	21/03/2022
P04	Second EV Space added	22/12/2021
P03	Planning Issue incorporating feedback from client.	20/08/2021
P02	Planning issue incorporating planning consultant's comments.	05/08/2021
P01	Planning Issue	30/07/2021

Rev	Description	Date
-----	-------------	------

CLIENT
SANSEC DEVELOPMENTS

gdlarchitecture
Unit 4, Woods Pottery, Stepney Bank, Newcastle NE1 2NP
tel. (0191) 447 1775 www.gdlarchitecture.co.uk

PROJECT
Town Foot Co op
Rothbury, Building Shell

TITLE
Proposed Site Plan

SCALE (@ A1) 1 : 100	PROJECT NUMBER 21016	
DRAWN BY JWT	CHECKED BY DAS	DATE 21/03/2023
DRAWING NUMBER 21016-GDL-A1-00-DR-A-2002	REV C02	
Drawing Status Construction	Status A1	

Do not scale. This drawing is copyright

Proposed Site Plan
1 : 100