

THIS DRAWING TOGETHER WITH THE DESIGN IS
COPYRIGHT OF THE ARCHITECT.
FIGURED DIMENSIONS SHOULD BE FOLLOWED
AND SCALED DIMENSIONS SHOULD BE CHECKED
WITH THE ARCHITECT.
ANY DISCREPANCY MUST BE REPORTED TO THE
ARCHITECT IMMEDIATELY AND PRIOR TO
PROCEEDING.

REVISIONS
A 25.03.23 - Planning application
B 27.03.23 - Planning application

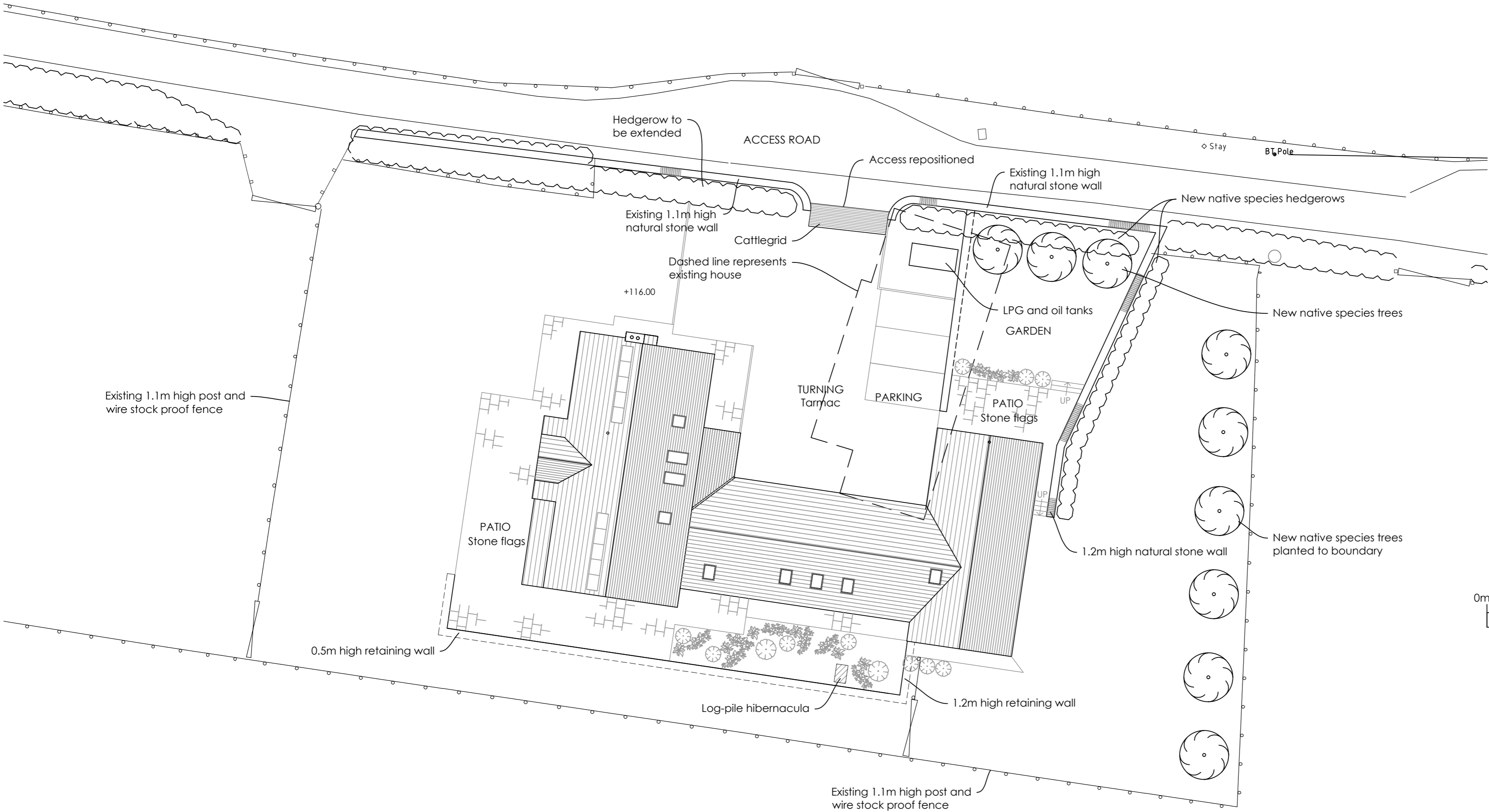

HEDGE PLANTING
Hedge species planting to provide screening to minimise visual impact.
Native hedge - minimum plant size 2 + 1yr bare rooted age range.
Planted in 2 x staggered rows at a rate of 6 plants per meter.

Approximate linear meterage: 47m

Native hedge mix:
70% Hawthorne (40-60cm tall, 2 years old)
20% Blackthorn and a 10% mix of crab apple, Dog Rose, Field Maple, Guelder Rose and Hazel.

The ground should be prepared by the screening back of any vegetation prior to planting.
Planting within the site should be within topsoil to a made-up depth of 300mm if existing ground conditions do not include sufficient topsoil. This topsoil should be to specification BS3882:2007, standard grade.

All plants should be protected by appropriate guards, i.e. Plantec shrub guards staked with 2 x bamboo canes of Tubex 0.6m Easywrap guards staked with 1 x bamboo cane.

PROVISION OF LOG-PILE HIBERNACULA THAT WILL PROVIDE REFUGE FOR A RANGE OF WILDLIFE, INCLUDING SMALL MAMMALS AND AMPHIBIANS
Artificial hibernacula can provide refuge for a range of wildlife. One log-pile hibernacula would be installed within the proposed copse. Hibernacula come in a range of different designs but the principle is to construct a loose pile of logs, bricks, rocks or rubble and loosely filled/cover with turf and topsoil, this provides refuge for reptiles and amphibians in both summer and winter. This can be above the surface or within an excavation.

PLANTING OF NEW TREES WITH INDIGENOUS SPECIES
The planting of new trees allows birds new foraging and nesting opportunities. Current landscape and garden plans will enhance the foraging and nesting opportunities for birds and provide shelter for a wide range of fauna.

NEW DRY-STONE WALL AND NATIVE HEDGEROW
Retention and maintenance of the field boundary walls, and erection of new length of dry-stone wall and native hedgerow will provide the greatest amount of shelter, foraging and nesting opportunities for a diverse range of fauna.



EXAMPLE OF A LOG-PILE HIBERNACULA

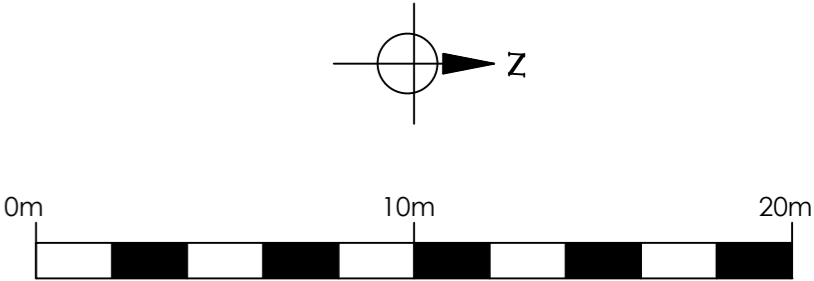

Original Drawn By ACP	Date February 2023
--------------------------	-----------------------



the wright design partnership
15 main street, kirkby lonsdale, cumbria LA6 2AQ
tel / 015242 71697 email / mail@wdparchitects.co.uk

Client Mr & Mrs K Woodhouse			
Contract New Dwelling Westhouse LA6 3PF			
Drawing title PROPOSED SITE & BLOCK PLAN			
Scale 1:200 at A2	Job No. KL2785	Drg No. 03	B