

NOTES:
 - Drawing is copyright of Runcom Architects Ltd.
 - The scale ruler drawn below is a guide; contact Architects for any specific onsite dimensions required not noted in writing on drawing details.
 - It is the responsibility of the Client/ Employer to ensure Architect and Contractor are aware of all known legal issues, covenants, and the location of services (both underground and overhead) prior to each stage of works.

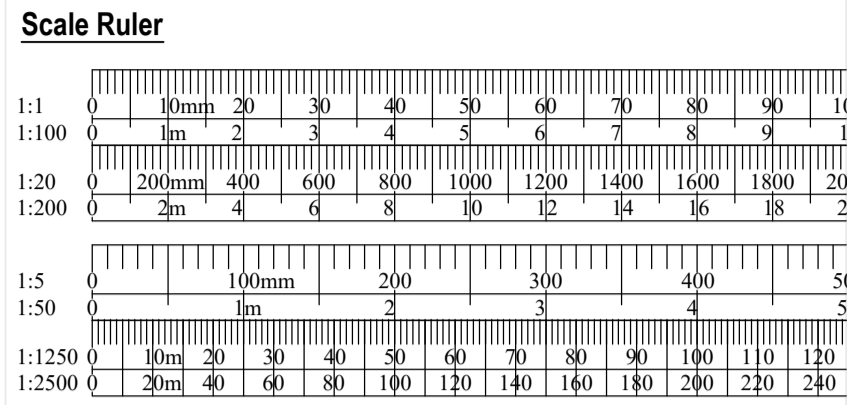

MATERIAL NOTES

Roof:
 House - pantile roof.
 Garage - pantile roof to match existing.

Walls:
 House - brick with hanging tiles in places.
 Garage - brick to match existing house.

Windows & Doors:
 White UPVC windows and doors to match existing.

Rainwater Goods:
 White UPVC gutters and downpipes to match existing.

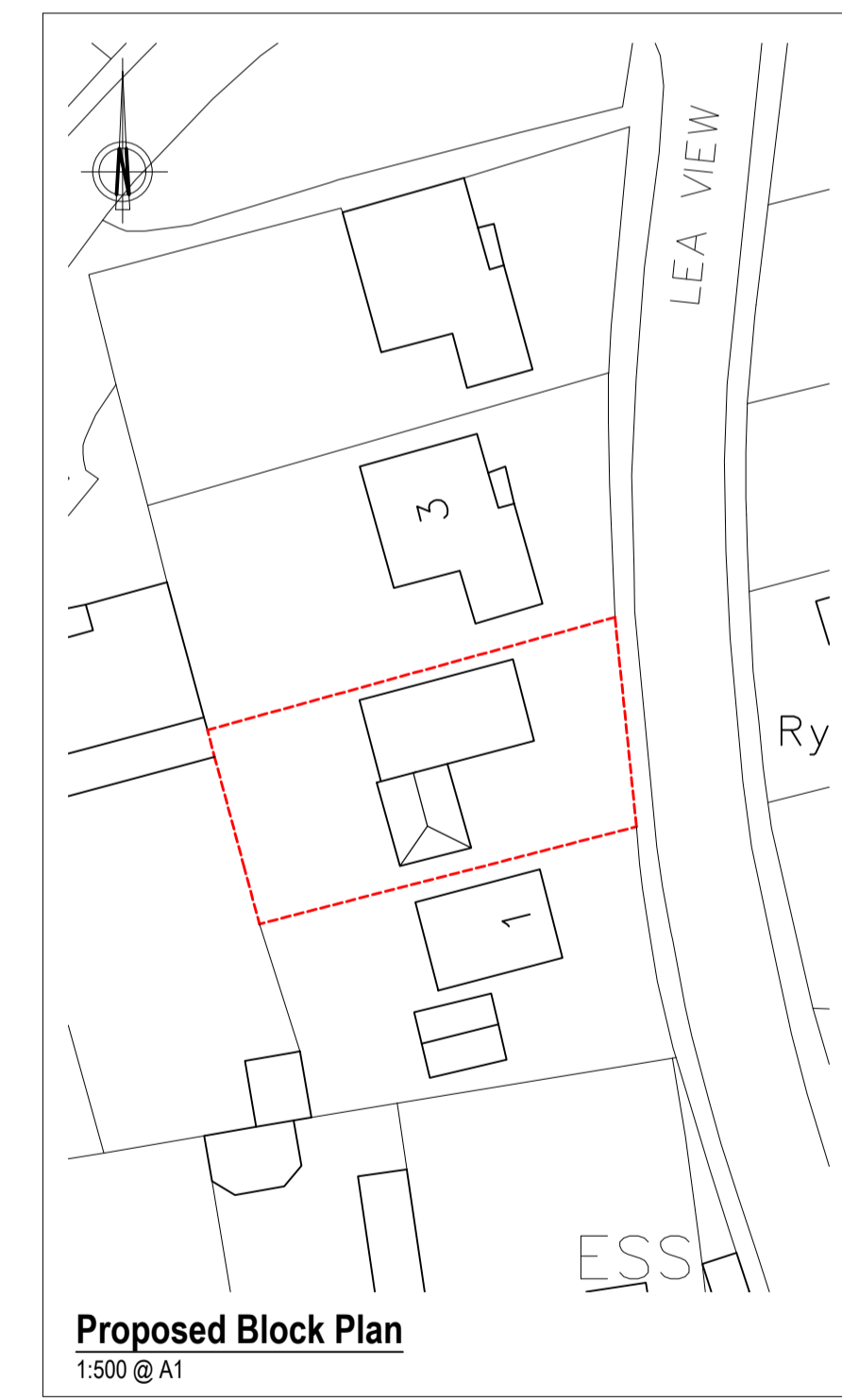
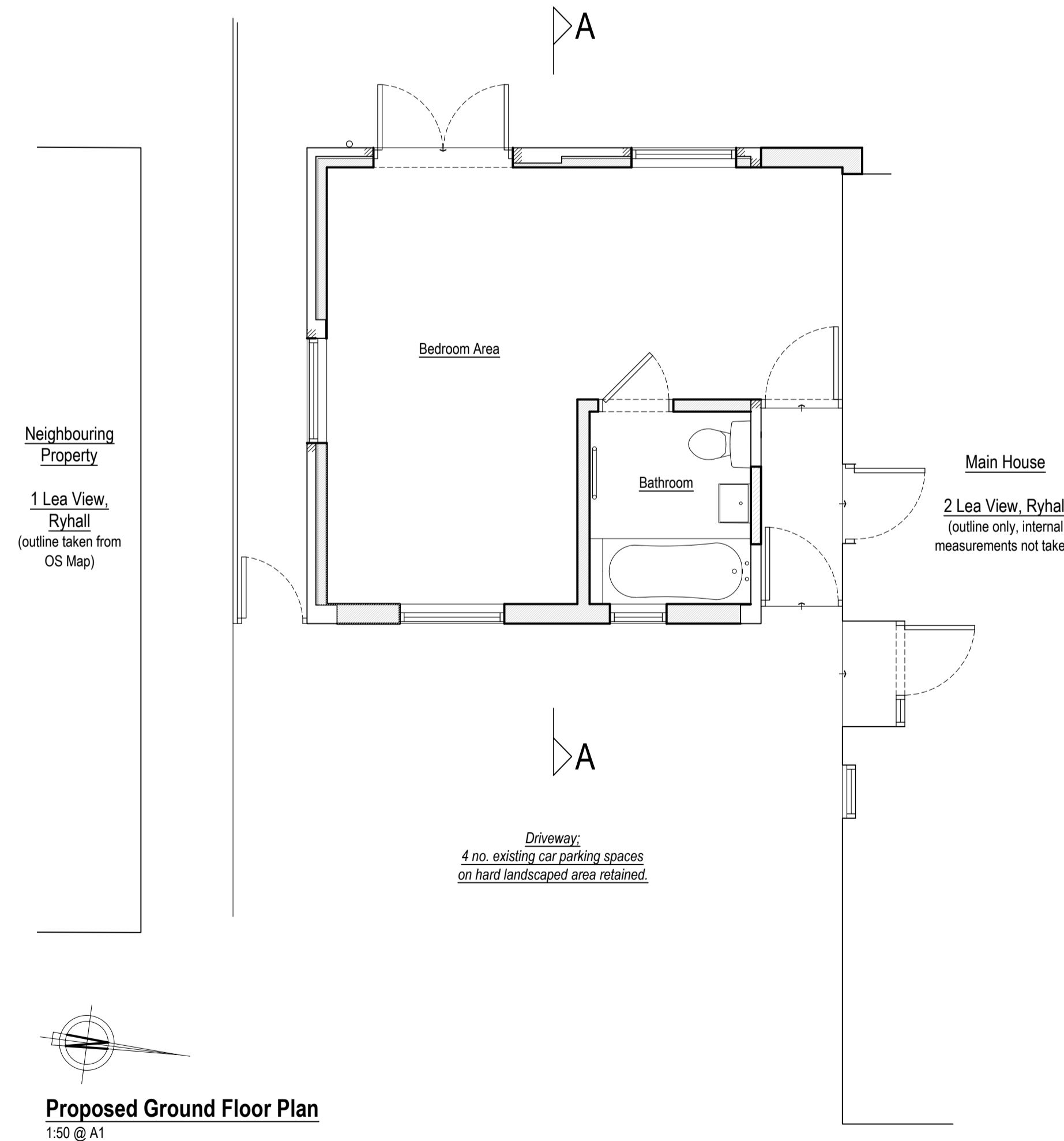

REVISION	DATE	DESCRIPTION
a.	16.04.23	Text corrected re: height increase of eaves - TR

RUNCORN
 architects

www.runcornarchitects.co.uk
 01572 842115
 tom@runcornarchitects.co.uk

CLIENT
Mr & Mrs Avery

PROJECT
 Proposed Works at;
 2 Lea View, Ryhall,
 Stamford. PE9 4HZ

SCALE & PAPER
 1 : 50, 100 & 500 @ A1

DATE
 November 2022

DRAWING TYPE & DETAILS
 Planning Drawing;
 Proposed Elevs, Plans & Section

DRAWN & CHECKED
 TR

PROJECT REF
2022 / 22

DRAWING NO. & REVISION
03a