

Site plan 1:500

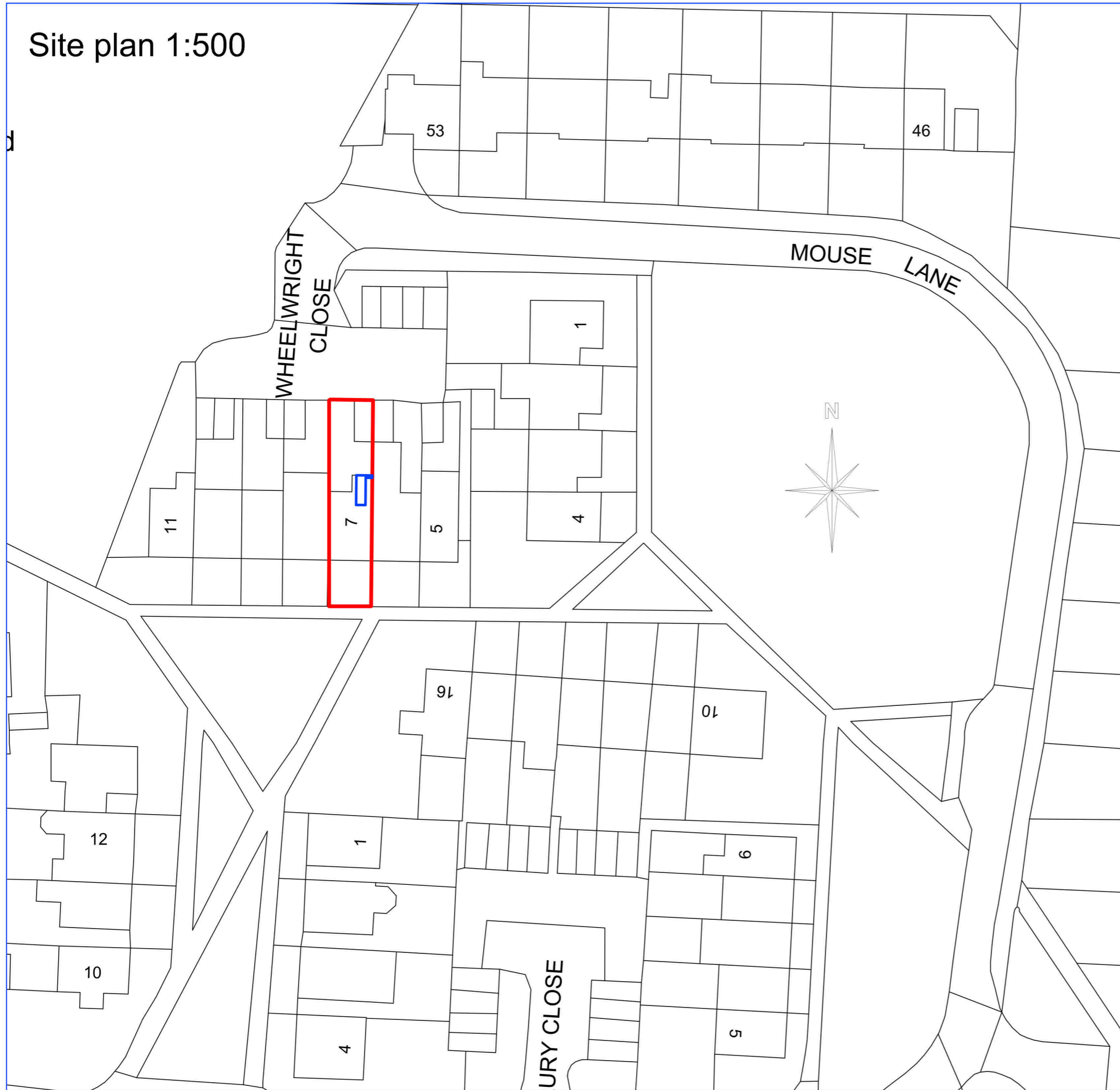

Location plan 1:1250

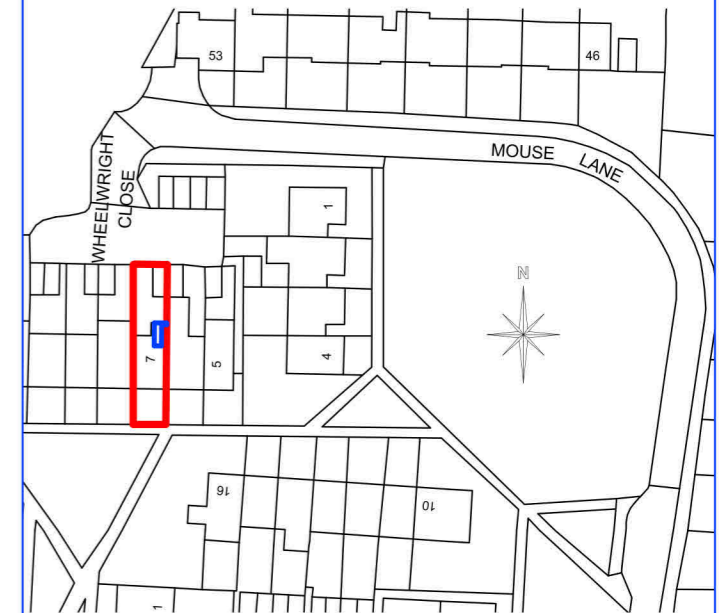

Revisions:
Rev A: ramped added in blue

Client:	Mrs B Beeton
Address:	7 Wheelwright Close, Rougham, IP30 9JD
Project:	Ramped access
Drawn by:	Sarah Dean
Date:	21/03/2023
Ref No:	BEETON-7WHEE-SD
Scale:	1:500 & 1:1250 @ A3