

# Tree Impact Plan

showing surveyed trees, against the planning proposals

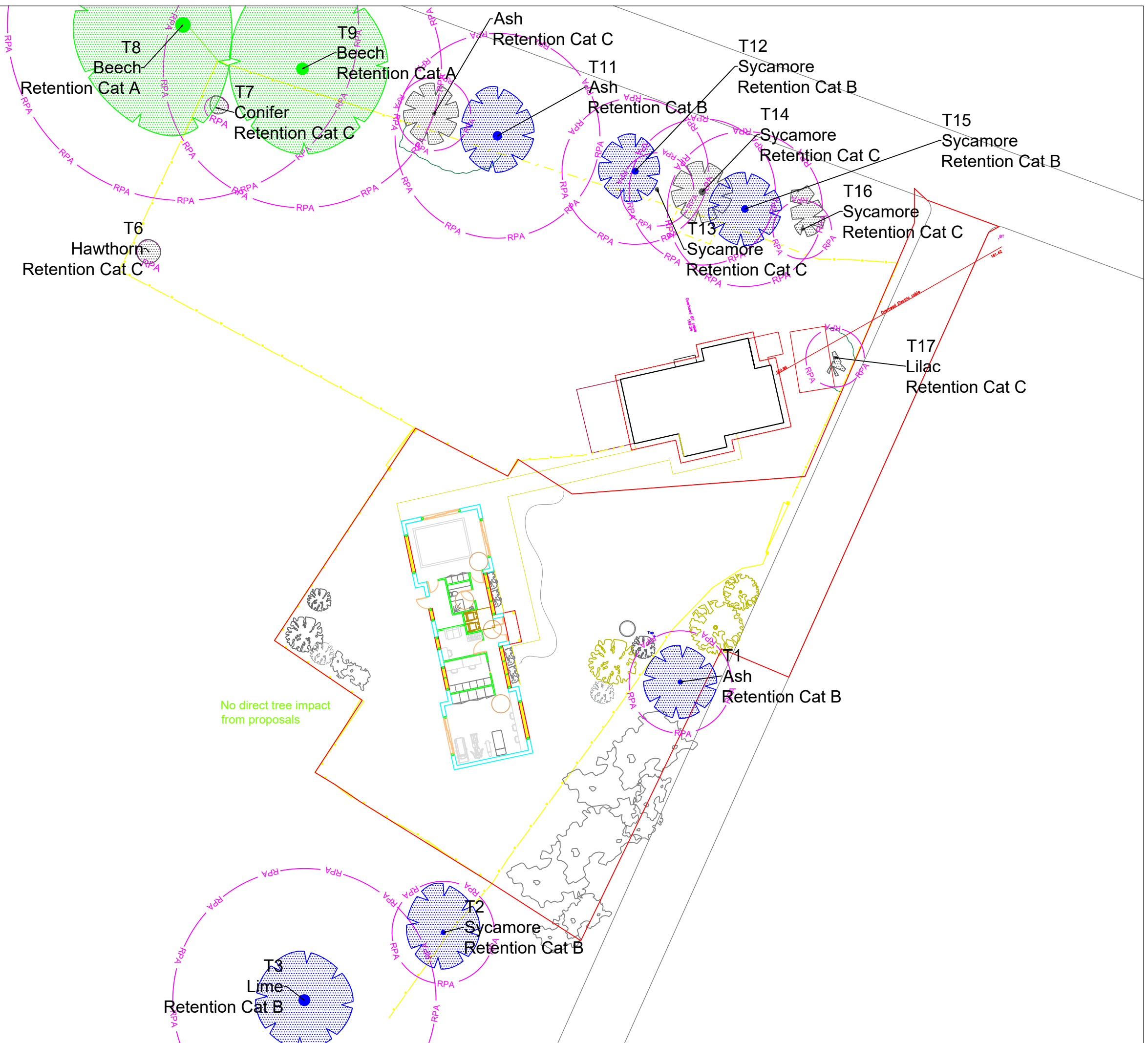

**Example**

- Canopy extent - patterned green line
- Category key - coloured stem
- BS5837:2012 calculated root protection area- Magenta
- Tree No. - tag

Ref. T1

**Category A**

Trees of high quality with an estimated remaining life expectancy of at least 40 years.

**Category B**

Trees of moderate quality with an estimated remaining expectancy of at least 20 years.

**Category C**

Trees of low quality with an estimated remaining life expectancy of at least 10 years, or a stem diameter below 150mm.

**Category U**

Trees in such a condition that they cannot realistically be retained as living trees in the context of the current land use for longer than 10 years.



No.	Revision/Issue	Date
1		
2		

**CRAWSHAW**  
ARBORCARE LTD

ARBORICULTURAL CONSULTANTS  
Celebrating 20 Yrs  
john@crawshawarb.com  
Tel: 0800 6891746

Project Name and Address  
**DRAYTON MANOR LODGE,  
TRING HILL, HP23 4LD**

Project No <b>200149</b>	Sheet 1 of 1
Date <b>2023-03-23 10:48:48</b>	
Scale 1 to 200 at A3	