

Provide at abutment level ventilation openings at least equal to continuous strip running the full length of the abutment and 5mm wide.

Code 4 lead flashing and cavity tray at roof abutments with proprietary top edge ventilation system

Roof space to have 50mm air gap above 120mm of Celotex rigid insulation between rafters and underdrawn with 40mm thermaline plus thermal plasterboard with integral vapour barrier.

Roof finish to be tiles (to match existing) pointed up in coloured mortar (colour to match tile), on 25 x 38mm tanalised SW battens on felt on 175 x 50 C24 jack rafters as shown at max 400c/c's birdsmoothed over wallplate. Rafters strapped to wall below to prevent rafter spread. Rafters doubled up either side of velux windows.

Provide at eaves level ventilation openings at least equal to continuous strip running the full length of the eaves and 25mm wide.

New fascias and gutters to match existing

DPC
1200g continuous DPC min 150 above F.G.L with DPM under ground floor. Cavities filled with weak mix concrete to within 225 of F.G.F.L.

Radon barrier
1200g continuous radon barrier/dpm tucked into dpc and across cavity wall and linked to cavity tray. Cavity tray and weepholes provided above. Joints in the barrier must be sealed and any penetrations.

Note : Roof tiles are to be suitable for the pitch and also have compatibility with the rooflights. Details to be confirmed with BCO prior to ordering by builder.

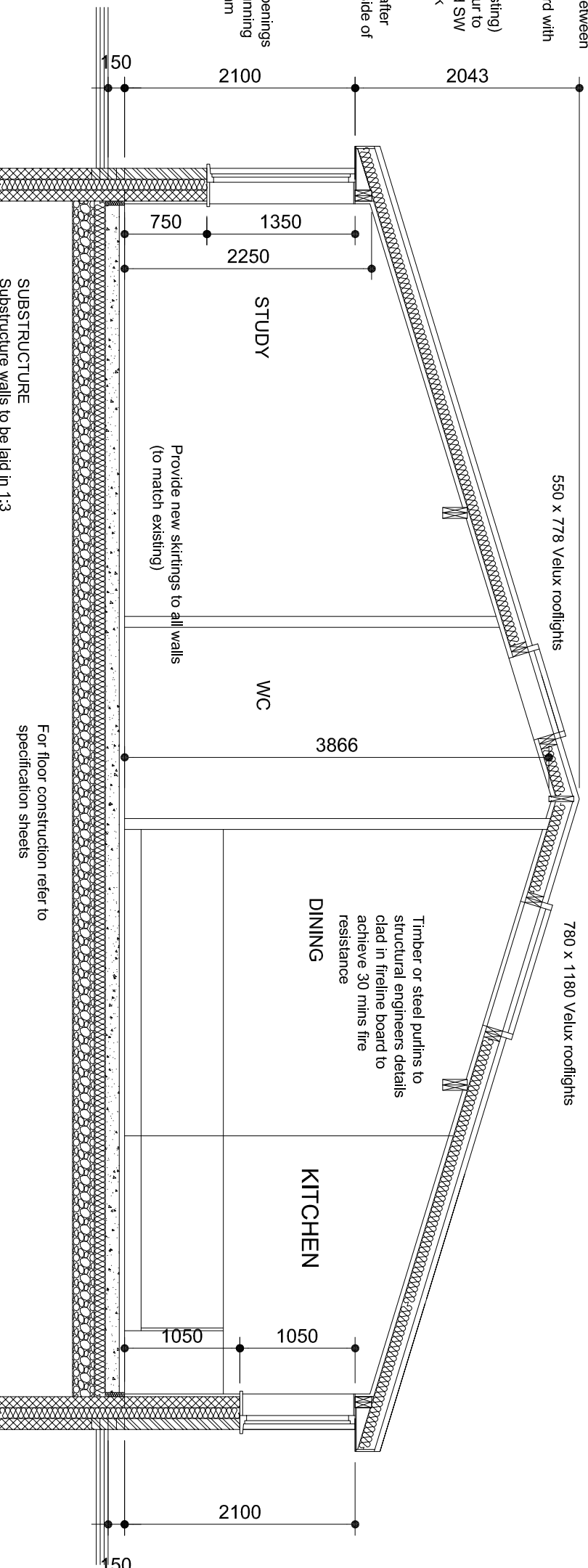

Provide new skirtings to all walls (to match existing)

STUDY

WC

DINING

KITCHEN

Timber or steel purlins to structural engineers details clad in fireline board to achieve 30 mins fire resistance

For floor construction refer to specification sheets

PROPOSED SECTION

SUBSTRUCTURE
Substructure walls to be laid in 1:3 mortar, top 4 courses to be in engineering facing bricks. All cavities to be filled to within 150mm of internal skin dpc
600 x 225 Gen 3 design mix concrete strip footings taken down to a depth agreed with the Building Inspector.

CLIENT Mr and Mrs T Waterfield	DESCRIPTION OF WORKS Proposed single storey side and rear extensions.	
JOB Proposed works to: 40 Savin Close, Cropwell Bishop, Nottingham, NG12 3DZ	SHEET TITLE Proposed section	
RDS Design Services (Bingham) Ltd. 1 Belony Close, Bingham, Notts. NG13 8TP web - www.rdsdesignservices.co.uk email - rdsdesignservices@live.co.uk Office - 01949 838128 Mob - 07980640454		job ref. 22-042
	date Feb 2023	scale 1:50 @ A3
drwg. no. 05		