

1 FIRST FLOOR STAIR PLAN
as Proposed, 1:20

DO NOT SCALE FROM THIS DRAWING EXCEPT FOR PLANNING PURPOSES. ANY DISCREPANCIES ARE TO BE REPORTED TO THE ARCHITECT. THE CONTRACTOR IS TO CHECK ALL BUILDING AND SITE DIMENSIONS PRIOR TO ORDERING MATERIALS OR CONSTRUCTION. THIS DRAWING IS TO BE READ IN CONJUNCTION WITH ENGINEERS' AND OTHER SPECIALISTS' DRAWINGS. COPYRIGHT REMAINS WITH THE ARCHITECT.

REVISIONS
- 29.03.2023 JE PLANNING / LBC

GENERAL NOTES:
Total Rise: 1880mm
Steps: 11no.
Rise per Tread: 171mm
Typ. Going (excl. winders): 235mm

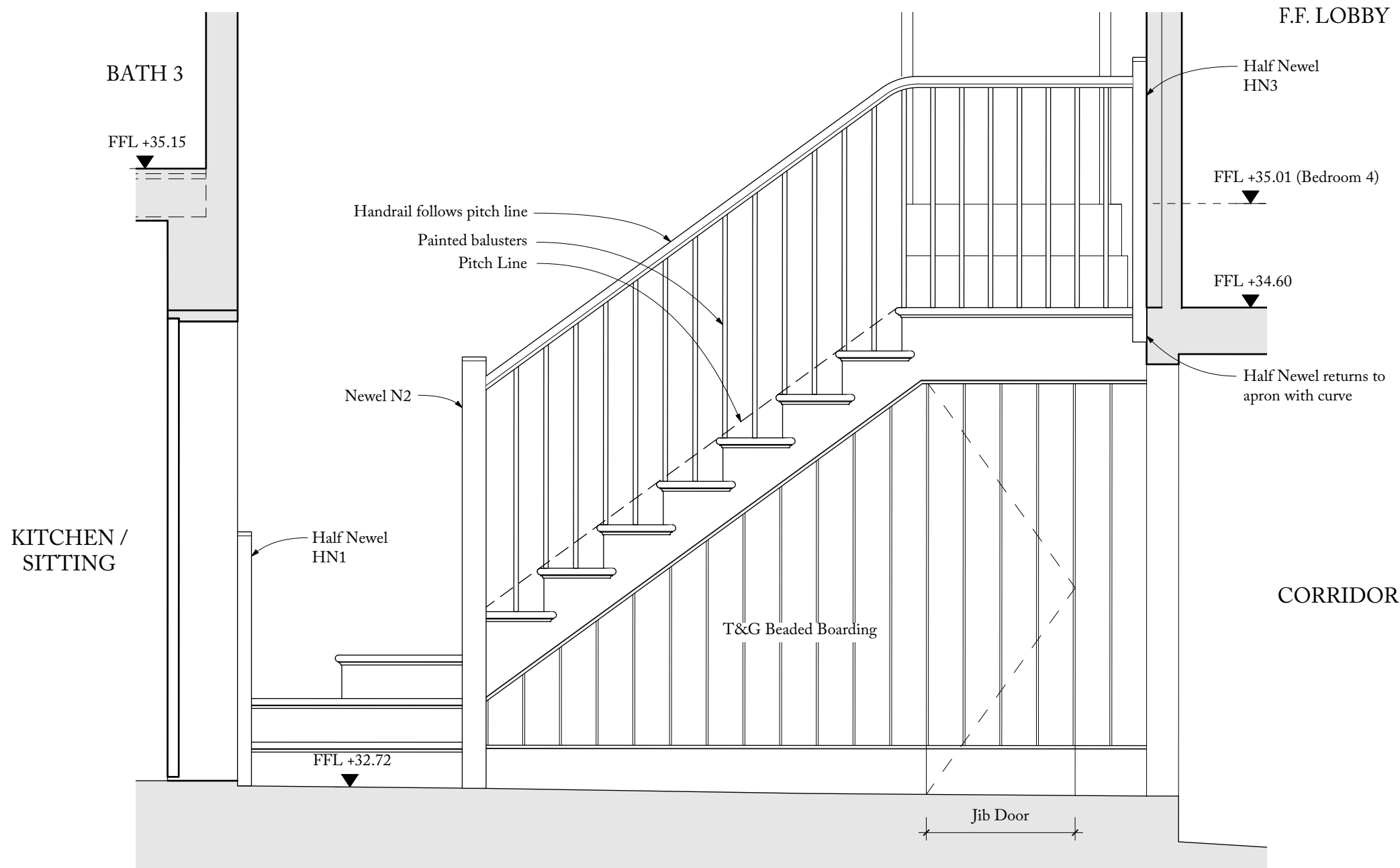

2 STAIR ELEVATION
as Proposed, 1:20

**Hoare,
Ridge &
Morris**
Architects

PROJECT JACKDAWS FORD
Chelworth, Suffolk

DRAWING TITLE PROPOSED
Staircase Details

SCALE 1:20 @ A3

STATUS PLANNING / LBC

DRAWING NO. **210. PL14**

Hoare Ridge & Morris LLP 01728 688747
Building 19
Snape Maltings hrma@hrma.co.uk
Snape
Suffolk IP17 1SP www.hrma.co.uk

Copyright © Hoare Ridge & Morris LLP