

**NOTES:**

- 1. The contents of this drawing are copyright.
- 2. Scaled drawing for Planning purposes only.

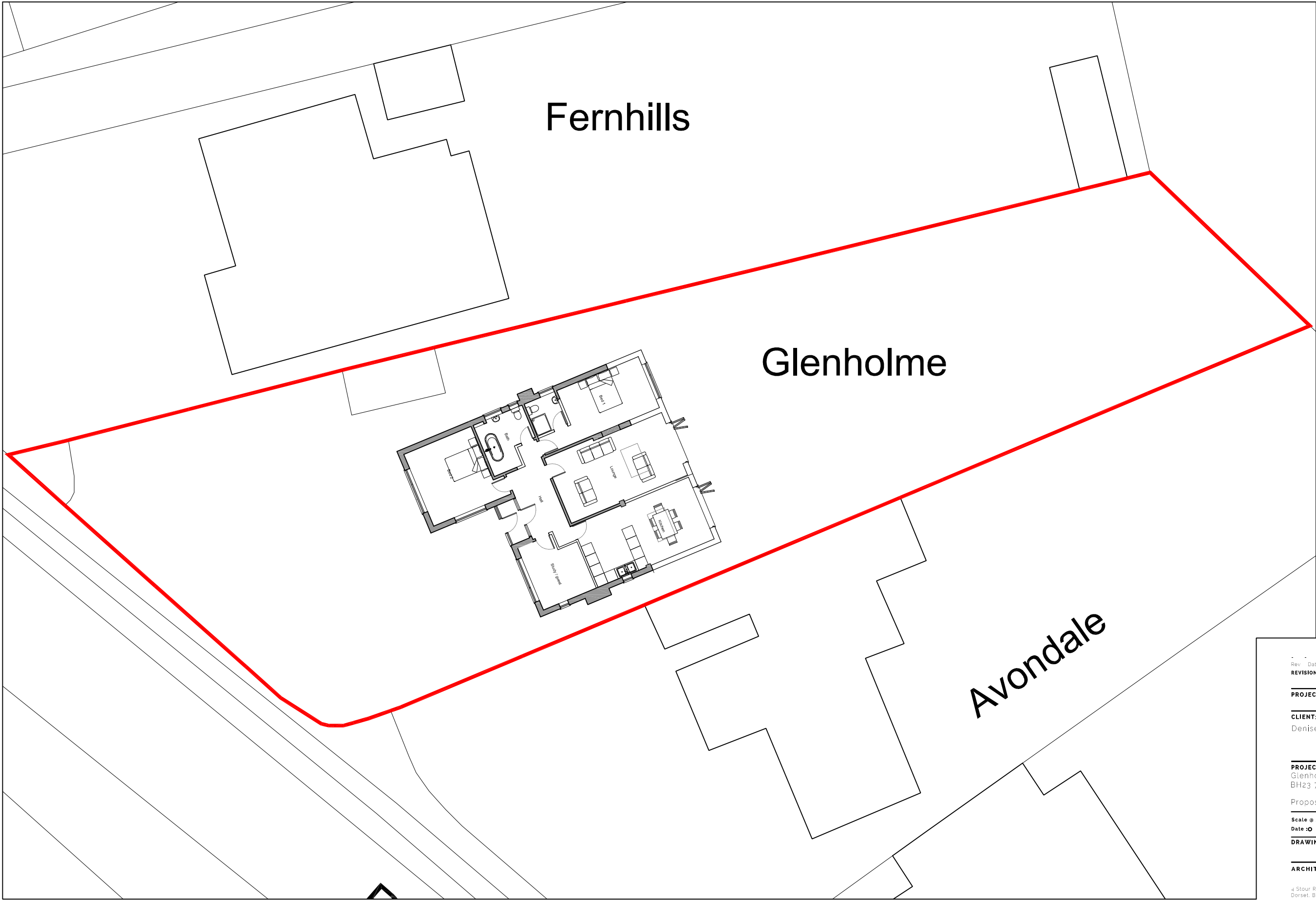

Fernhills

Glenholme

Avondale

Rev	Date	Description	By	PM
<b>REVISIONS:</b>				

**PROJECT STAGE:** Planning

**CLIENT:**  
Denise McDonnell

**PROJECT & DRAWING TITLE:**  
Glenholme, Ringwood Road, Sopley, Christchurch, BH23 7BE

Proposed Site Plan

**Scale @ A3:** 1:200      **Drawn by:** RPA

**Date:** 08/03/23      **DRAWING No:** ASP.23.007.002



**REVISION:**

**ARCHITECTURE - PLANNING - PROJECT MANAGEMENT - CDM**

4 Stour Road, Christchurch,  
Dorset, BH23 1PS  
01202 473222  
www.aspirearchitects.co.uk  
info@aspirearchitects.co.uk  
© Aspire Architects Ltd

