

Tree Protection Plan – Church View, Swaton, NG34 0JR

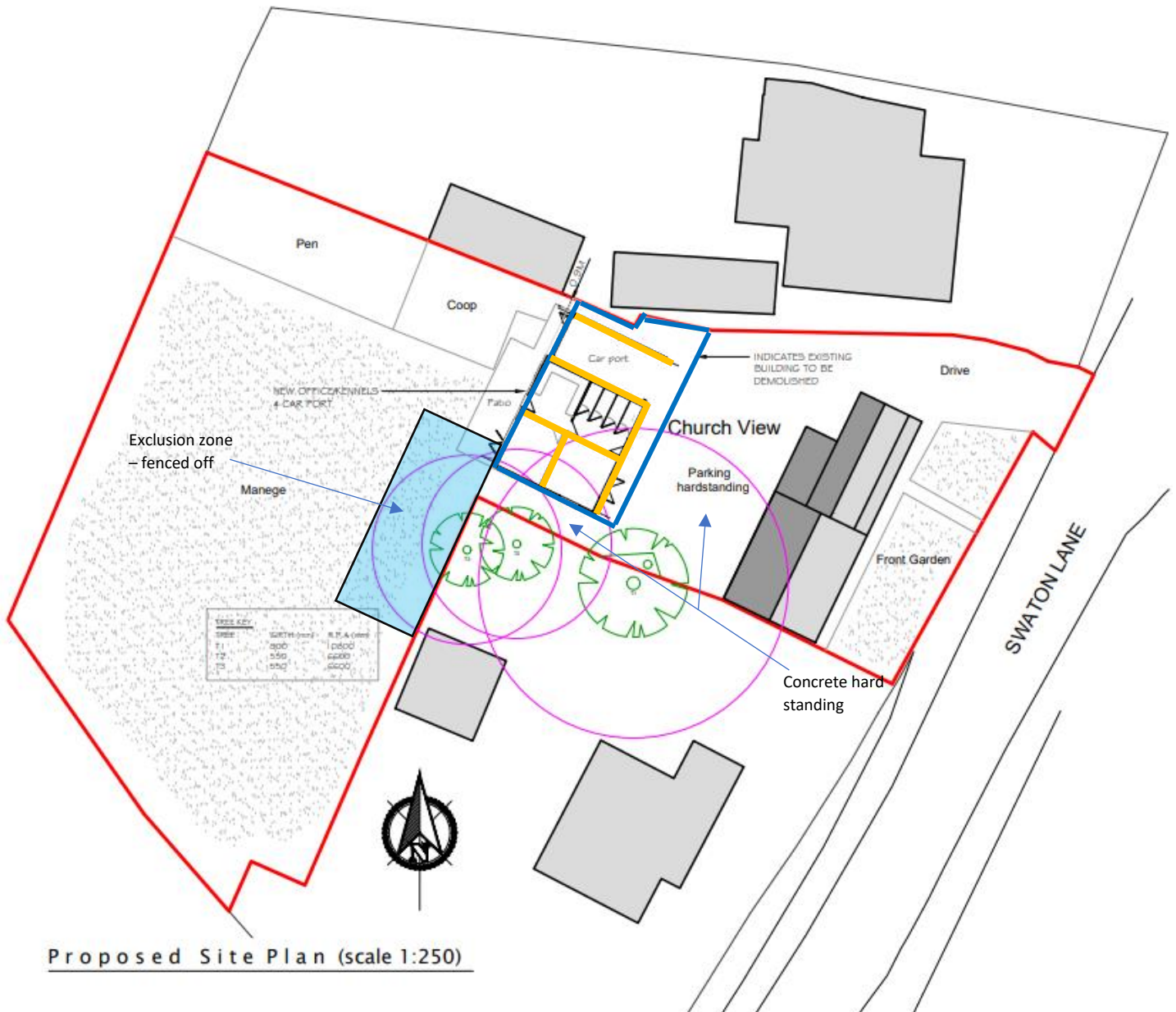

No fires to be lit on site within 10 metres of the nearest point of the canopy of any retained tree on or adjacent to the proposal site.

No mixing of cement, dispensing of fuels or chemicals within 10 metres of the tree stem of any retained tree on or adjacent to the application site.

No topsoil, building materials or other to be stored within the root protection areas of any retained tree/hedgerow on or adjacent to the application site.

No soakaways to be routed within the Root Protections Areas or any retained tree on or adjacent to the application site - soakaways not planned within RPA.

New foundation excavations (as shown by orange lines) to be dug are within the current foundations (as shown in blue lines) of the old building. Even though these new foundations are within the RPA,

Tree Protection Plan – Church View, Swaton, NG34 0JR

no damage to the tree roots is anticipated as the existing foundations will have prevented roots within this area.

The majority of the current RPA is covered by block concrete paving/slab already so machinery for demolition and construction permitted as no additional soil compaction will be caused. Area within the RPA which is not covered by concrete is shown by the transparent blue box, this area will be fenced off.

Demolition working methods

Roof materials to be removed by hand.

Brickwork to be demolished using 3CX digger and removed from site via trailer in NE corner of property along driveway.

Protection barriers not required for RPA zones as already covered by concrete.

Existing foundations to be retained to avoid any damage to roots close to them.