

PROPOSED GARDEN AND WOODSTORE  
 TO SIDE/WEST ELEVATION  
 AT: OLD WORTHY, FORDLANE, PILTON,  
 SHEPTON MALLET BA4 4BT  
 FOR: MR AND MRS BUTLER  
 ELEVATION 1:100, PLAN 1:50  
 SECTION 1:25 AND DETAILS  
 DRAWING PAPER SIZE A3

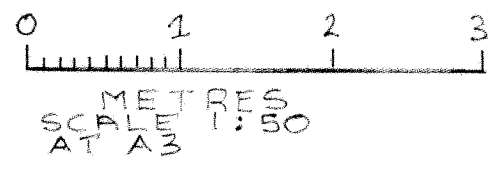

WEST ELEVATION 1:100

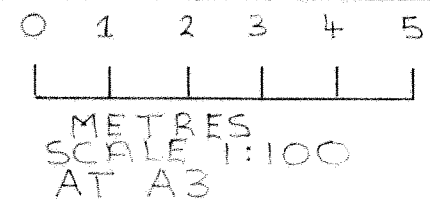
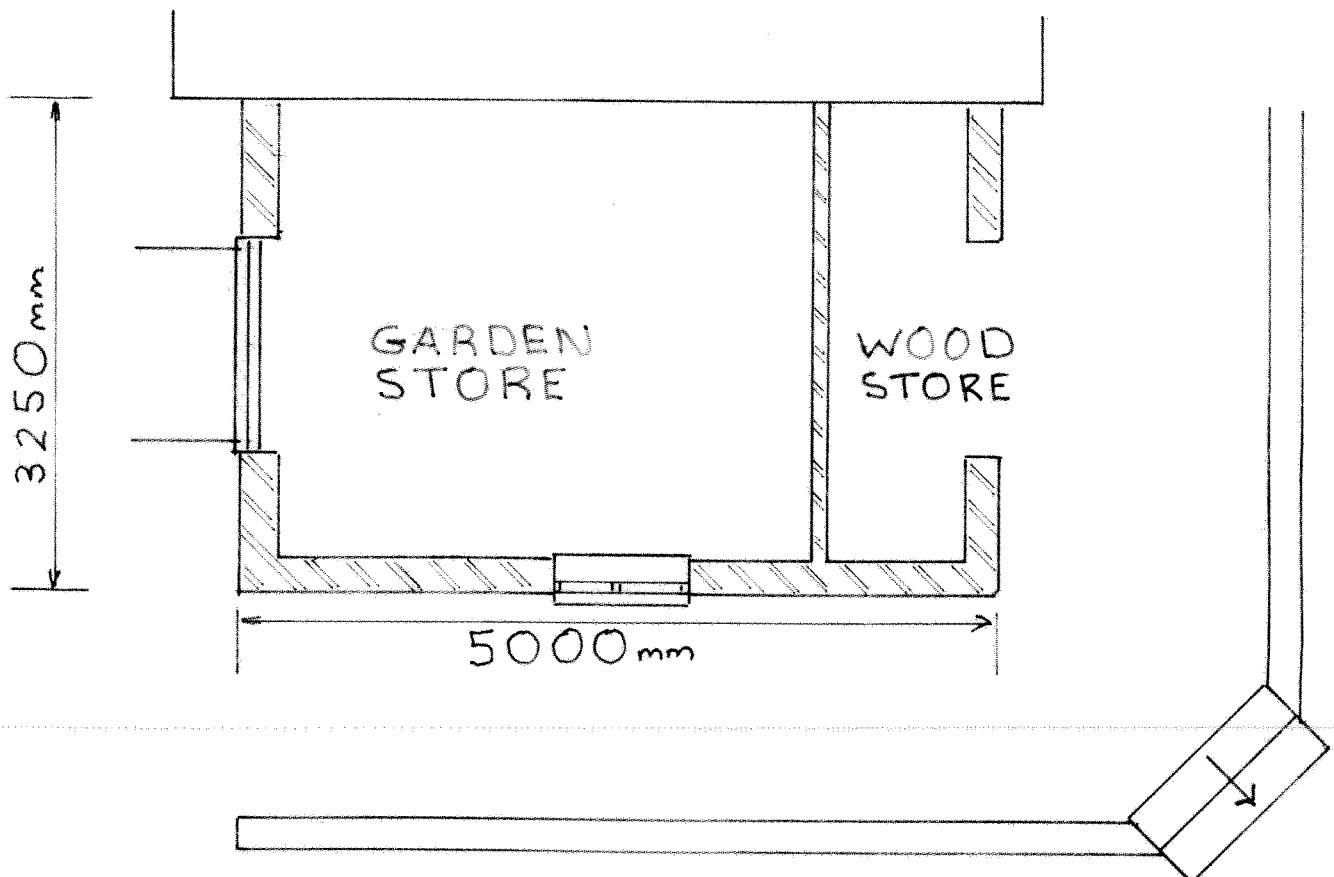

PLAN 1:50

### CONSTRUCTION DETAILS

FOUNDATIONS AND ROOF TO BE APPROVED BY STRUCTURAL ENGINEER

ROOF: RED CLAY DOUBLE ROMAN TILES ON 25x50mm BATTENS ON BREATHER MEMBRANE WITH LEAD FLASHING TO ABUTMENTS. 173mm RAFTERS @ 400mm & BOLTED TO 147mm x 47mm CEILING JOISTS BEARING ON 217x47mm WALL PLATE SECURED WITH RESTRAINT STRAPS @ 1000mm & BEARER PLATES/BEAMS TO S/ENGINEER APPROVAL

WALLS: SOLID 215mm THICK 7N BLOCK WALLS WITH PAINTED EXTERNAL RENDER FINISH ON DPC. 100mm BLOCK PARTITION WALL WINDOW TO MATCH EXISTING 2NO 686mm DOORS TO GARDEN STORE WOOD STORE LEFT OPEN

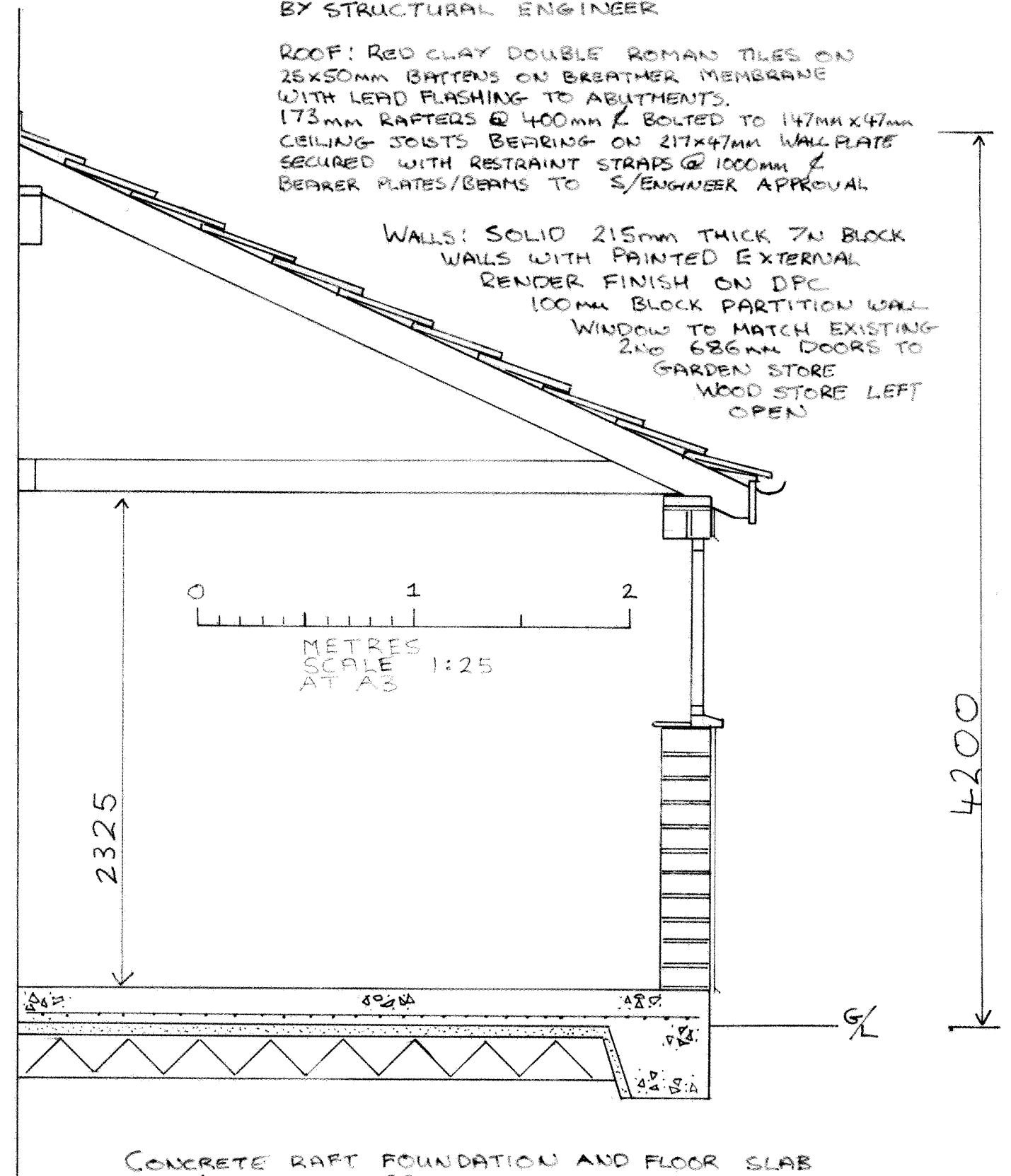

CONCRETE RAFT FOUNDATION AND FLOOR SLAB TO S/ENGINEER APPROVAL ON COMPACTED SAND BLINDING AND hardcore AND DPM. PROVIDE SYNTHAPRUF TO EXPOSED EDGE OF SLAB

RAINWATER TO BE HARVESTED WITH OVERFLOW TO A SOAKAWAY. GRAVEL PATHS AND BLUE LIAS RETAINING WALLS AND STEPS TO MATCH EXISTING

4200