

BLOCK PLAN

Scale: 1/500

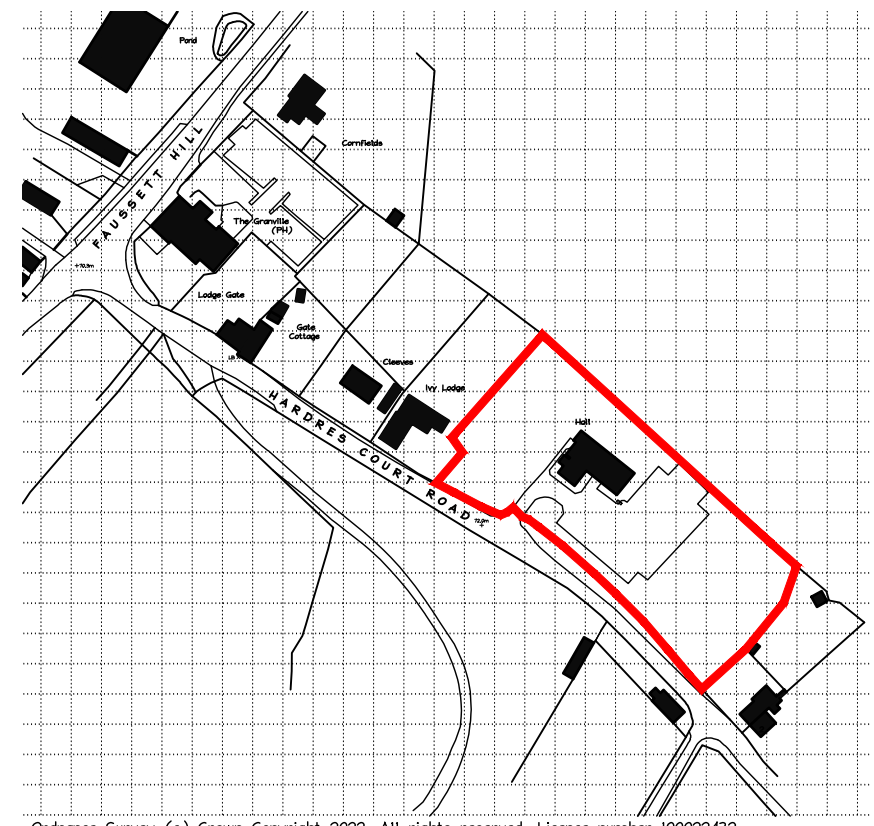

Ordnance Survey (c) Crown Copyright 2022. All rights reserved. Licence number 100022432

LOCATION PLAN

Scale: 1/2500

1. This drawing shall remain in the ownership of Stephen Roberts: Architecture (SR:A) unless specifically identified otherwise. The copyright of both the drawing and the design contained therein will also remain with SR:A and shall not be communicated to others in any format without specific written consent. They may be used by the recipient and other parties to execute the project to which they relate and for other purposes relating specifically to that project.
2. If this drawing is issued in electronic format SR:A give no assurances whatsoever for the accuracy of any data that is not visible at time of issue in the viewports of layout tabs that have been identified as having been issued.
3. The design will be subject to detailed survey (if not already available) and to the requirements of the Local Planning Authority, Building Regulations and other regulatory authorities and may need to be amended accordingly.

4. Where elements of the construction have been subject to specialist design by others (design consultants, suppliers or sub-contractors) the inclusion of that information on this drawing is solely for the purposes of coordination with adjoining elements of the construction. Responsibility for that specialist design lies with its designer and SR:A accept no responsibility for the design of those elements.

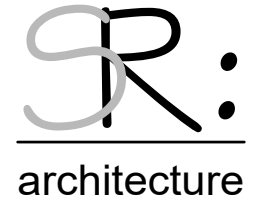

STEPHEN ROBERTS : architecture
 3 Carlton Hill : Herne Bay : Kent : CT6 8HL

t. 01227 743353
 m. 07837 757673
 e. steve@sradesign.co.uk
 w. www.srarchitecture.co.uk

Client: VILLAGE HALL COMMITTEE		Project No:	22-03
Project: LOWER HARDRES VILLAGE HALL LOWER HARDRES CT4 5NP		Drawn by: SJR	Dwg. No. (P)01
		Checked by: SJR	
Drawing: BLOCK PLAN / LOCATION PLAN PLANNING APPLICATION		Date: aug22	Revision -
Scale@A3: 1:500/2500		Master dwg. no.	22-03_P-20.dwg