

- Notes**
1. Do not scale drawing. If in doubt contact Harrogate Architectural
  2. All dimensions are in millimeters unless noted otherwise
  3. Not for construction unless otherwise shown
  4. When appropriate, this drawing to be read in conjunction with project specific Designers Risk Assessments, produced in accordance with requirements of Regulation 13 of the Construction (Design and Management) Regulations 1994
  5. The design shown on this drawing is the property of Harrogate Architectural and is not to be used or the drawing copied, communicated or disclosed, in whole or in part, except in accordance with a contract, licence or agreement in writing with Harrogate Architectural
  6. The Party Wall Act 1996 is to be observed and in particular the issuing of written notices to adjoining owners.
  7. All Constructional dimensions given are to be checked on site and any discrepancies are to be notified to Harrogate Architectural without delay.

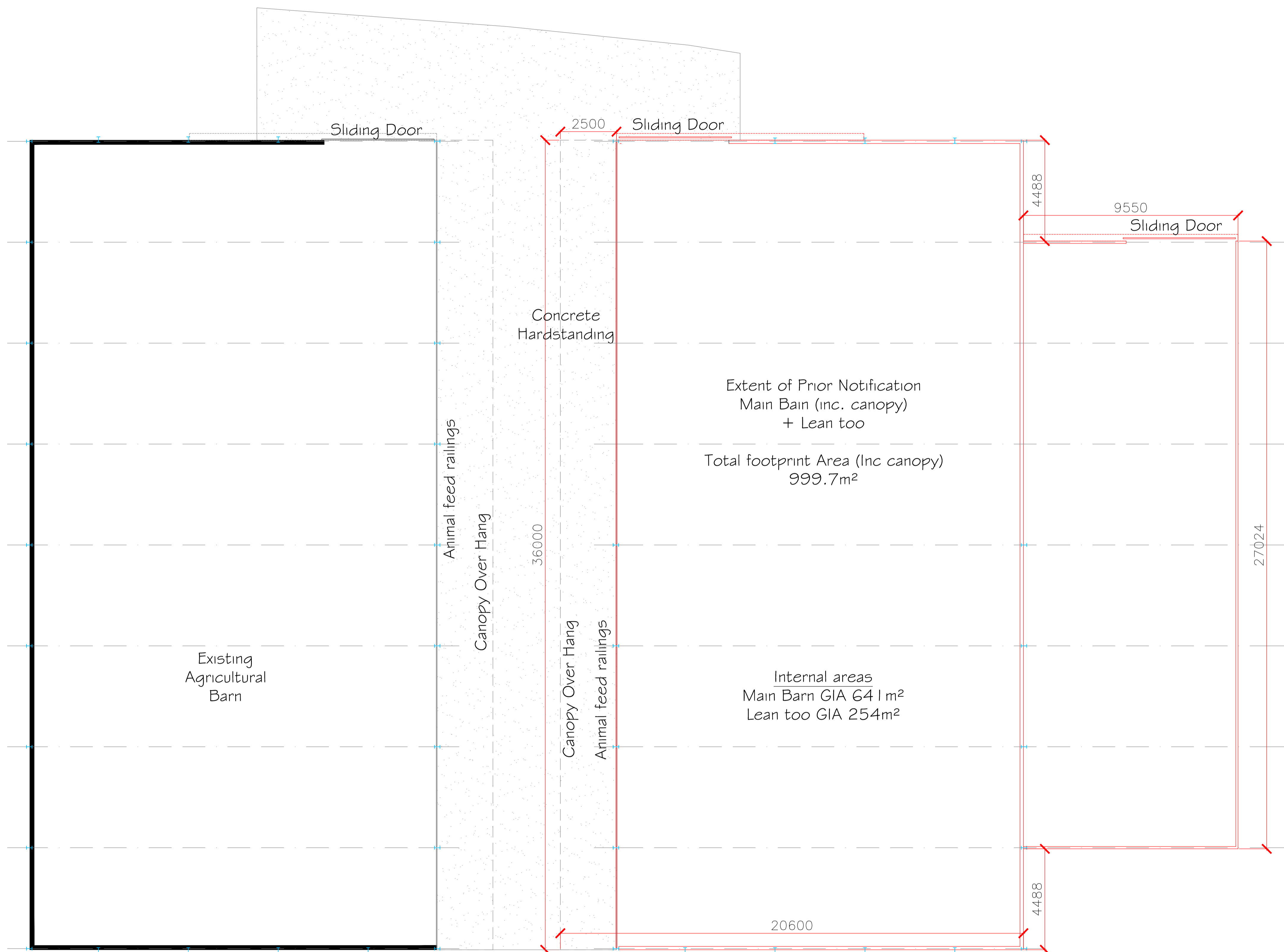

- Materials:**
- Walls - Concrete panel walls to match existing with Yorkshire Board Timber cladding at high level.
  - Roof - Galvanised Steel sheet roofing to match existing.
  - Rainwater Goods - UPVC to match existing (colour Black)

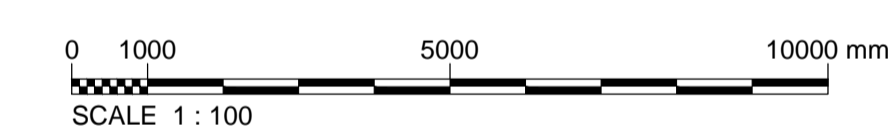

REV.	DATE	DESCRIPTION	DRN.	CKD.
E	03.05.23	Layout Amendments	ASP	RT
D	17.03.23	Revised to suit comments	ASP	RT
C	13.03.23	Revised to suit comments	ASP	RT
B	07.03.23	Revised to suit comments	ASP	RT
A	06.03.23	General amendments	ASP	RT

**PROJECT**  
 Mr M Smith, Agricultural Barn  
 High Rails Farm  
 Whitley Lane  
 Ripley  
 HG3 3DL

**TITLE**  
 Pr Plan

**STAGE**  
 PLANNING

JOB No. 23/02/2383	DWG No. 03	REV. E
SCALE 1:100 @ A1	DATE Feb 2023	
DRAWN ASP	CHECKED RT	

Proposed Plan  
1:100 SCALE