

# Biodiversity Enhancement & Compensation Plan

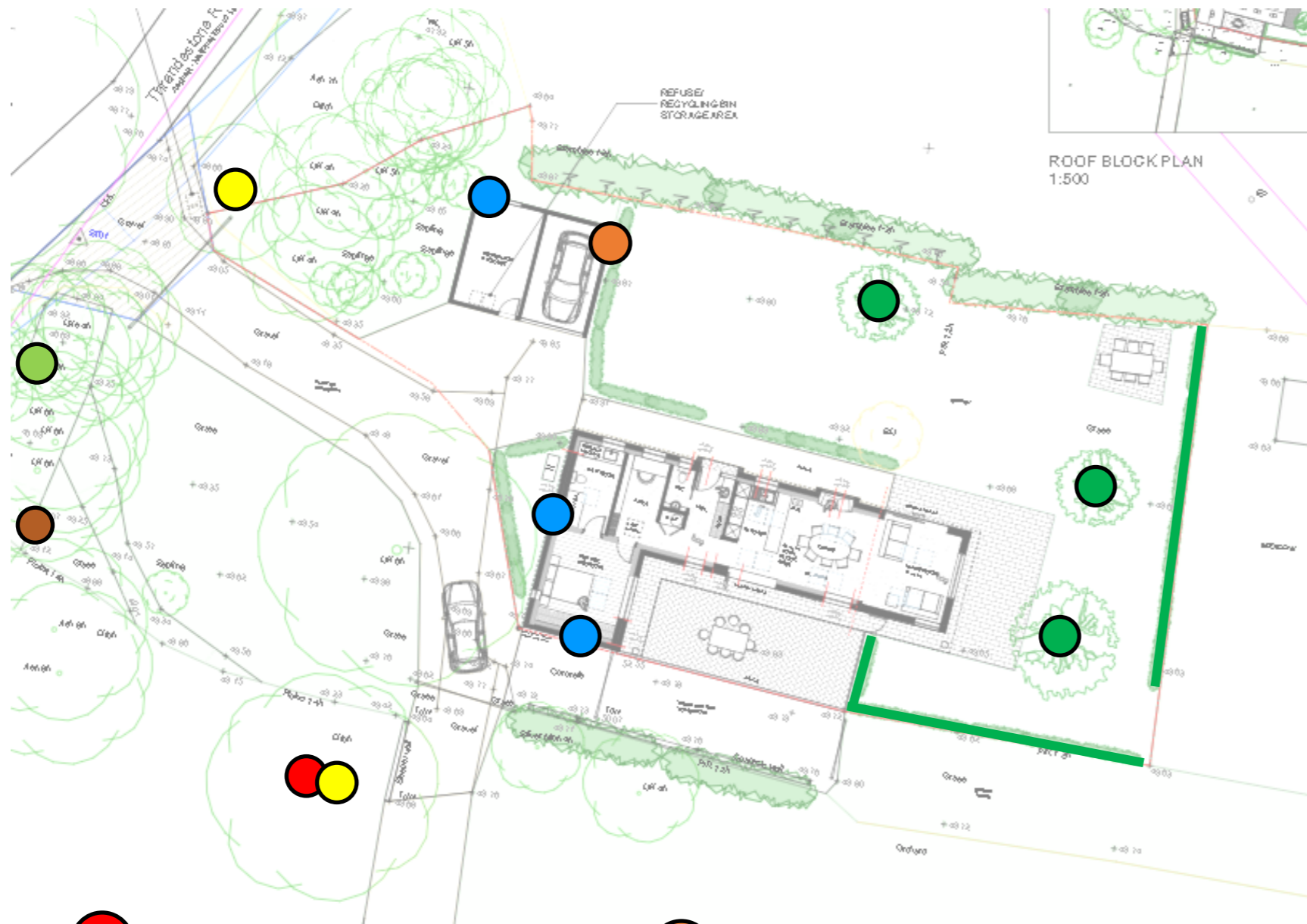

- Barn owl box
- Integrated bat boxes (Individual)
- Tree mounted bat box (Pair)
- Hedgehog box
- Hole-fronted bird box
- Species Rich Native Hedgerow
- Integrated house sparrow box
- Tree planting

To be read in conjunction with the detail overleaf



Barn owl



Hedgehog











Common pipistrelle

**Upkeep Requirements & Responsibility**

The example specification suggested primarily focused on enhancements requiring minimal maintenance (maintenance required is detailed within the table overleaf). Responsibility for the maintenance of features will be the owner of the Site (Miss N. Hallet)

<b>Title:</b>	Biodiversity Enhancement Plan	The Roost, Scole, Norfolk IP21 4DT T: 01379 740098 E: info@practical-ecology.co.uk W: www.practical-ecology.co.uk
<b>Project:</b>	Stable Clay Barn, Melis	
<b>Ecologists:</b>	Drawing and Text: A. Jessop Reviewed by: C. Weaire	
<b>Notes:</b>	Overlaid on ref: Beech Architects, 617-05-F	
<b>Date:</b>	15th December 2022	

# Biodiversity Enhancement Plan

Key			 				
<b>Feature</b>	Tree planting	Barn owl box	Integrated and tree mounted bat box	Hedgehog House	Hole fronted bird box	Integrated house sparrow box	Hedgerow planting
<b>Purpose</b>	Enhancing the Site by providing habitat for a range of species	Enhancing the Site by providing nesting habitat for barn owl	Providing roosting habitat for bats	Provide shelter for hedgehogs all year round.	Provide habitat for a wide range of birds, including blue tit and great tit	Providing habitat for nesting house sparrow	Provision of shelter and foraging for wildlife
<b>Installation &amp; Maintenance Detail</b>	Planted in autumn or winter outside periods of heavy frost, in square holes, with regular watering for the first two years and further watering in periods of prolonged drought.	Installed at least 3m above ground level with the entrance facing north or east. Box can be cleared out in winter.	Integrated 2.5-5m above ground facing south or west, away from windows and lights. Tree mounted, 3-6m high in sun with a clear line of flight to and from boxes.	Locate within cover, out of prevailing wind. Pile leaves and short grass around the house plus two handfuls of short dry grass and leaves inside the box to start nest. Clear out annually in April or October checking for hedgehog presence.	Mounted 3-4m high in a sheltered area with a clear line of flight. Option to clear out yearly.	Integrated into the masonry during construction near to vegetation and at least 2m above ground level.	Whip planting in autumn or winter, outside frost periods, with 5 plants per metre.
<b>Example Specification</b>	<i>Betula pendula, Prunus padus, Quercus robur, Malus domestica, Prunus avium</i>	Triangular Barn Owl Nest Box	PRO UK Build-in WoodStone Bat Box Eco Kent Bat Box	HH7 Hogilo Hedgehog	Vivara Pro Seville WoodStone Nest Box with 32mm Oval Hole	Vivara Pro WoodStone House Sparrow Nest Box (Double Chamber)	<i>Crataegus monogyna, Cornus sanguinea, Acer campestre, Corylus avellana, Rhamnus cathartica, Rosa canina, Viburnum lantana</i>

