

Dorset Council Natural Environment Team (NET) DBAP BIODIVERSITY PLAN

- This Biodiversity Plan is only valid with a NET signed Certificate of Approval related to this Biodiversity Plan
- This Biodiversity Plan is solely for use for planning applications falling under the Dorset Biodiversity Appraisal Protocol (DBAP)
- Please read the published guidance ‘Dorset Biodiversity Appraisal Protocol for consultants’ for completing this Biodiversity Plan visit [The Dorset Biodiversity Appraisal Protocol - Dorset Council](#)
- Please complete all sections within this form relevant to the application. Please do not delete or alter sections of this form. Use a continuation sheet if necessary. Any forms submitted with incomplete information will be returned

SECTION A: Planning Application Details				Ref number: (NET use only)			
Application ref. (if known)		Planning Officer (if known)		Outline	RM/Full	Hybrid	Planning decision (NET use only)
				<input type="checkbox"/>	<input checked="" type="checkbox"/>	<input type="checkbox"/>	
Proposed development (provide a brief description of the proposed development stating area in hectares where appropriate)							
convert the existing stables building, currently used for storage, into a farm shop and cafe							
Number of new units	0	Grid reference	SU 14406 08266				
Site address	Courtyard Buildings, Ellingham Farm, Somerley Estate, Ellingham, Hampshire			Post code	BH24 3PJ		
Ecological consultant name	Davog McCloskey	Ecological consultancy name	Peach Ecology				
SECTION B: Details of all Biodiversity Features Affected							
Protected species / BAP interests	Habitat feature (e.g. sett, pond, hedgerow, roof void, tree roost)		Type of bat roost (e.g. maternity, summer, hibernation, historic)		Population estimate and status (High, Medium, Low or Unknown)		
Bats (Greater Horseshoe and Common Pipistrelle)	Roof void roost		Day roost		GHS: Individual bat, low Common Pipistrelle: individual bats, small numbers (2-3), low		
Birds	Robin nest		Nesting		low		
DERC search completed:		Yes	No	n/a	SNCI	Yes	No

<input type="checkbox"/>	<input type="checkbox"/>	<input checked="" type="checkbox"/>	(within 500m):	<input type="checkbox"/>	<input type="checkbox"/>
--------------------------	--------------------------	-------------------------------------	----------------	--------------------------	--------------------------

List the relevant reports (include all reports and dates of the survey(s))

Ecology Assessment, 9th June 2022. Bat emergence surveys undertaken June, July, August 2022

SECTION C and D are for bats only

SECTION C: Details of the Existing Bat Roost(s) and/or Feature(s)

Roost type e.g. roof void, cavity, tree	Day roosts for Greater Horseshoe and Common Pipistrelle	Foraging / commuting habitat	Yes <input type="checkbox"/>	No <input checked="" type="checkbox"/>
Roost dimensions (m)	Void width 4.7	Void length 20+	Void height currently 4m+ (at apex)	open voids to floor level
Roof aspect	N / S <input checked="" type="checkbox"/>	NE / SW <input type="checkbox"/>	E / W <input checked="" type="checkbox"/>	SE / NW <input type="checkbox"/>

SECTION D: Summary of Mitigation Measures (Please provide net gain measures in Section H)

Type of mitigation

Permanent replacement	<input type="checkbox"/>	Modified roost	<input checked="" type="checkbox"/>	Temporary replacement roost	<input type="checkbox"/>	Bat boxes / bricks	<input checked="" type="checkbox"/>
-----------------------	--------------------------	----------------	-------------------------------------	-----------------------------	--------------------------	--------------------	-------------------------------------

Timing of works to roost (please specify when works will take place by calendar month)

When works to existing roost will take place	N/A
--	-----

Completion of temporary roost provision (if applicable)	
---	--

Completion of permanent roost (if applicable)	Access into the new bat roosting area will be completed first before the rest of the construction works so that there is always a roosting area in place for GHS bats
---	---

EPS Licence required	Yes <input checked="" type="checkbox"/>	No <input type="checkbox"/>	Bat Low Impact Licence	Yes <input type="checkbox"/>	No <input checked="" type="checkbox"/>
----------------------	---	-----------------------------	------------------------	------------------------------	--

Description of alternative temporary replacement roost (include position e.g. existing building, new structure, tree)

Temporary roost type e.g. bat box	A 1f bat box or a similar style will be erected prior to any work on the buildings – these can be erected nearby in a tree or on a retained building.
-----------------------------------	---

Temporary roost void dimensions(m)	Void width	Void length	Void height (at apex)
Roof aspect	N / S <input checked="" type="checkbox"/>	NE / SW <input type="checkbox"/>	E / W <input type="checkbox"/>
			SE / NW <input type="checkbox"/>

Make of bat box	How many	Position
1f or another flat style box	1	On a retained tree to the south of the building

Details of permanent roost

Replacement roost type e.g. roof void, bat box

The new building will have a new bat roosting area included in it as shown in Appendix D, this will be sectioned off from the commercial areas and will include:

- A space from floor to the internal ridge of the roof that is as large as possible and as high as possible. Floor area at least 4x4m with a minimum height of 2m from soffit height to the apex of the roof.
- A gable access enabling direct flight access into the void measuring 150mm tall by 300mm wide
- Any new roof lining will use bitumen 1f style roofing felt under tiles/slates.
- Baffles will be used to create micro-environments to minimise draughts.
- A 'hot box' is a sectioned off area within a bat roost that provides protection from any draughts, allowing the temperature to remain higher than the surrounding area. They are typically constructed from plywood panels. The access in the base must be 500mm x 500mm and the external parts will be painted black to increase heat absorption.

Any new external lighting must be avoided wherever possible. Where it is necessary, it will be pointed downwards and away from any retained trees, hedges and any new features installed for bats and birds.

The existing common pipistrelle roost will be retained

Replacement roost void dimensions(m)							
Roof aspect	N / S	<input checked="" type="checkbox"/>	NE / SW	<input type="checkbox"/>	E / W	<input type="checkbox"/>	SE / NW <input type="checkbox"/>
Make of bat box / brick to be installed	Number		Make of bat box / brick to be installed		Number		
Click or tap here to enter text.							

Details of mitigation only (include foraging habitat, method statement, monitoring/compliance & description of bat roost features. Include: a plan showing locations of access point(s), bat bricks/boxes, internal roosting features).
Note: Ensure measurable net gain is placed in Section H.

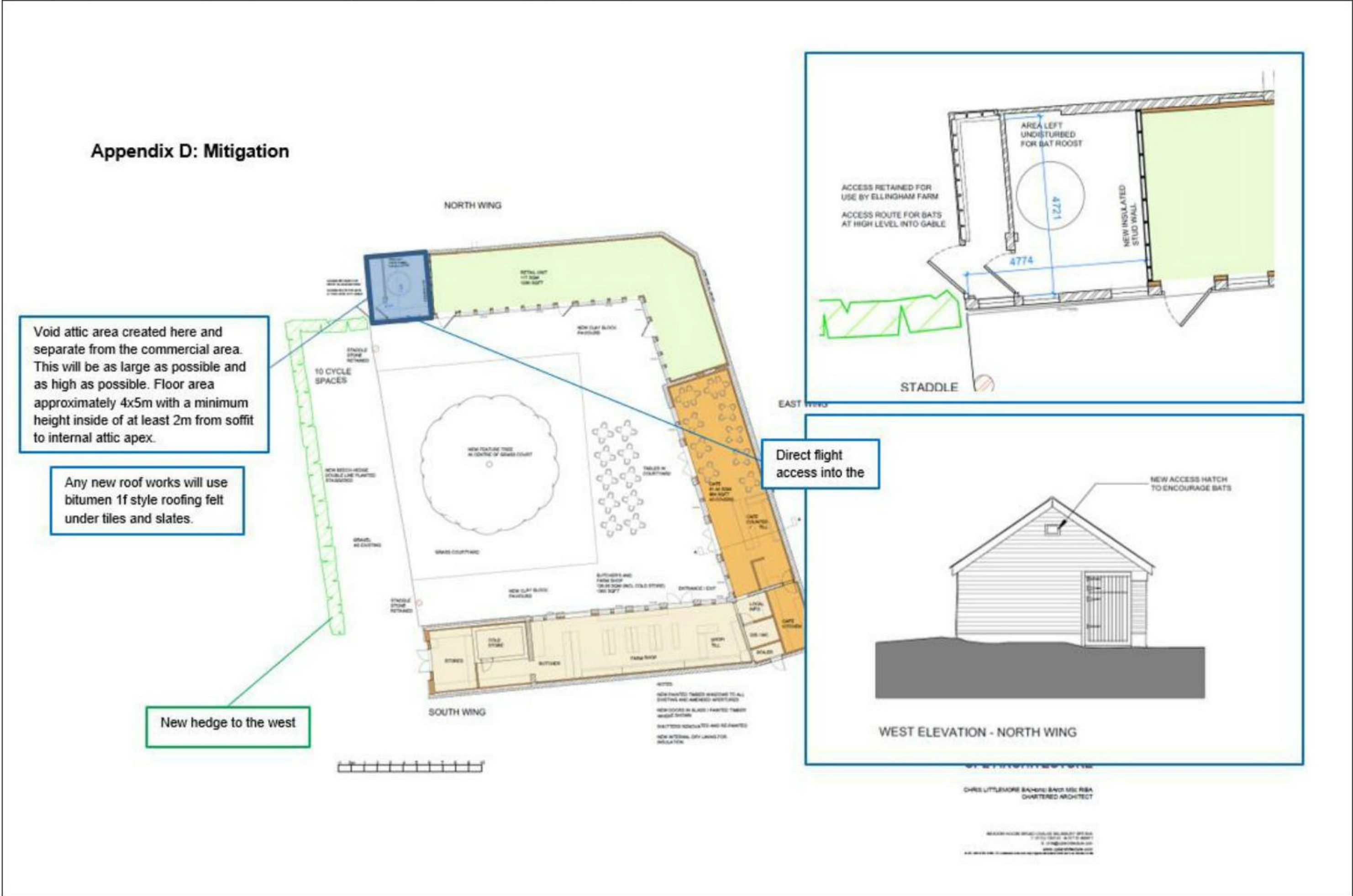

Sections E and F are for all other protected species (other than bats) and habitats

SECTION E: Summary of Mitigation Measures (Please provide net gain measures in Section H)

Type of mitigation

Avoidance of harm through best practice	<input checked="" type="checkbox"/>	Measures to deter individuals from location	<input type="checkbox"/>	Capture and translocation of individuals	<input checked="" type="checkbox"/>			
Controlled destruction of place of shelter / breeding site	<input checked="" type="checkbox"/>	Replacement of place of shelter / breeding site	<input checked="" type="checkbox"/>	Habitat enhancement measures	<input checked="" type="checkbox"/>			
EPS/NE Licence required	Yes <input type="checkbox"/>	No <input checked="" type="checkbox"/>	Low impact class licence	Yes <input type="checkbox"/>	No <input checked="" type="checkbox"/>	GCN DLL	Yes <input type="checkbox"/>	No <input checked="" type="checkbox"/>

SECTION F: Detail Mitigation Measures & Method Statement Details (Please provide net gain measures in Section H)

List and quantify all mitigation features that must be applied to mitigate impacts to protected species and habitats and that will form a permanent part of the new development (e.g. number of bird boxes, length of native hedge planting, number or area of ponds).

Note: Please ensure long-term management plans for habitats such as hedgerows are referenced here.

The building will have a feature created for nesting Robins at a suitable location to the eastern side of the building or within the courtyard area of the building, attached to the building.

The site will be monitored by an ecologist after the mitigation is complete so that it can be 'signed off' to show that it has been installed and planted correctly.

SECTION G: Details of Off-site Compensation

Residual biodiversity losses may occur due to loss of nesting habitat, rough grasslands, hedgerows etc. and maybe addressed by an appropriate funding contribution or equivalent measures on another site.

After on-site mitigation, will the scheme result in a residual loss to biodiversity?

(If 'yes' please summarise additional off-site compensation measures below).

Yes

No

SECTION H: Details of all Net Gain Measures (for all species)

Summarise all the biodiversity net gain measures that will be put in place to ensure that there is NET gain to your development in accordance with National Planning Policy Framework and Section 40 of the Natural Environment & Rural Communities Act 2006.

Note: Please do not include any mitigation in this section.

Adding a barn owl box to a retained tree would be an easy enhancement in line with government biodiversity net gain legislation.

A swift and house sparrow box will be installed under the eaves of the building, facing north, in the courtyard area.

SECTION I: Provide an Annotated Illustrative Masterplan / Plan Drawings. (Please make sure that the red-line boundary, ecological features, mitigation and enhancements are clearly indicated).

SECTION J: Compliance Measure (Please tick the relevant box. In each case, compliance must be supplied to NET. This is for NET information only and must not be relied upon for the discharge of planning conditions).

Tick here for cases requiring an EPS / BLIL licence or of an area greater than 0.1ha for a post construction compliance visit and report to be sent to the NET.	<input checked="" type="checkbox"/>	Tick here for simple cases where photographic evidence of the completed mitigation / enhancement measures is appropriate.	<input type="checkbox"/>
---	-------------------------------------	---	--------------------------

SECTION K: Declaration (To be completed by applicant/agent or ecological consultant prior to submission). Note: This form is not valid unless signed by all parties as set out below:

I hereby confirm that the measures set out in this BP will be completed in full including where stated above an application for an EPS/NE/Low Impact Licence.

Applicant/agent: name:	Signature:	Date:
-------------------------------	-------------------	--------------

Or if signed by the ecological consultant: The applicant will comply with the measures set out in this BP and complete them in full.

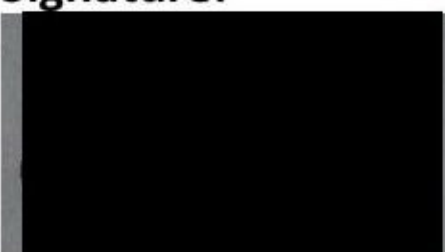
Ecological consultant name: Davog McCloskey	Signature: 	Date: 3.2.22
--	--	---------------------

NET	Signature:	Date:
------------	-------------------	--------------

Checklist

- Ensure your Biodiversity Plan is complete
- All relevant ecology reports are submitted (unless agreed otherwise with the Natural Environment Team prior to submission)
- Submit all necessary documentation to biodiversityprotocol@dorsetcouncil.gov.uk
- Make the payment when submitting your Biodiversity Plan. For charges & payment methods visit [How does the Biodiversity Appraisal process work? - Dorset Council](#)
- Where ecological consultants sign this form on behalf of the applicant, the applicant is not obliged to engage that consultant for further work.