







# Arrondale Lodge

The Arrondale brings a splash of modern living to Pemberton's range of twin units and there are some lovely surprises awaiting you. Extra storage in the lounge inside the corner sofa and the large square footstool together with fresh new fabrics throughout will entice you to return again and again.

## Highlights

- PVCu double glazing with bifold doors to front elevation
- Self contained entrance hallway with integrated storage (45ft only)
- High level cooker with separate oven and grill
- Integrated washer/dryer, fridge/freezer, dishwasher and microwave
- Kitchen island with 2 bar stools
- Luxurious corner with storage, co-ordinating armchairs and a footstool
- Recessed electric fire and DVD unit
- Full size bath with aqua board
- Large domestic shower in en-suite
- 5ft divan in the master bedroom
- Accessory pack
- Vaulted ceiling throughout with a minimum ceiling height of 2.4m (8ft)
- Vinyl cladding
- External socket
- Gas combi central heating system with thermostatic radiator valves
- TV points in all bedrooms
- Glass top dining table



42ft x 16ft	2 bedroom
45ft x 16ft	2 & 3 bedroom

Images shown are from the Arrondale 45 x 16, 2 bed



**Pemberton**  
PARK & LEISURE HOMES







# Arrondale Lodge

Platinum Package Option includes the following:

- Aggregate Coated Steel Tile Roof System
- Wood Panelled Ceiling
- Wallpaper Finish
- Aqua-board Finishes
- Domestic Interior Doors

42ft x 16ft - 2 bedroom

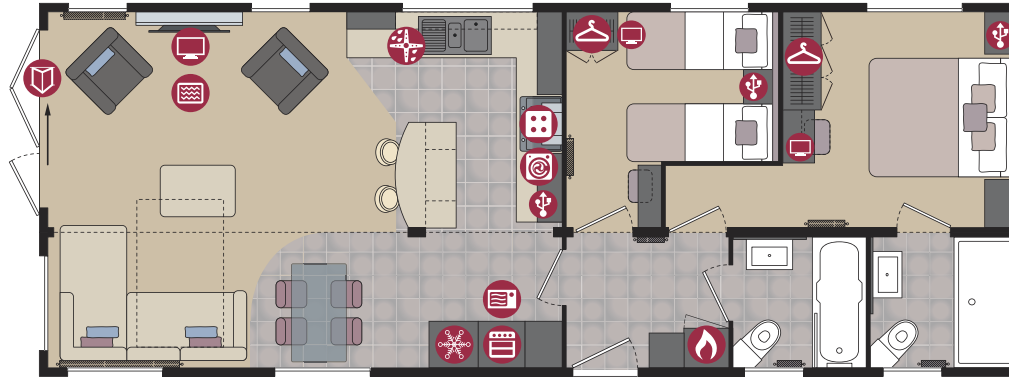



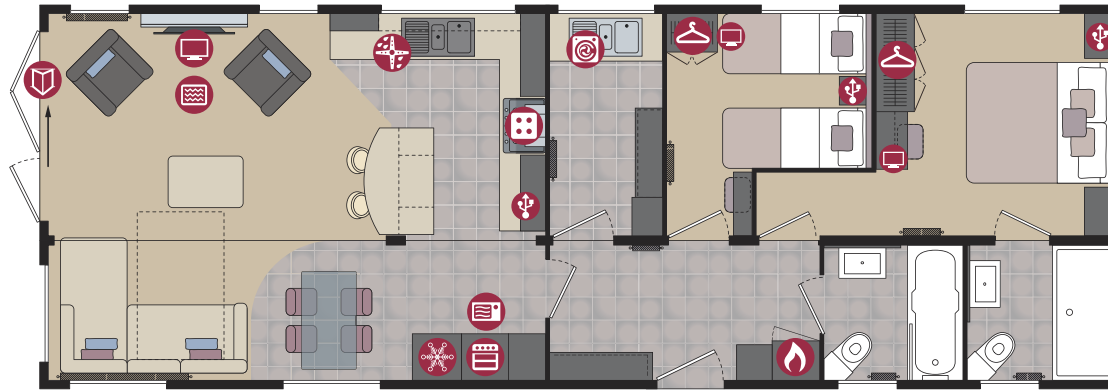



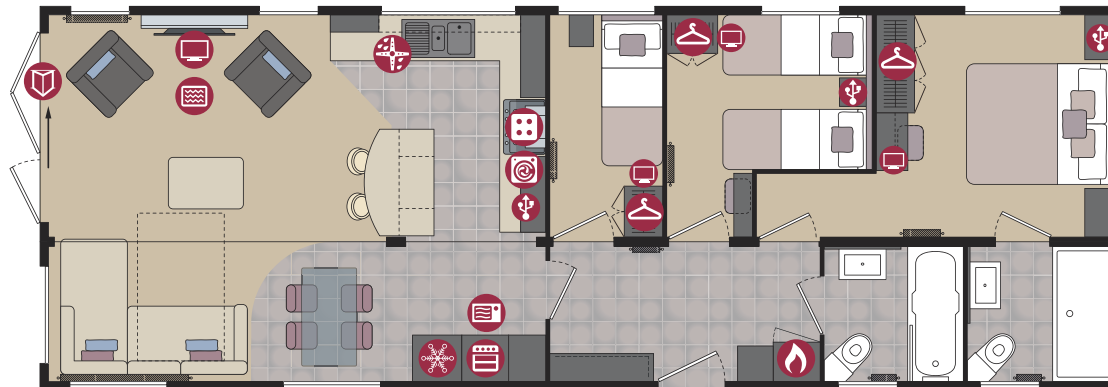







45ft x 16ft - 2 bedroom



45ft x 16ft - 3 bedroom



- |  |   |
|--|---|
|  Cooker         |  USB Point     |
|  Hob            |  TV Space      |
|  Fridge-Freezer |  Electric Fire |
|  Microwave      |  Patio Doors   |
|  Washer/Dryer   |  French Doors  |
|  Dishwasher     |  Bifold Doors  |
|  Boiler         |  Wardrobe      |

Residential Specification Option includes the following:

- Roof 250mm insulated
- 100mm thick wall
- Floor minimum 65mm insulated
- Windows low E glass and Argon filled
- Superior U values exceeding the British Standard





## Options available to order

- Residential Specification to BS3632 available in all cladding types including Stucco
- Arrondale Lodge available in Thermowood and Canexel Cladding in a wide range of colours
- Wine cooler
- Utility room or single bedroom (45ft only)
- Safe
- Lounge curtains instead of roman blinds
- Shower in lieu of bath
- Guzunder beds
- Platinum Package
- Bluetooth

For further details see standard features checklist on pages 70-71.



## Testimonial

*At Skelwith Fold we have a fantastic, longstanding relationship with Pemberton who give us everything we need in terms of product and service. Having an entire range that is available to Residential Specification is a big attraction for us too.*

Geoff Elliot, Skelwith Fold



**Pemberton**  
PARK & LEISURE HOMES