

New vent pipe taken through new roof and to terminate 900mm above the level of adjacent rooftop.

Velux PK04 fully reversible, electrically operated, tripple glazed rooftop with flashings and internal fly screen. Provide 2No 50x150 c24 rafters to full perimeter of rooftop.

Sawn stone verge capping to match existing roof, approx 400 x 80. Fully bedded in mortar and with stainless steel dowels at butt joints.
38x5 galvanised steel retaining straps @ 2m cts to be provided to gable wall, hooked ends into wall and screw fixed to rafters with noggins between on line of straps.

Extract fan to be located in ceiling void with accessible ceiling for maintenance of this and soil drainage from existing first floor areas.

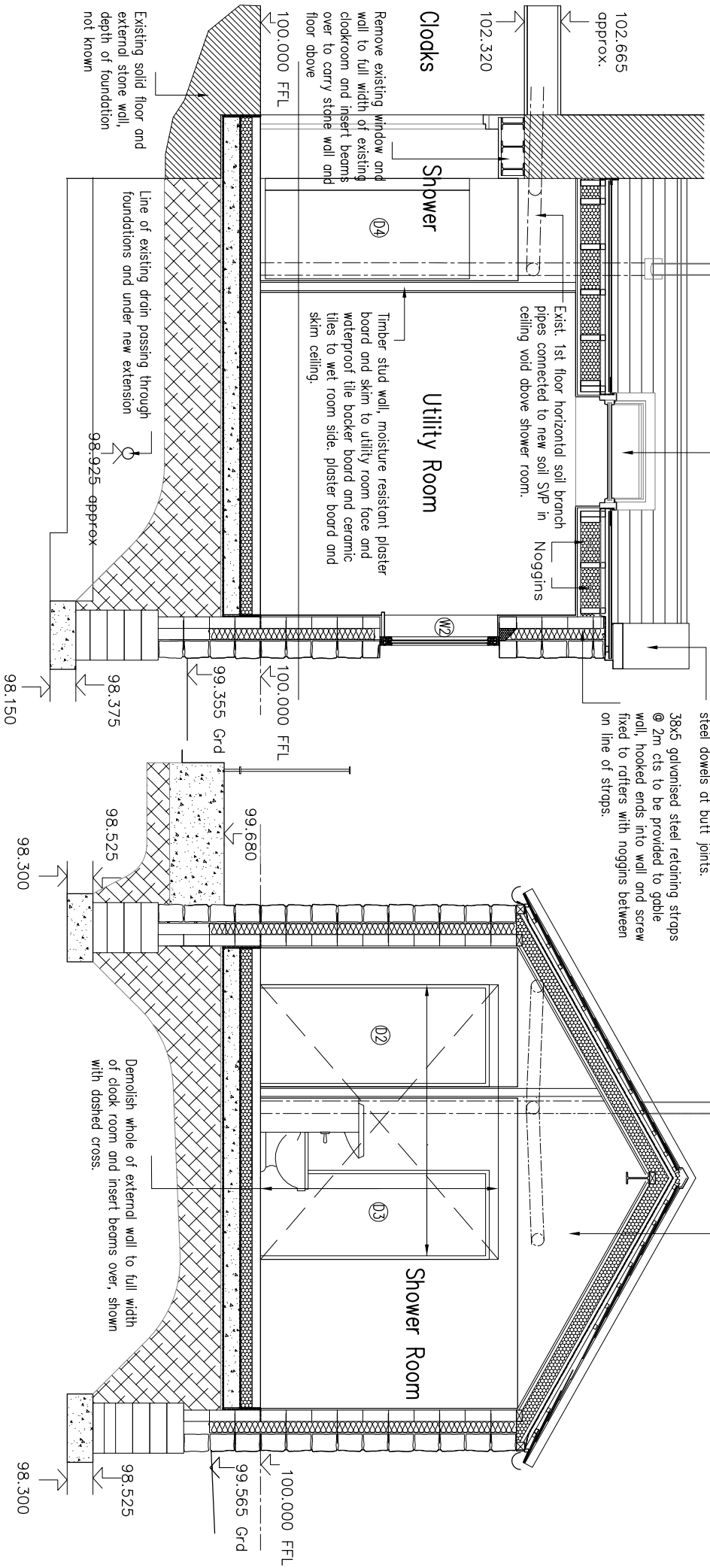

SECTION 3

SECTION 4



NOTE
This drawing is to be read in conjunction with the Building Regulation Compliance notes related to this project dated 28 March 2023

Revisions
A-10/04/23-Minor amendments for Building Regulation application

Proposed Utility Room Extension
Dr and Mrs R Kandler
Low Wood, Braithwaite Lane, Dacre, Harrogate HG3 4AS.

Sections 3 and 4

Date 28 Mar 2023

Scale 1:50@A4

Dwg No

10/A