

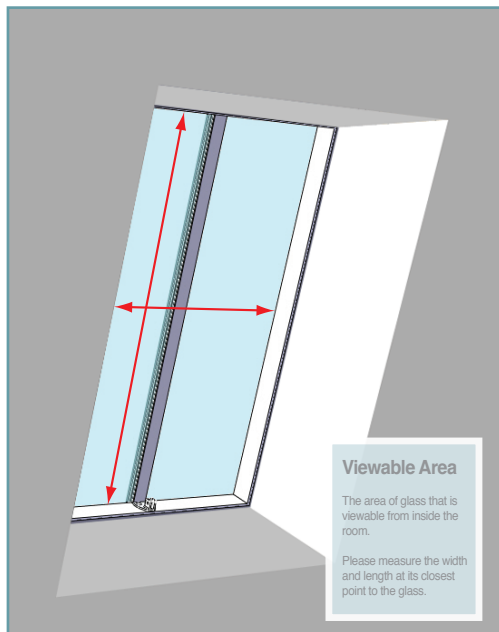

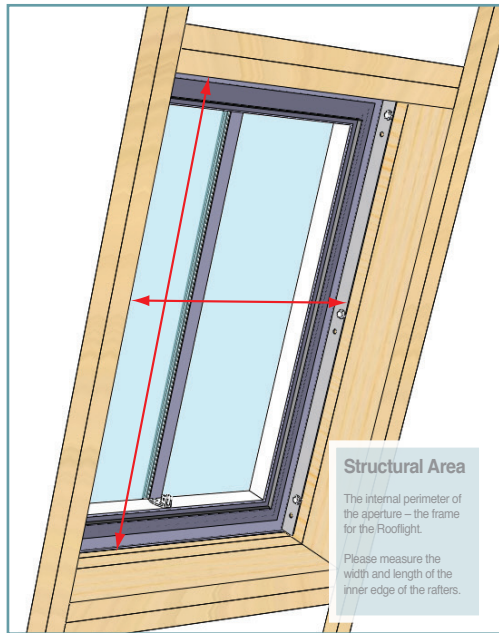

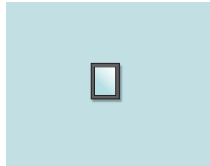
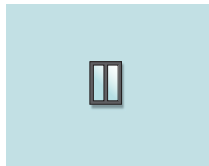
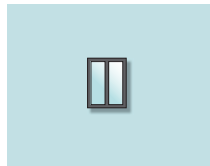
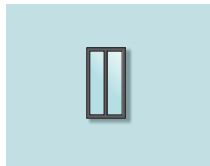
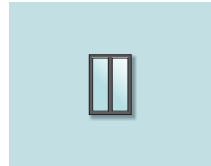
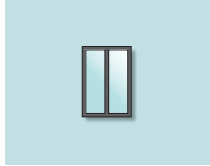
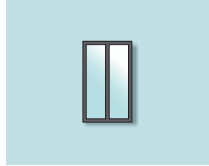
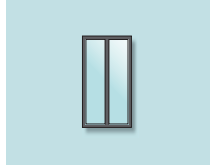
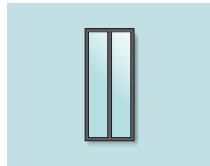
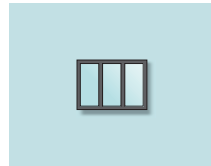

The Conservation Rooflight On the Rafter Roof Window Sizes and Prices

Before selecting your size, carefully read the 'Installation Overview' PDF.

PLEASE NOTE: THE DIFFERENCE BETWEEN AN 'ON THE RAFTER' OR 'BETWEEN THE RAFTER' ROOF WINDOW IS IN THE INSTALLATION, NOT THE ROOFLIGHT SIZE, AND DEPENDS ON THE BUILD-UP OF YOUR ROOF.

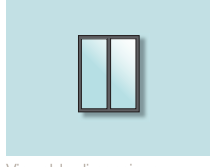

<p>Structural dimensions (W) 412mm x (L) 520mm</p>  <p>Viewable dimensions (W) 212mm x (L) 320mm CR06-1 - £621</p>	<p>Structural dimensions (W) 463mm x (L) 622mm</p>  <p>Viewable dimensions (W) 263mm x (L) 422mm CR07-2 - £632</p>	<p>Structural dimensions (W) 565mm x (L) 725mm</p>  <p>Viewable dimensions (W) 365mm x (L) 525mm CR01-2 - £640</p>	<p>Structural dimensions (W) 565mm x (L) 1028mm</p>  <p>Viewable dimensions (W) 365mm x (L) 828mm CR03-2 - £729</p>	<p>Structural dimensions (W) 615mm x (L) 875mm</p>  <p>Viewable dimensions (W) 415mm x (L) 675mm CR08-2 - £788</p>
<p>Structural dimensions (W) 717mm x (L) 1028mm</p>  <p>Viewable dimensions (W) 517mm x (L) 828mm CR09-2 - £851</p>	<p>Structural dimensions (W) 717mm x (L) 1180mm</p>  <p>Viewable dimensions (W) 517mm x (L) 980mm CR10-2 - £929</p>	<p>Structural dimensions (W) 717mm x (L) 1333mm</p>  <p>Viewable dimensions (W) 517mm x (L) 1133mm CR14-2 - £959</p>	<p>Structural dimensions (W) 717mm x (L) 1635mm</p>  <p>Viewable dimensions (W) 517mm x (L) 1435mm CR15-2 - £1114</p>	<p>Structural dimensions (W) 1021mm x (L) 725mm</p>  <p>Viewable dimensions (W) 821mm x (L) 525mm CR01-3 - £854</p>
<p>Structural dimensions (W) 869mm x (L) 1028mm</p>  <p>Viewable dimensions (W) 669mm x (L) 828mm CR11-3 - £957</p>	<p>Structural dimensions (W) 1021mm x (L) 1180mm</p>  <p>Viewable dimensions (W) 821mm x (L) 980mm CR13-3 - £1058</p>	<p>Structural dimensions (W) 1021mm x (L) 1333mm</p>  <p>Viewable dimensions (W) 821mm x (L) 1133mm CR14-3 - £1112</p>	<p>Structural dimensions (W) 1021mm x (L) 1635mm</p>  <p>Viewable dimensions (W) 821mm x (L) 1435mm CR15-3 - £1334</p>	
<p>Structural dimensions (W) 888mm x (L) 1114mm</p>  <p>Viewable dimensions (W) 537mm x (L) 848mm E1LG - £1121</p>	<p>Structural dimensions (W) 888mm x (L) 1114mm</p>  <p>Viewable dimensions (W) 537mm x (L) 848mm E1RG - £1121</p>			

☐ Egress Conservation Rooflights

Sections for viewable and structural dimensions can be found on our website.
All prices exclude VAT and delivery.
Please note flashing kits and accessories are sold separately.

SECTION 3 - Prior to installation

> Receiving the roof window

> Transport & storage

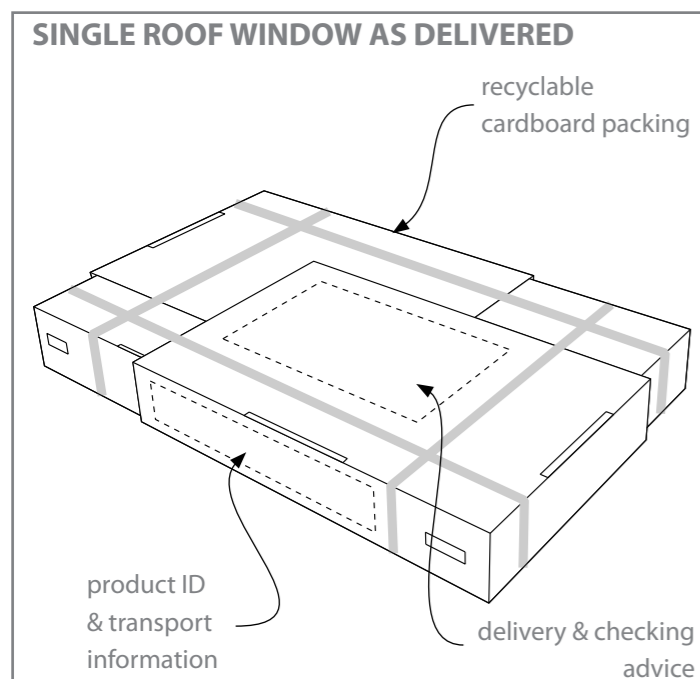

RECEIVING THE ROOF WINDOW

We recommend that the roof window packaging is temporarily opened to allow inspection of the goods for damage. Follow the instructions on the delivery checking and advice label.

- ▶ Once the roof window has been checked, repackage it in the original packaging for safe storage until the roof window is to be installed.

TRANSPORT & STORAGE

- ▶ Keep the roof window in its original packaging and store off the ground in a secure covered dry place until it is required for installation.
- ▶ When transporting the roof window in its box, carry the box by lifting it from the underside rather than lifting by its strapping.

⚠ Only carry the box if the banding is attached in its original condition. Do not carry by the box if the nylon banding has been cut or appears in any way damaged.

- ▶ Stack multiple units carefully and only as many units high as is set out on the transport information label on the box.
- ▶ Only remove the roof window from its packaging when it is required for installation.
- ▶ Once unpacked carry the roof window by lifting it from the underside of the baseplate.
- ▶ Mark the original box with the window number/location and keep all accessories and linings in the original box until they are required. When the installation is complete and all accessories/linings are used, recycle all of the packaging materials.

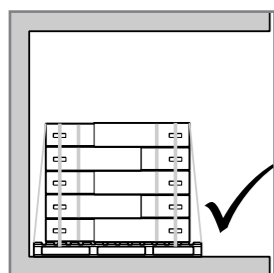

store in a covered dry secure area

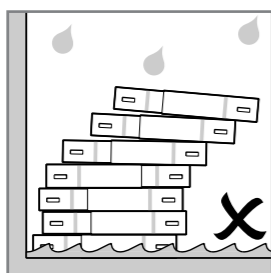

do not stack too high or allow to get wet

SECTION 4 - Prepare the structural opening

> Type of roof

Before you can derive the structural framing dimensions you will need to understand which of the following options apply to your project:

ON THE RAFTER OR BETWEEN THE RAFTER

The type of tiles used affects how the roof window is installed. One of the following options will be used:

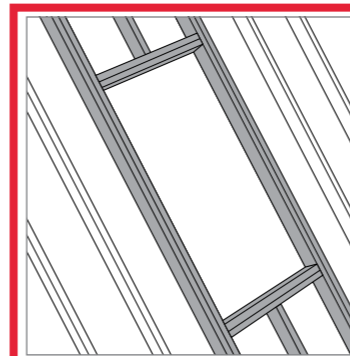

On the Rafter (Standard Installation):

This installation (as the name suggests) installs the roof window with it sitting on top of the rafters. For the majority of profiled tiles (Clay, Pantile etc) the roof window remains flush to the top of the tiles and will not project above the finished roof line. For thinner tile types (Slate) the roof window will not be flush and will project above the finished roof line. If a flush detail is required for thin tile types then a 'between the rafter' (commonly referred to as Flush Slate) installation is required.



Between the rafter (Flush Slate Installation):

When tile types are thinner and a standard 'on the rafter' installation would result in a non-flush installation; a 'between the rafter' installation can be used. The roof window is sunk in between the rafters to a depth equal to the height that it would protrude above the finished roof line if a standard installation was used, nominally to a sunk depth of 20mm (Installers are advised to check this dimension prior to installation). Due to the roof window being sunk below the top of the rafters, the associated structural framing sizes increase. Likewise, dependent upon the pitch of the roof, the run-off required at the cill tilting fillet may vary. Nominally quoted framing sizes use the lowest installation pitch and calculate for worst case scenario.

WARM OR COLD ROOF CONSTRUCTION TYPE

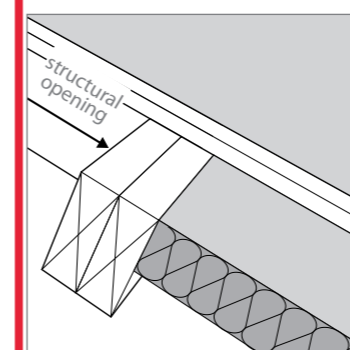

Cold roof

In a cold roof construction, the insulation layer is placed horizontally, directly above the ceiling of the upper story of the habitable section of the building, usually positioned between the joists in the loft space.

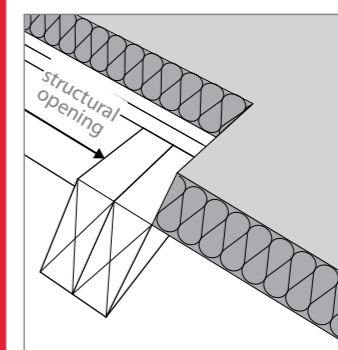

Warm roof

In a warm roof construction, the insulation is positioned directly under the external waterproofing (e.g. tiles or slates), following the rafter line.

INSTALLATION HEIGHT

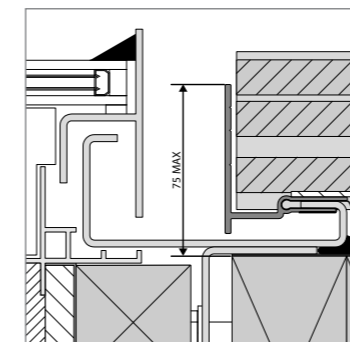

The maximum height that can be used with the flashing kit is 75mm for all tile types. This is measured from the top of the soaker extrusion (part 6) to the top of the structural support (as shown). If your tiles are thicker than this then we recommend the use of lead soakers or mortar bed at the jambs.



NOTE: The flashing kit is only suitable for 'on the rafter' installation.

SECTION 4- Prepare the structural opening

> Type of installation

TYPE OF INSTALLATION

To derive the structural framing dimensions for the Conservation Rooflight®. You will need to have the following information to hand:

- ▶ The Conservation Rooflight® model reference number to be installed.
- ▶ The type of roof construction to be used e.g. cold or warm.

Follow the appropriate information pathway to derive the structural framing dimensions below.

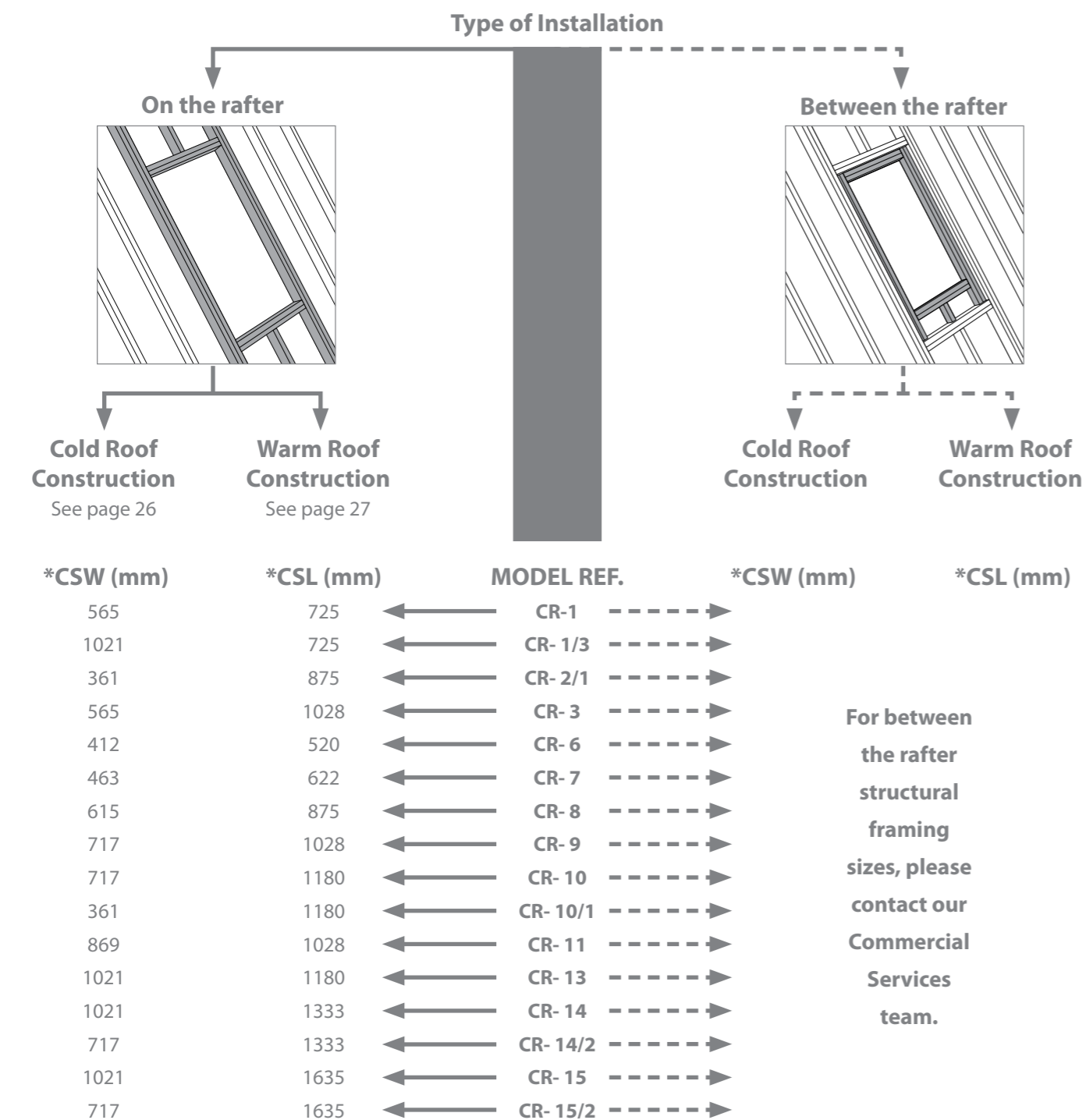

* CSW = Clear Structural Width,
CSL = Clear Structural Length
(for 'on the rafter' installation only)

SECTION 5 - Preparing the roof

> Forming the structural opening

FORMING THE STRUCTURAL OPENING

The opening is formed using additional structural members which re-route the structural loads from the roof above, around the structural opening.



NOTE: All structural member sizing and fixings around the structural opening are to be as detailed by the project architect/structural engineer. Our drawings are indicative only.

The Conservation Rooflight® - in a new roof

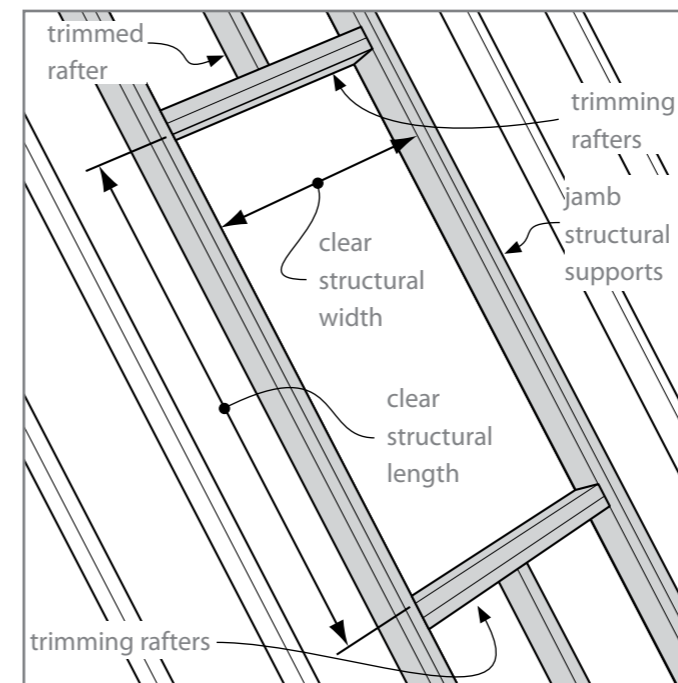

In a new roof the structural members can be designed to reduce the necessity for cutting and trimming.

NOTE: The rafters and trimmers are doubled up in the image

The Conservation Rooflight® - in an existing roof

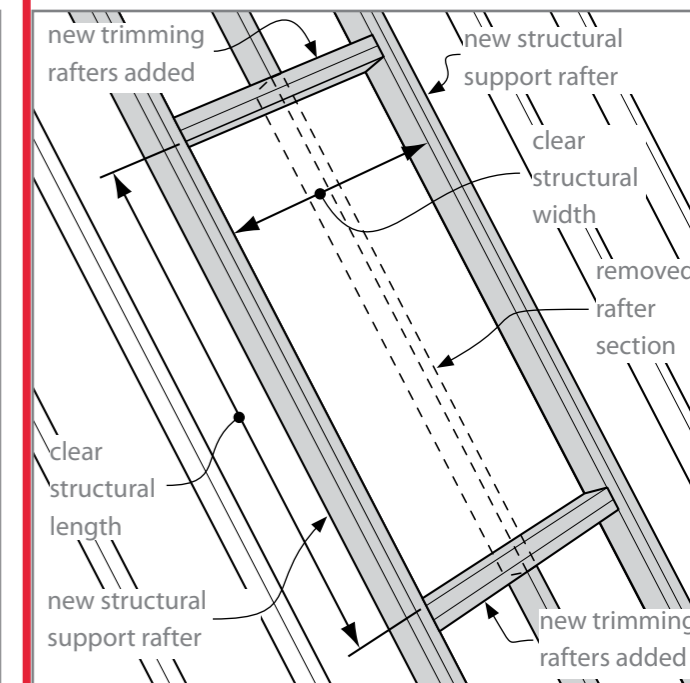

In an existing roof the structural opening may require additional structural members to be inserted and/or existing members cut and re-supported in order to facilitate installation in the location required.

NOTE: The rafters and trimmers are doubled up in the image

Maximum installed height from top of soaker extrusion to top of structural support is 75mm for ALL tile types.

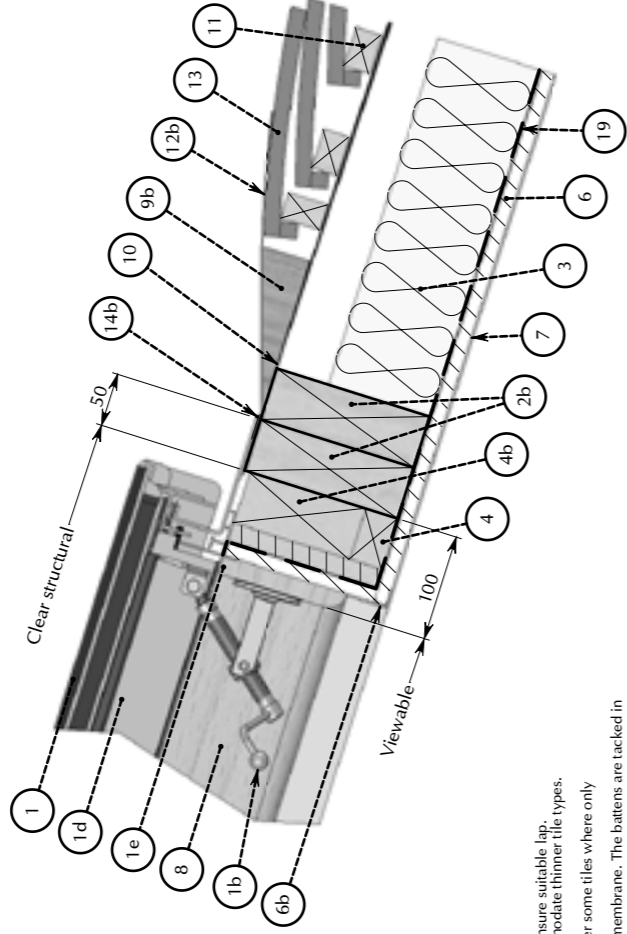
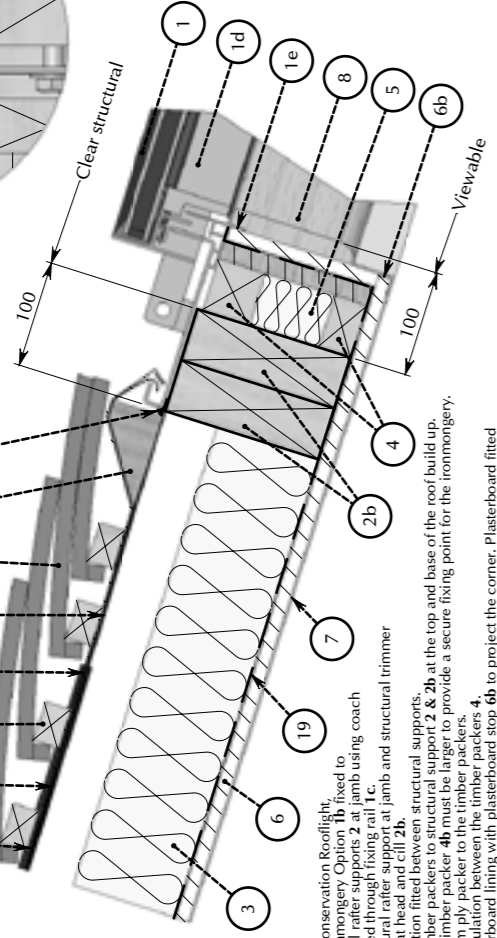
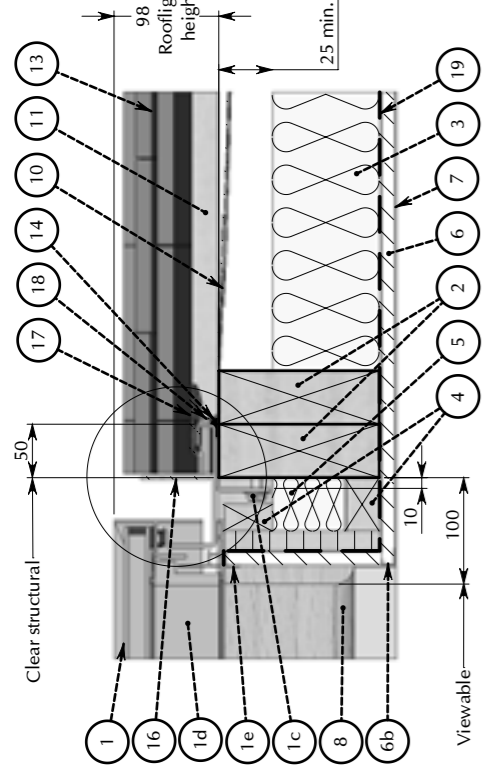
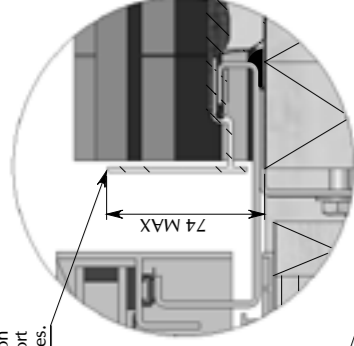
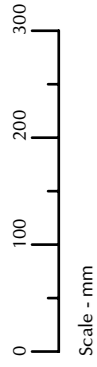

Key:

1. The Conservation Rooflight, with Ironmongery Option 1b fixed to the roof using coach bolts fitted through fixing rail 1c.
2. Structural rafter support at jamb and structural trimmer support at head and cill 2b.
3. Insulation fitted between structural supports.
4. Fix timber packers to structural support 2 & 2b at the top and base of the roof build up.
5. Fix 16mm ply packer to the timber packers.
6. Plasterboard fitted behind the jamb top 6b to project the corner. Plasterboard fitted behind the thermoliner of the rooflight 1e.
7. Plaster skim
8. Timber reveal to align with rooflight linings 1d to provide 'frameless' internal appearance. Rooflight linings 1d MUST BE PAINTED with a timber finishing paint once the rooflight is installed to ensure longevity of this component.
9. Head hardwood tiling fillet.
- 9b. Cill hardwood tiling fillet - to provide minimum 5 degree fall for shedding rain water.
10. Softwood battens.
11. Softwood rafters.
12. Code 3 (consider using code 4 and clipping down roof tiles in severer exposures) lead flashing at head.
- 12b. Code 4 (consider clipping flashing and roof tiles down in severer exposures) lead flashing at cill over tiling fillet 9b.
13. Roofing tiles.
14. Perimeter silicone seal. Seal perimeter of rooflight 1 JUST PRIOR TO installation of the rooflight using a thick continuous bead of polyurethane neutral cure silicone sealant. Ensure sealant to cill 14b is located in a position where it will be covered by the cill flange of the rooflight.
15. Jamb flashing assembly - upVC soaker up stand. Maximum installed height from top of soaker to top of structural support is 75mm. Trim soaker to accommodate thinner tile types. Refer to the flashing kit installation guide for more information.
17. Jamb weathering foam which is bent over and compressed under tiles as they are fixed down. Additional fixing holes or a mortar bed may be required under some tiles where only one batten fixing is possible.
18. Jamb flashing aprons, part of the jamb flashing assembly (supplied as part of the Flashing Kit). They pass UNDER the battens but OVER the general roofing membrane. The battens are tacked in position at the rooflight jamb only until the Flashing Kit is installed and the jamb aprons are slid under them. Then they are fixed home.
19. Vapour barrier (Blue).

Please Note:

These sectional details are provided as an installation suggestion. Due to the differing nature of installations we strongly advise you to consult your rooflight installer to verify fitness for purpose. This drawing does not constitute a structural proposal. Sufficiency of structural supports to be checked by rooflight purchaser's structural consultant.

TITLE: The Conservation Rooflight®

- > A roof window range suitable for pitched roofs between 17.5° and 65°
 - > Detail applicable ONLY to rooflight models with integral casement timber linings
- Cold Roof | Clay Tile | Flashing Kit**
'On the rafter' installation detail

DWG NO.: CR_CRCS_FK_C
 SCALE: 1:5 @ A3
 DO NOT SCALE

SHEET NO.: 1 OF 1
 DATE: 08/08/2013

REVISION: C

9mm WBP ply spacer removed to insert plaster-board behind thermoliner
 DB: EH
 CB: PD

the Rooflight Company
 The Professionals' Choice
 www.therooflightcompany.co.uk
 t: 01993 3333108
 e: info@therooflightcompany.co.uk



All information contained in this drawing is the copyright © and design right of the Rooflight Company. The intellectual property rights of the company are reserved in this drawing and any 3D models are embedded 3D models are owned by the Rooflight Company.