

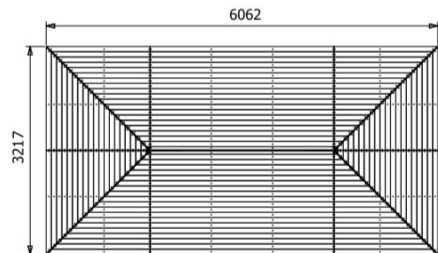

Atlas Chunky Open Gazebo

W6m x D3m

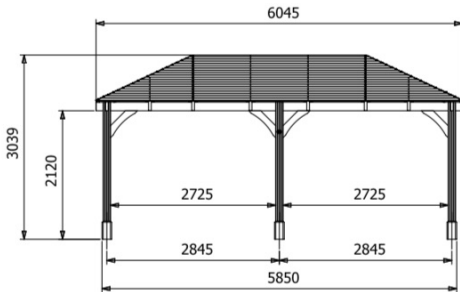
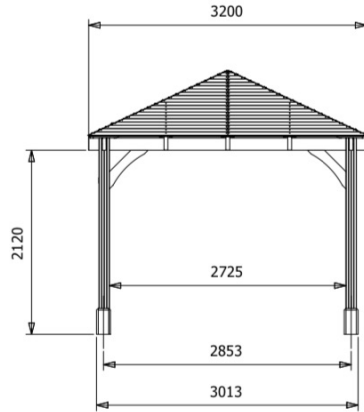

Specification

- Overall External Dimensions: 6.02m x 3.21m (19' 10.75" x 10' 6.75")
 - External Width: 6.04m (19' 10")
 - External Depth: 3.2m (10' 6")
 - Internal Width (Post): 5.57m (18' 3.25")
 - Internal Depth (Post): 2.72m (9' 11.25")
 - Ridge Height: 3.03m (9' 11.5")
 - Eaves Height: 2.12m (6' 2")
 - Internal Lower Post Trim Width: 5.53m (18' 1.75")
 - Internal Lower Post Trim Depth: 2.68m (8' 9.75")
 - External Lower Post Trim Width: 5.85m (9' 10.25")
 - External Lower Post Trim Depth: 3.00m (13' 2.25")
 - Timber: Spruce
 - Uprights: 120mm x 120mm
 - Roof: 15mm Shiplap Boards
 - Roof Covering Options: None, Felt or Shingles
 - Guarantee: 10 Years on Pressure Treated Timber against Rot and Insect Infestation
 - Please Note: All fixings needed for assembly are supplied
 - Approx. Assembly Time: 1 Day*
- *This is an approximate time only, based on 2 people. Assembly time may vary depending on season/weather conditions, foundation type, ability of those constructing, etc