

Broadway Road, Toddington

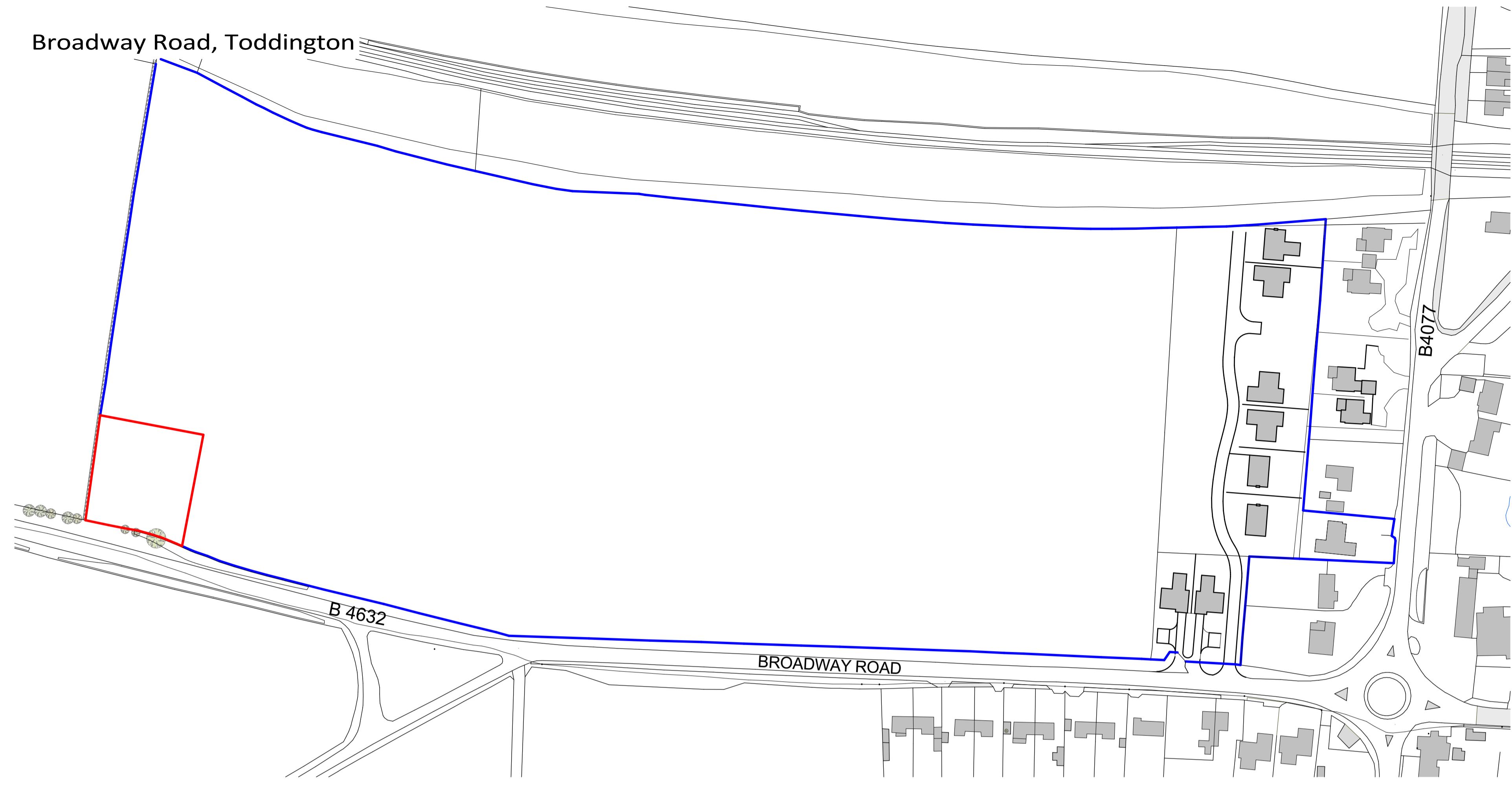

site location plan 1:1250 @ A1

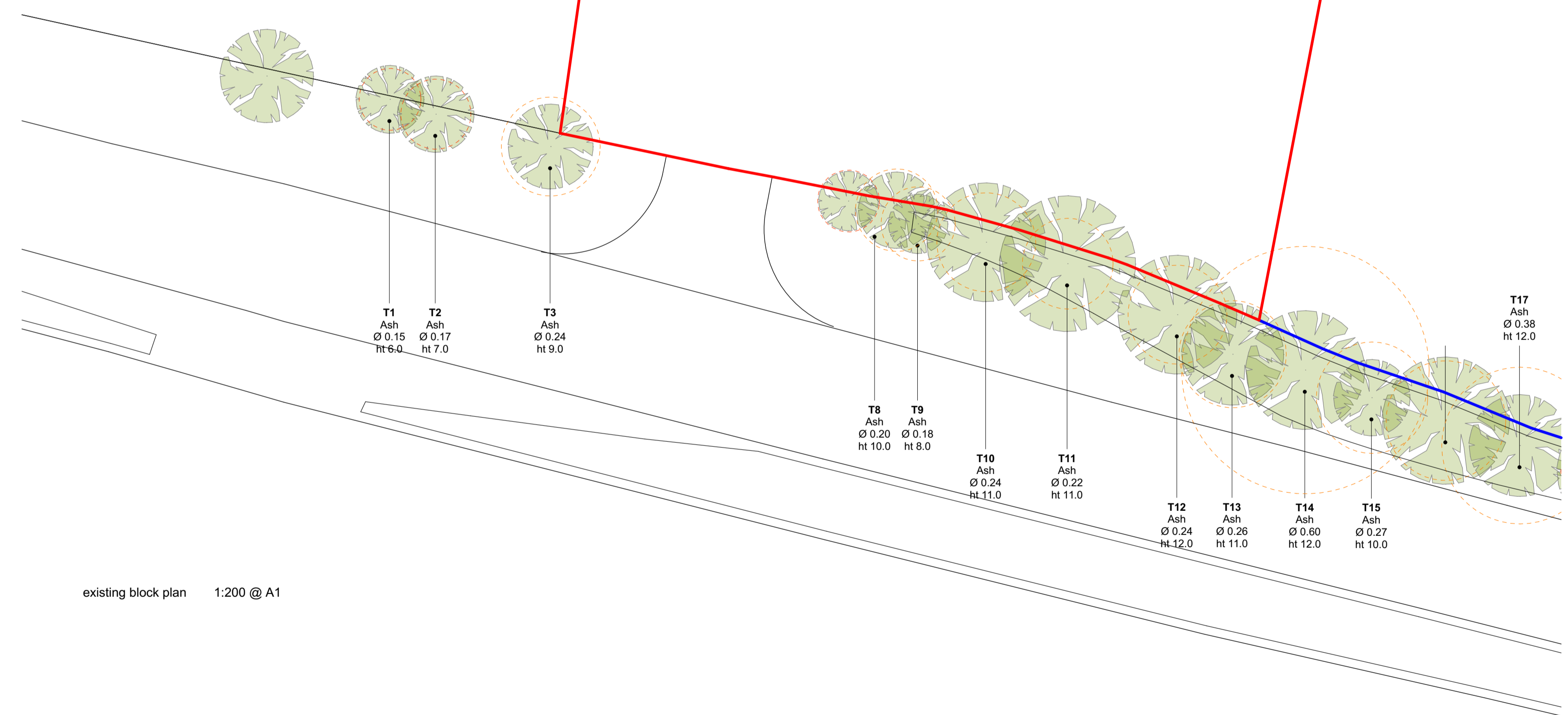

existing block plan 1:200 @ A1



coombes : everitt architects limited
 105 - 107 Bath Road
 Cheltenham
 Gloucestershire
 GL53 7LE

t: 01242 807727 f: 0845 5575833
 e: info@ce-architects.co.uk
 www.ce-architects.co.uk

- Preliminary
- Feasibility
- Planning
- Building Regulations
- Tender
- Construction issue
- As Built

1. This drawing and content is copyright © of coombes : everitt architects limited
 2. Do not scale drawing: all dimensions to be checked on site prior to construction and any discrepancies reported to contract administrator

RIBA
 Chartered Practice

Drawing title: Site Location Plan & Block Plan

Client: Will Holmes

Drawn by: JB Checked: TC

Job number: 16.30.003

Project: Broadway Road, Toddington

Scale: 1:1250 @ A1

Date: January 2019

Draw no: PL500 B