

Ref: Admin/CL/266\_01/LA.01

22<sup>nd</sup> May 2023

---

**CHEVIN VIEW, CLIFTON LANE, CLIFTON LS21 2HE**

Proposed single storey rear extension

**CLD APPLICATION – SUPPORTING STATEMENT**

---

**Proposals**

The certificate of lawful development application to which this statement relates looks to create a single storey rear extension to an existing dwelling.

The proposed site is located within a conservation area, Green Belt and an AONB.

This document looks to show how the proposals meet with the relevant policy 'Permitted development rights for householders: General Permitted development Order 2015' and is to be read alongside the proposed plans submitted by Wighton Architects.

With regards to the above technical guidance the below states how it complies.

- The proposed extension is to the rear and extends no further than 3m from the rear of the existing dwelling
- The proposals comply with all requirements for a Class A permitted development. Refer to drawings.

**Context**



Image 1 – Existing original extension (side)



Image 2 – Existing original extension (rear)

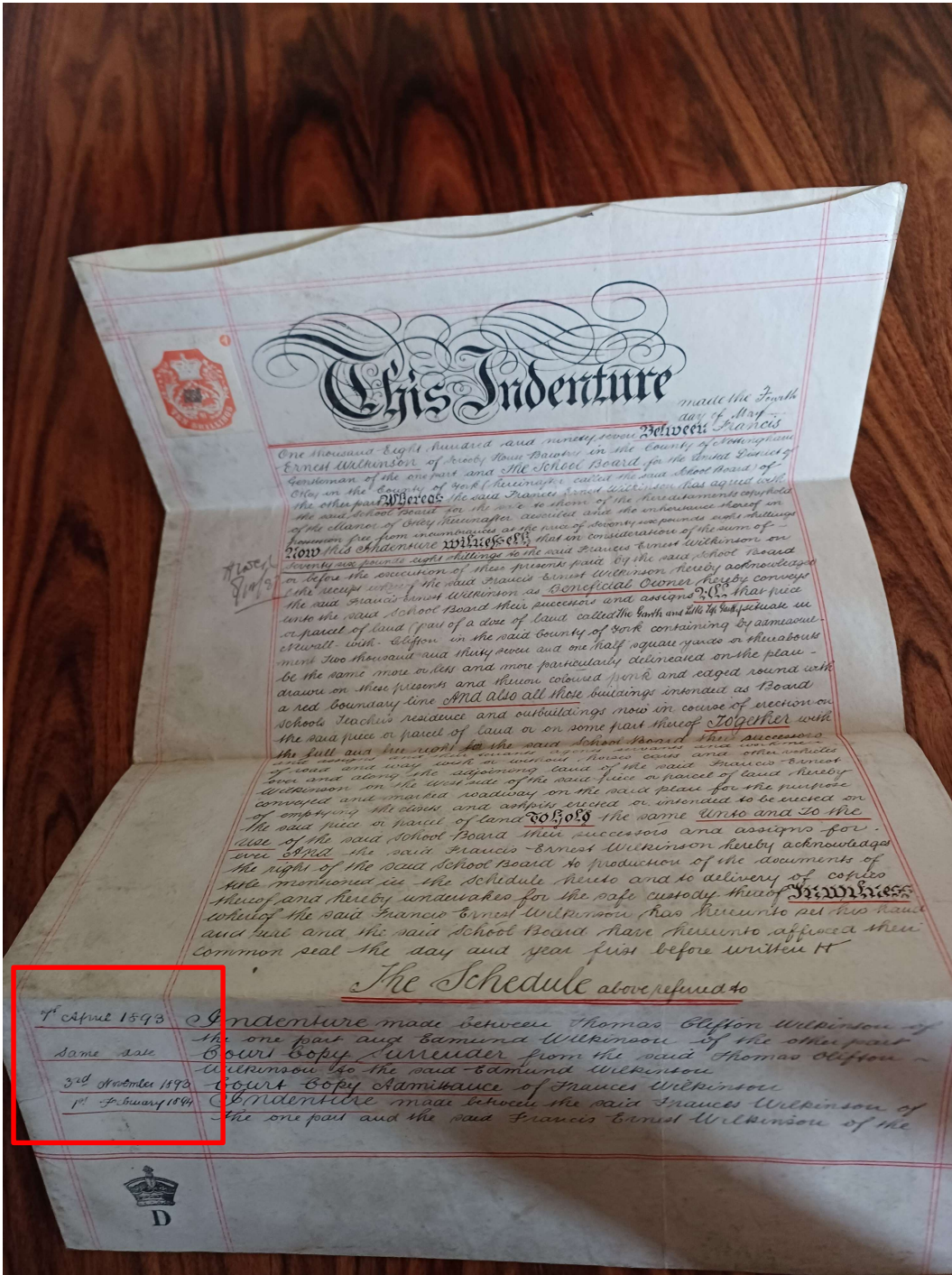

Image 3 – Original Deeds confirming date as 1893

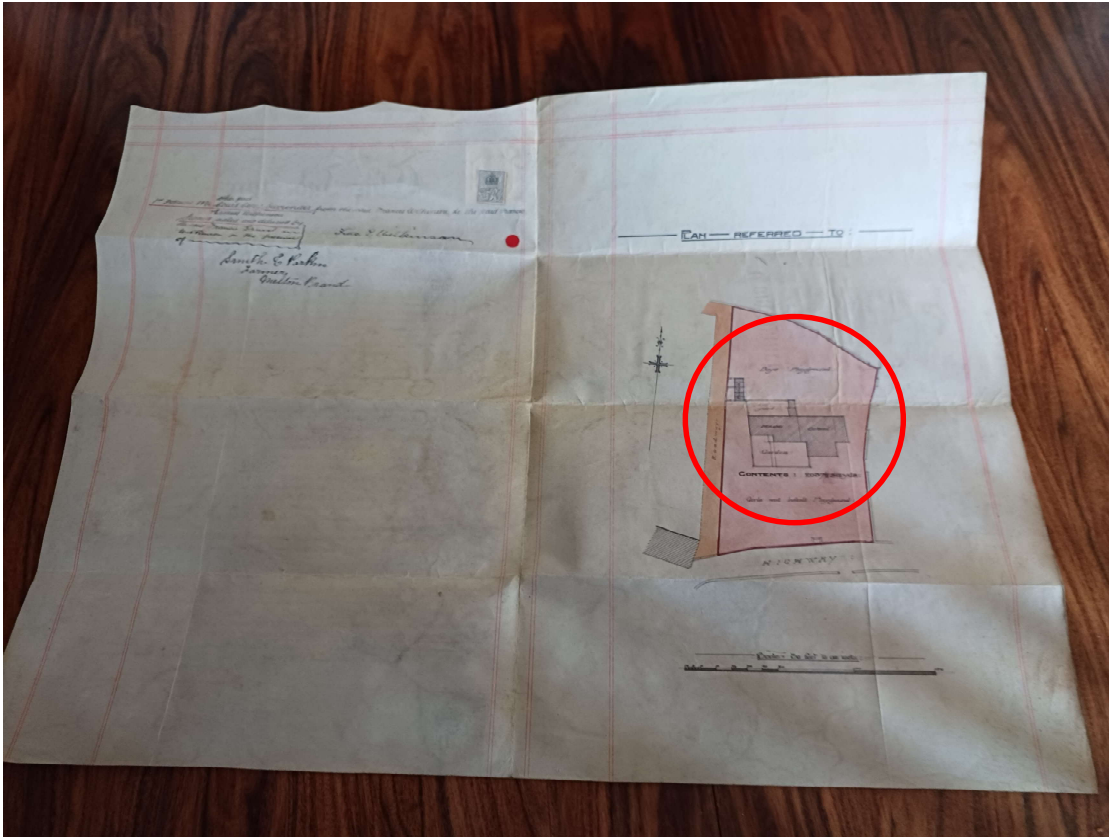

Image 4 – Original Deeds confirming extent of built form to rear