

KEY

- MH Manhole Inspection Cover
- IC Inspection Cover
- IC(E) Inspection Cover (Electricity)
- IC(G) Inspection Cover (Gas)
- IC(W) Inspection Cover (Water)
- BT Road Gully
- RG Road Name Sign
- RS Drainage Gully
- DG Down Pipe
- DP Rodding Eye
- RE Lamp Post
- LP Telegraph Pole
- TP Services Pole
- SP Bus Stop
- BS Telephone Call Box
- TCB Water Valve
- WV Stopcock
- SC Gas Valves
- GV Traffic Control Signal Unit
- TCSU
- B Bollard
- IB Illuminated Bollard
- P Post
- IS Illuminated Sign
- + 25.00 Spot Levels
- Grid

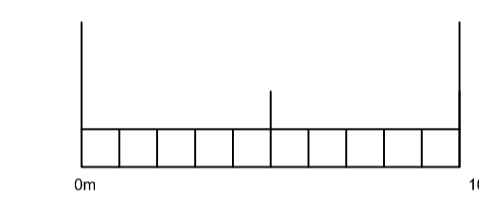

NOTES - Base Data
 Grid Marks are at 20m intervals
 Stated distances in metres
 Survey based on Ordnance Survey grid (OSTN15) and datum (OSGM15) utilising the OS Active Net

OS digital data as per copyright
 Title information from HMLR

TITLE:
VICTORIA'S
ASHFORD ROAD
HARRIETSHAM
KENT ME17 1BL

RECORD OF SURVEY		
DIGITAL DATA:	DATE:	PLOT SCALE:
2D	AUGUST 2020	1:200
ASSOCIATED DWG:	REVISION DATE:	CONTOUR INTERVAL:
	APRIL 2021	0.5m

CLIENT:
 Heritage Designer Homes

SURVEYED BY:
MULTI-LIMN
 M.L.N. BEACH CHARTERED LAND SURVEYOR
 THE OLD EXCHANGE
 THE STREET
 SELLING
 NR FAVERSHAM
 KENT ME13 9RQ
 EMAIL: multilimn@aol.com

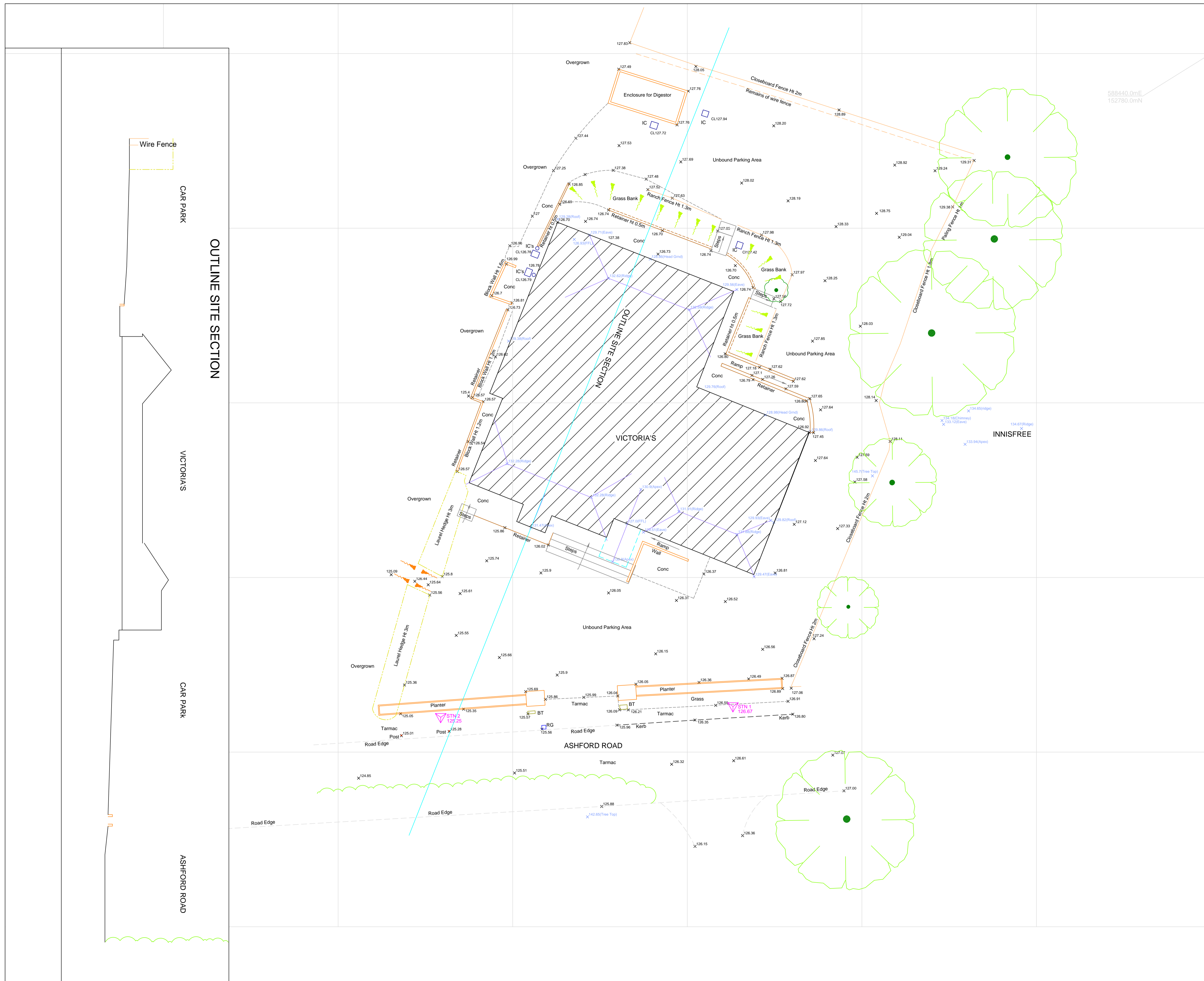

OUTLINE SITE SECTION

CAR PARK

VICTORIAs

CAR PARK

ASHFORD ROAD