

CONTRACT: UNDERDEAN HOUSE, NEWNHAM ROAD, BLAKENEY

CONTRACT REF: 13644

SKETCH No. SK-02 REV.

P 1

DATE: APRIL '23

DRAWN BY: WB

CHECKED BY: DAW

DESCRIPTION: ROOF STRUCTURE STRENGTHENING REQUIREMENTS (SHEET 2 OF 2)

8mm THICK STEEL SHOE PLACED EACH SIDE OF PRINCIPAL RAFTER WITH 4no. M12 BOLTS THROUGH. PROVIDE SUITABLE TIMBER PACKING BETWEEN PURLIN AND SHOE.

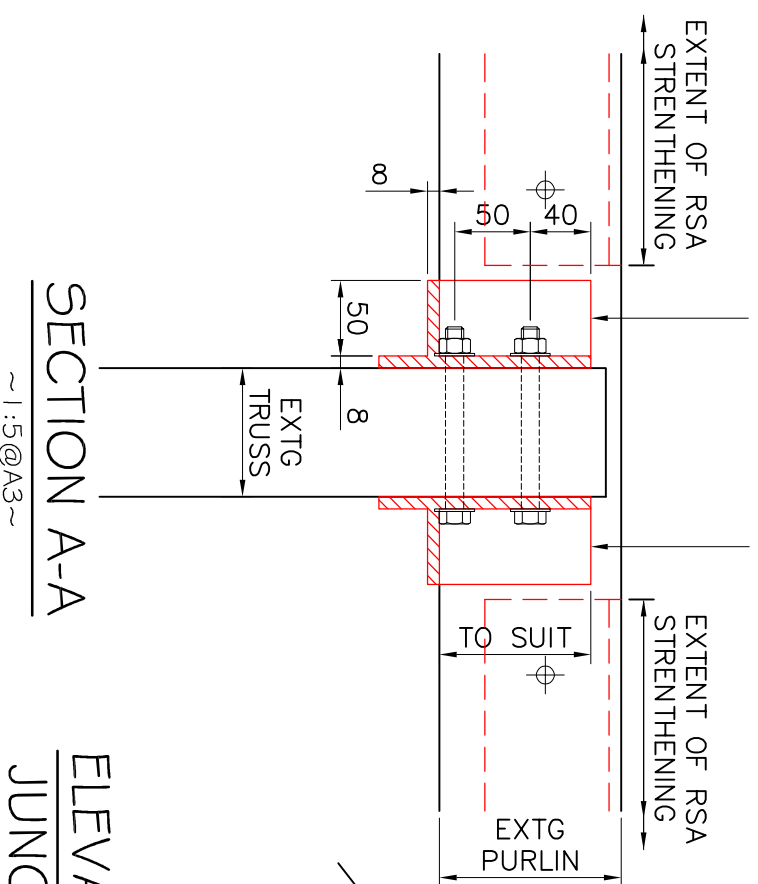

SECTION A-A
~1:5@A3~

ELEVATION ON STRENGTHENING DETAIL AT JUNCTION BETWEEN PURLINS AND TRUSS
~1:5@A3~

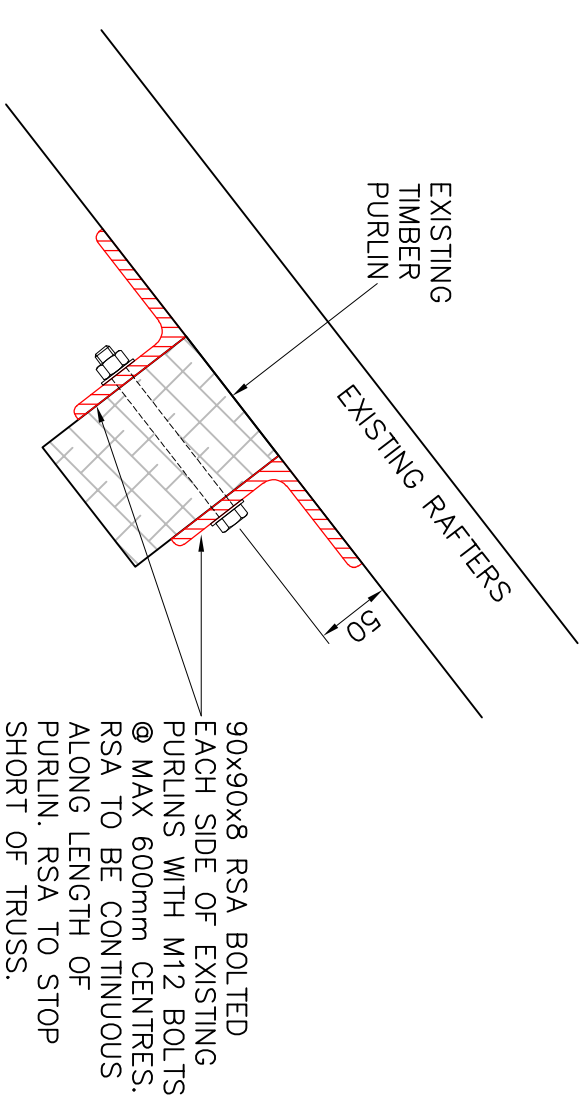
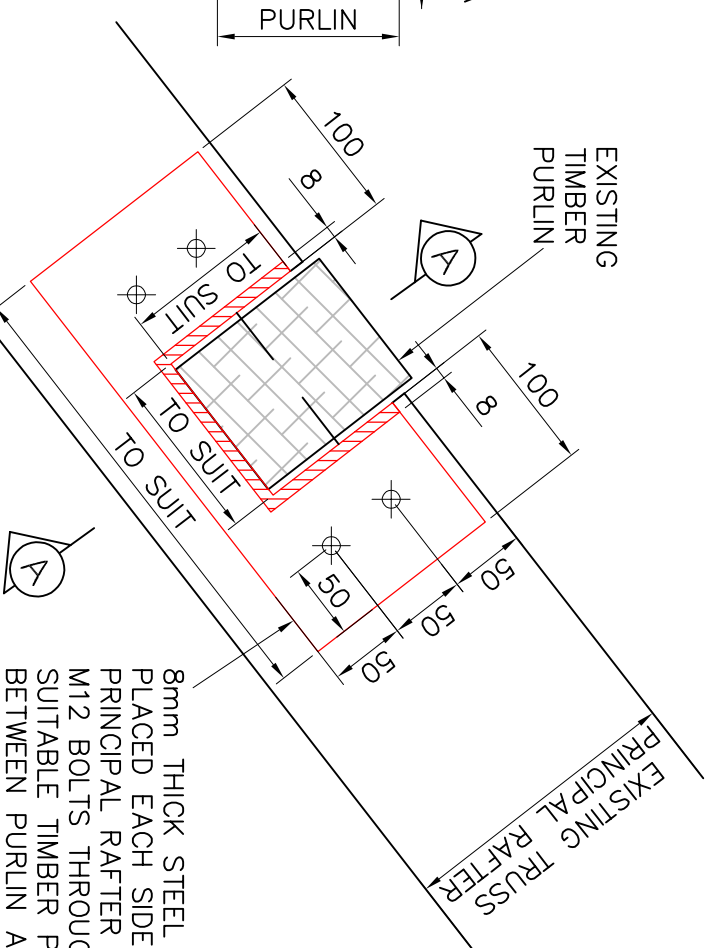

SECTION THROUGH TYPICAL STRENGTHENING TO PURLINS
~1:5@A3~

NOTES

GENERAL

1. THIS DRAWING TO BE READ IN CONJUNCTION WITH ALL RELEVANT ENGINEERS, ARCHITECTS AND SERVICES DRAWINGS.
2. ALL DIMENSIONS ARE IN MILLIMETRES U.N.O.
3. THE CONTRACTOR SHALL BE RESPONSIBLE FOR ENSURING THAT ADEQUATE TEMPORARY SUPPORT IS PROVIDED, AS REQUIRED, DURING THE WORKS.
4. ALL PROPRIETARY PRODUCTS TO BE INSTALLED IN ACCORDANCE WITH THE MANUFACTURERS SPECIFICATIONS.
5. CONTRACTOR SHALL BE RESPONSIBLE FOR TAKING ALL NECESSARY ACCURATE MEASUREMENTS ON SITE TO ESTABLISH REQUIRED BEAM LENGTHS ETC. PRIOR TO FABRICATION / CONSTRUCTION.

NOTE: THIS DRAWING IS TO BE READ IN CONJUNCTION WITH DETAILS ON ROWNTREE SKETCH 13644-SK-01.

CONSTRUCTION NOTES

STEELWORK

1. ALL STEELWORK SECTIONS TO BE MINIMUM GRADE S275 U.N.O.
2. ALL INTERNAL STEELWORK TO BE PAINTED TO SUIT INTERIOR ENVIRONMENT & CORROSION CATEGORY C1 (VERY LOW) TO ISO 12944.
3. FIRE PROTECTION TO STEELWORK TO BE IN ACCORDANCE WITH LOCAL AUTHORITIES REQUIREMENTS AND/OR ARCHITECTS SPECIFICATION.
4. ALL BOLTS TO BE GRADE 4.6 (SIZE AS NOTED) AND ALL WELDS TO BE 6mm CONTINUOUS FILLET WELDS (U.N.O.) TO BS EN 1011-2.
5. STEELWORK EXECUTION CLASS TO BE EXC2 IN ACCORDANCE WITH BS EN 1090-2.

TIMBER

6. ALL TIMBER MEMBERS TO BE SIZE & GRADE AS NOTED ON DRAWING. ALL ROOF TIMBER TO BE PRESSURE TREATED USING PROPRIETARY WOOD PRESERVATIVE.
7. PROVIDE LATERAL RESTRAINT STRAPS @ MAX. 2m CTRS ACROSS MIN. 3no. RAFTERS WITH NOGGINS ALL SECURELY FIXED WITH MIN. 5no. 4mm ϕ x 75 LONG CORROSION RESISTANT NAILS TO THE WALLS TO ROOF.