

General Notes		
1. Responsibility is not accepted for errors made by others in scaling from this drawing. All construction information should be taken from figured dimensions only.		
2. All dimensions to be checked onsite.		
3. Unless otherwise stated dimensions are in millimetres.		
4. Drawings to be read in conjunction with all other project drawings.		
5. Copyright Millar + Howard Workshop Ltd.		
Rev	Date	Notes
Chartered Architects <b>MILLAR + HOWARD</b> WORKSHOP		
St Mary's Mill St Mary's Chalford STROUD Gloucestershire GL8 8NX t: 01453 887186 e: info@mhworshop.co.uk w: www.mhworkshop.co.uk		
Project Title <b>The Stables, Ullenwood</b>		
Project Address <b>The Stables, Greenway Lane, Ullenwood, GL53 9QS</b>		
Job No.		2210
Drawing Title <b>Proposed Ground Floor</b>		
Drawn By	Checked By	Date
RL	TH	Jan 2023
Scale		1:100@A1
Drawn No.	Revision	
<b>P/210</b>		
Drawing Status <b>Planning</b>		

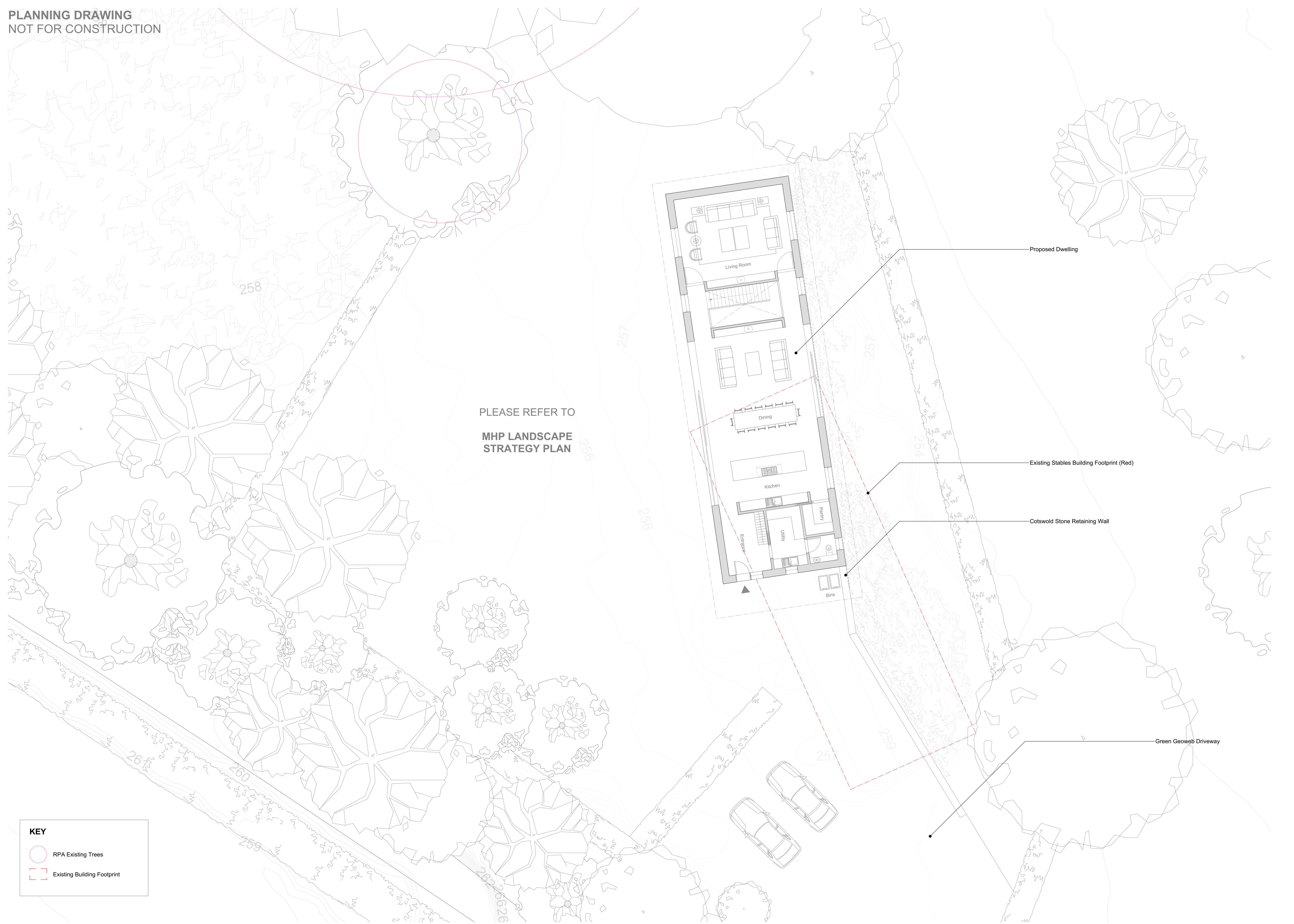

PLEASE REFER TO  
**MHP LANDSCAPE  
STRATEGY PLAN**

Proposed Dwelling

Existing Stables Building Footprint (Red)

Cotswold Stone Retaining Wall

Green Geoweb Driveway

**KEY**

- RPA Existing Trees
- Existing Building Footprint